

DEPOSIT OF STATEMENT AND MAP

SECTION 31 (6) OF THE HIGHWAYS ACT 1980

To Surrey County Council

1. I am and have been since 27th March 1983 for the greater part and 26th February 2003 for the remainder the owner (together with Andrew Henry Warde Dixon, as Trustees) within the meaning of the above section of the land known as Oxenford Grange and Oxenford Farm, Milford Road, Elstead, Godalming, Surrey and Amberley Farm, Milford, Godalming, Surrey, more particularly delineated on the map accompanying this statement and thereon edged red.
2. The aforementioned land lies in the Parishes/Communities of Milford.
3. The ways coloured green on the said map have been dedicated as bridleways.
4. The ways coloured purple on the said map have been dedicated as footpaths.
5. No other ways over the land have been dedicated as highways.
6. The deposit shall comprise this statement and accompanying map.

Signed

[Redacted Signature]

Name

Colin Frederick Baker

Address

Chesil Cottage
Mousehill Lane
Milford
Surrey GU8 5BH

Date

15th March 2010

Signed (witness)

[Redacted Witness Signature]

Name (of witness)

BURKE WARDMAN

Address

14 NORM ROAD
MILFORD, SURREY GU22 2AX

Occupation

book

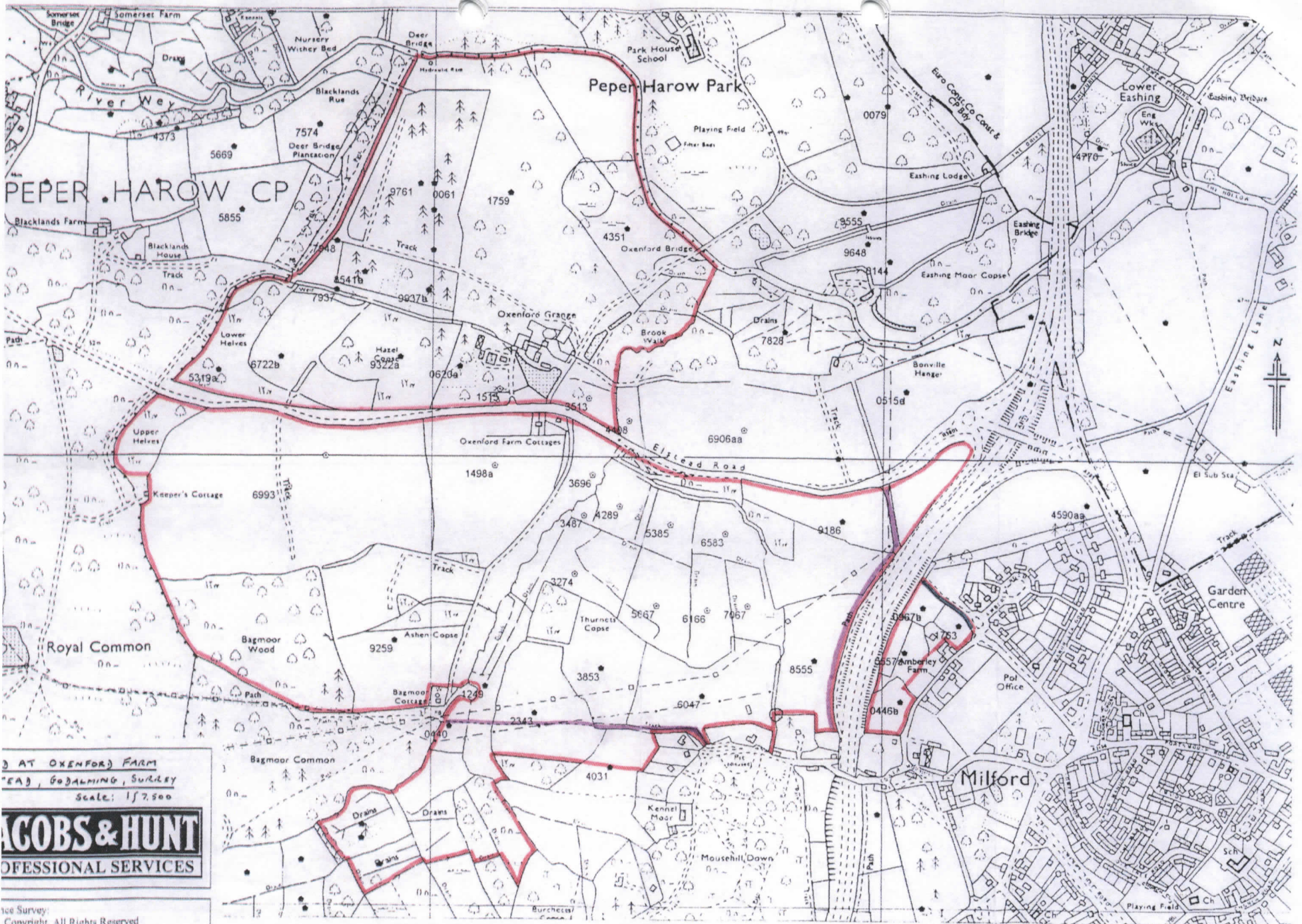

AT OXENFORD FARM
 PEPER HAROW, GODALMING, SURREY
 Scale: 1:7,500

ACOBS & HUNT
 PROFESSIONAL SERVICES

See Survey:
 Copyright. All Rights Reserved
 e No 100004195