

STATUTORY DECLARATION

of

**NORMAN CASSIENET EVANS**

Barlows  
30 Church Street  
Godalming  
Surrey  
GU7 1EP

I NORMAN CASSIENET EVANS of Tree Tops Seale Lane  
Puttenham Near Guildford Surrey do solemnly and sincerely  
declare as follows:-

1. On the 14th day of August One thousand nine hundred and  
eighty-seven I deposited a map of my land at Tree Tops Seale  
Lane Puttenham Near Guildford Surrey with Surrey County  
Council together with a statement denying that any of the ways  
over that land had been dedicated to the public \_\_\_\_\_
2. Since such deposit and statement no ways have been dedicated  
by me for the use of the public as highways on the plan now  
produced and shown to me and marked 'NCE 1' \_\_\_\_\_

AND I make this solemn declaration conscientiously believing the  
same to be true and by virtue of the Statutory Declarations Act  
1835 \_\_\_\_\_

DECLARED by the above-named )  
NORMAN CASSIENET EVANS )  
at *South Street Godalming* )  
in the County of *Surrey* )  
the *27th* day of *August* 1993)

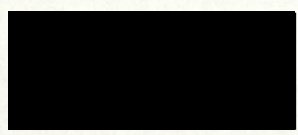

Before me,



Solicitor/~~Commisioner~~ for Oaths

---

This is the exhibit marked 'NCE 1'  
referred to in the Statutory Declaration of  
**NORMAN CASSIENET EVANS**

 declared  
Sworn before me on the 27th  
day of August 1993

---

  
SOLICITOR.

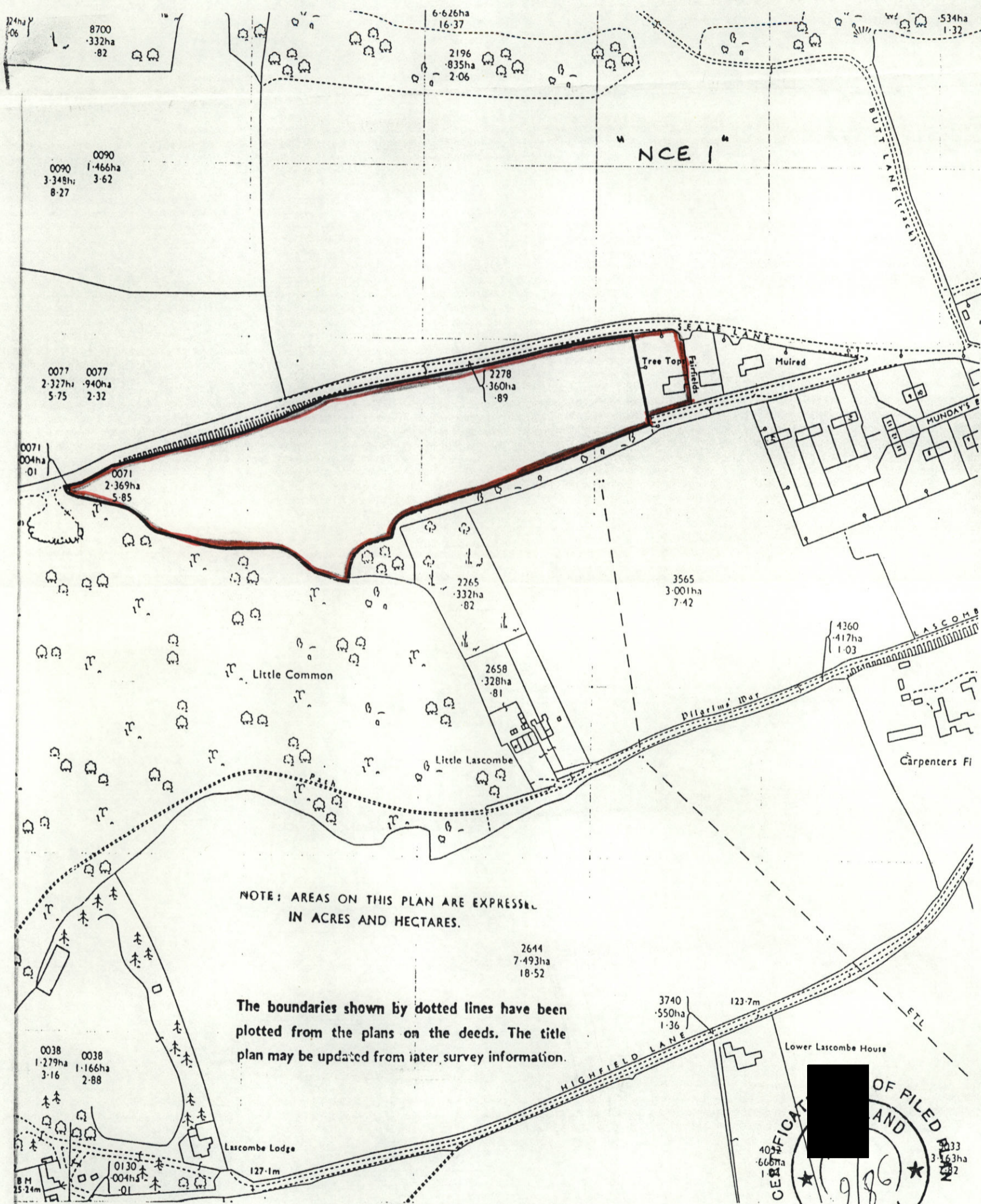

H.M. LAND REGISTRY

TITLE NUMBER

**SY 560060**

ADVANCE SURVEY  
PLAN REFERENCE

SU 9147-9247

Scale  
1/2500

COUNTY SURREY

DISTRICT GUILDFORD

© Crown copyright

