

DEPOSIT OF STATEMENT and PLAN
SECTION 31(6) OF THE HIGHWAYS ACT 1980

To Surrey County Council:

- 1 The applicant is and has been since May 1950 the owner within the meaning of the above section of the land known as Land adjoining Moor Park Lane, Farnham more particularly delineated on the plan accompanying this statement and thereon edged red.
- 2 The aforementioned land lies in the Parish/Community of Farnham.
- 3 In accordance with the provisions of Section 31 of the Highways Act 1980, the applicant declares that there are no public rights of way of any sort over the aforesaid land nor does it recognise any other such public right of way whatsoever.
- 4 The deposit shall comprise this statement and accompanying plan.

Signed on behalf the landowner ..

[REDACTED]

Name of signatory

..... J V CRESSWELL

Status of signatory

..... AREA DELIVERY MANAGER - EPM

Name of landowner

Surrey County Council

Address

County Hall
Kingston upon Thames
KT1 2DN

Date

..... 29 DECEMBER 2011

Signed witness

[REDACTED]

Name of witness

..... SARAH E. WALKER..... ESTATES SURVEYOR

Status of signatory

..... SARAH E. WALKER.....

Address

..... COUNTY HALL.....
..... KINGSTON UPON THAMES.....
..... KT1 2DN.....

Occupation

..... CHARTERED SURVEYOR.....

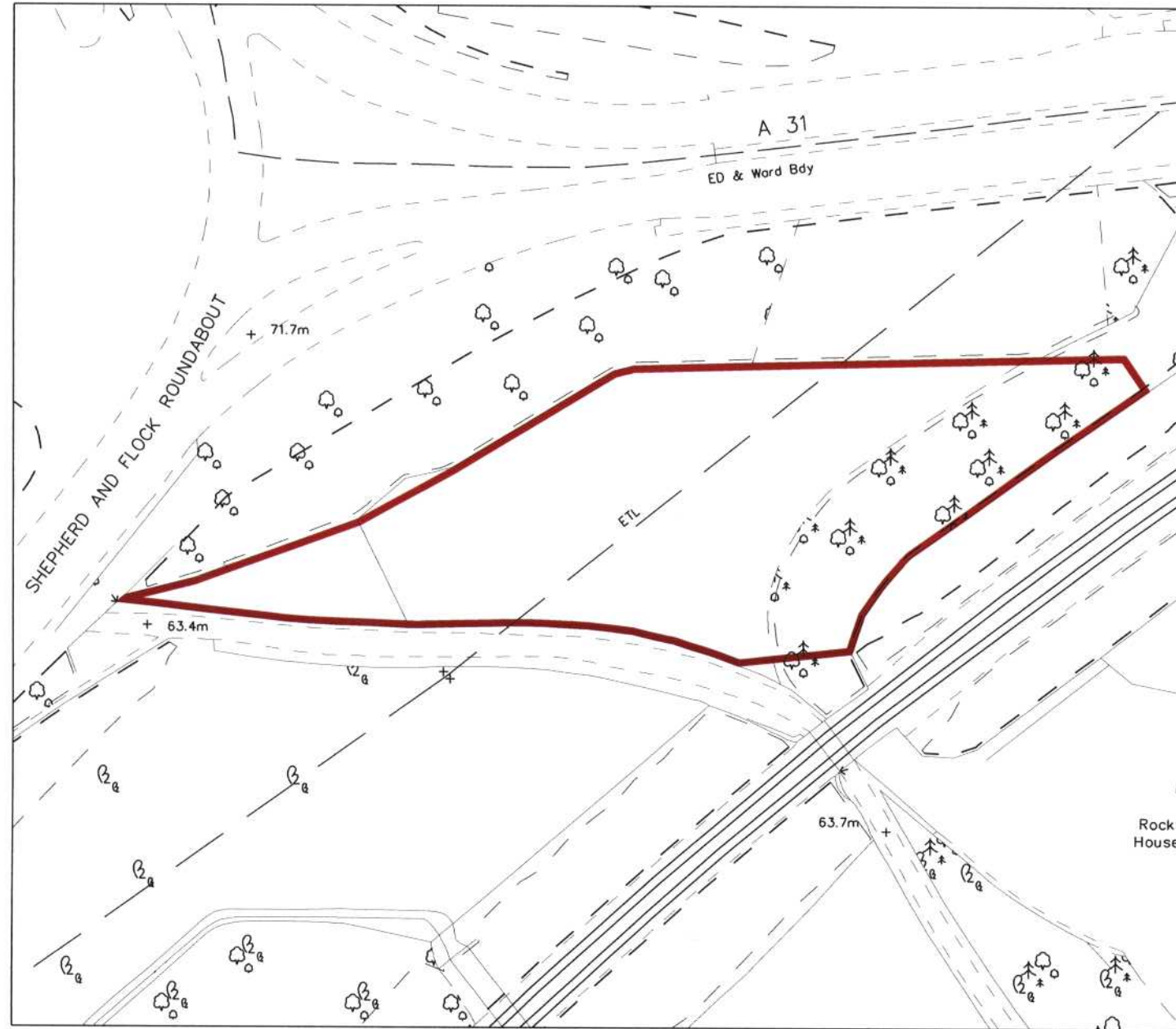

Based upon the Ordnance Survey mapping with the permission of the Controller of H.M.S.O. © Crown copyright. Unauthorised reproduction infringes Crown copyright and may lead to prosecution or civil proceedings. Surrey County Council LA 076872 1996.

Notes

Rev.	Description	Date	By	Chk'd
------	-------------	------	----	-------



SURREY
COUNTY COUNCIL

Estates Planning & Management, County Hall,
Penryhn Road, Kingston upon Thames, Surrey, KT1 2DW.

Tel : 020 8541 7233

O.S. Ref.	SU 8547
-----------	---------

Scale	1:1000 @ A4
-------	-------------

Surveyed by	Drawn by	Checked by
	KBD	
Date	Date 22.11.11	Date

Location
LAND ADJOINING MOOR PARK LANE FARNHAM

T.H.
GRAZING LAND
HIGHWAYS ACT 1980
S.31(6) DECLARATION