

Patrons:

The Lord Barber of Tewkesbury; Dr J. Morton Boyd, C.B.E., F.R.S.E.;
Dame Sylvia Crowe, D.B.E.; Sir James Stormonth Darling, C.B.E., M.C.;
The Right Honourable Lord Denning; P. F. Garthwaite Esq., O.B.E.;
R. Hammond Innes Esq., C.B.E.; The Earl of Lichfield;
Dame Moura Lympny, D.B.E.; E. M. Nicholson Esq., C.B., C.V.O.

Council of Management:

T. H. White, F.R.I.C.S. (Chairman);
C. P. Wright, M.Sc. A.R.I.C.S., A.L.L.; R. H. Trafford M.A.;
T. W. Wright, B.Sc. (For.), Ph.D., D. H. Marks, M.I.P.A.;
A. P. Golding, F.C.A., A.T.I.L.; D. V. Gaultier, C.B.E., M.A., B.L.
M. F. Barton, LL.B., P. J. Oüver F.C.A.



The Woodland Trust
Autumn Park, Dysart Road,
Grantham, Lincolnshire NG31 6LL
Telephone (01476) 581111
Fax: (01476) 590808

The Rights of Way Officer
Surrey County Council
Highways and Transportation Department
County Hall
Kingston upon Thames
Surrey

Our Ref: WH/wh/0665

02 July 1997

Dear Sir

DEPOSIT OF STATEMENT AND PLAN
HIGHWAYS ACT 1980 SECTION 31(6)

We, the Woodland Trust, a company limited by guarantee and registered charity no: 194344, of Autumn Park, Dysart Road, Grantham, Lincolnshire, have been since 12th September 1996 the owner within the meaning of the above section of the land known as Holbeche-Corfield Copse, Kingswood, Surrey, more particularly delineated on the plan accompanying this statement and thereon edged red.

No ways over the land have been dedicated as highways.

At the present time we have no intention of dedicating any public rights of way over our property.

The deposit comprises this statement and the accompanying plan.

Yours faithfully

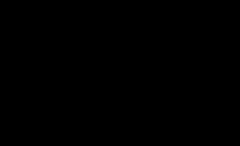

Wendy Higlett
Legal Administrator authorised to sign on behalf of the Woodland Trust

Enc.

HOLBECHE-CORFIELD COPSE

KINGSWOOD PARISH

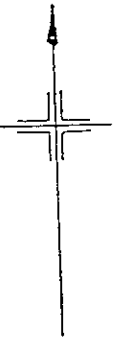

LEAD PARISH

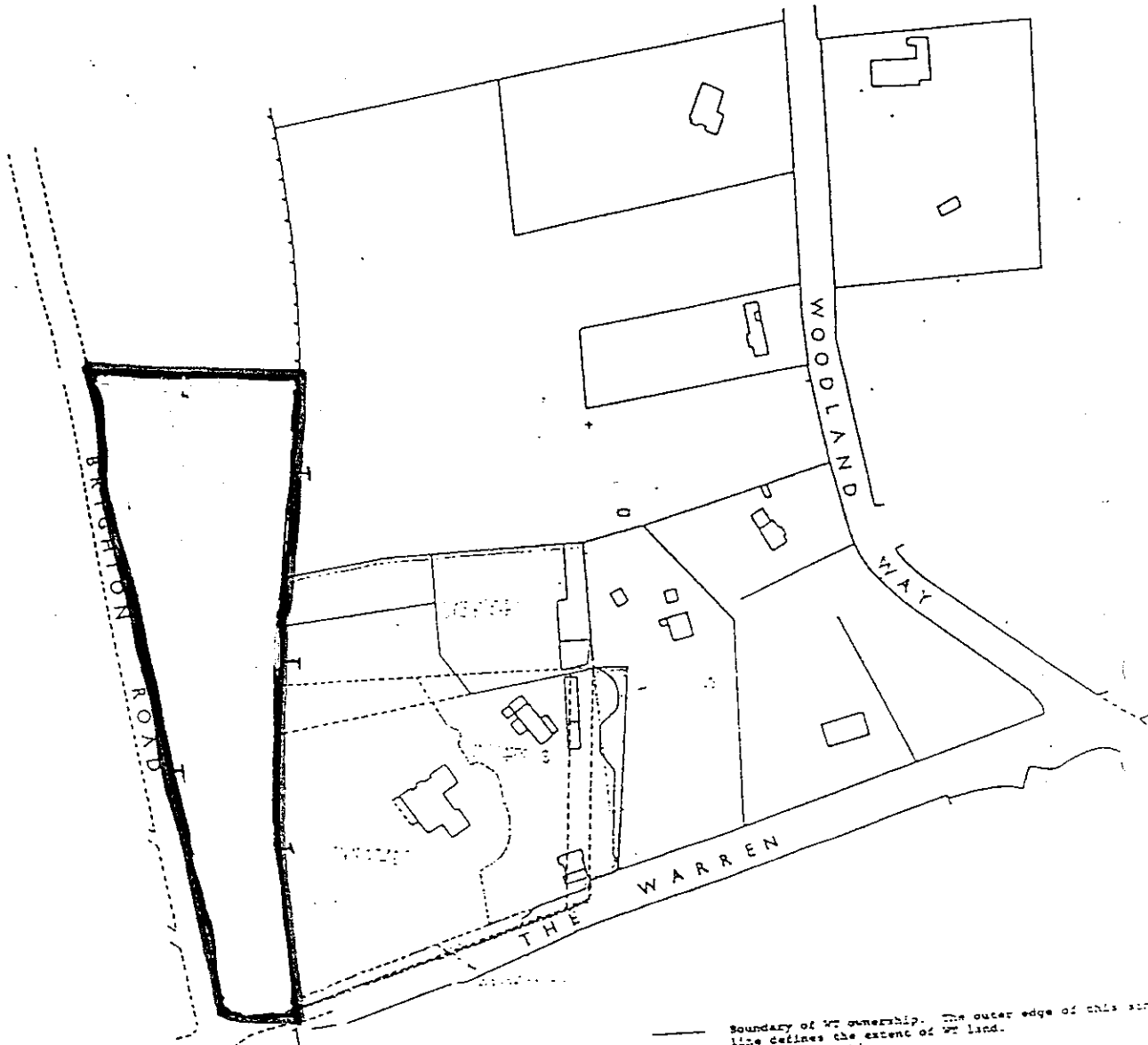

- Boundary of WT ownership. The outer edge of this single line defines the extent of WT land.
- - - - - Boundary ownership
- Public access
- Management access
- Management access routes
- Permissive routes
- Public footpath
- Public bridleway
- Road used as a public path
- Third party right of way
- Overhead lines (P = Power, T = Telephone)
- Underground services (W = Water, G = Gas, S = Sewer, E = Electricity)

- ST 9 Septic tank with outfall
- Zone A (Tree Safety)
- Zone B (Tree Safety)
- Badger sett
- Building structure (SL if listed)
- Pond
- Waterfall
- Can
- Cliff
- Quarry
- Mineshaft
- Adit
- Cave

reproduced from the Ordnance Survey's
 1:2500 (scale) map of
 1962 (year) with the
 permission of the Controller of
 Her Majesty's Stationery Office.
 Crown copyright reserved.
 The Woodland Trust Date 20.6.96.
 Autumn Park Grantham, Lincs NG31 6LL