

ORDNANCE SURVEY PLAN REFERENCE TO 1950
 COUNTY SURREY DISTRICT MOLE VALLEY SECTION G



Clovelly Caravan Park
 Boxhill Road
 Box Hill
 Tadworth
 Surrey
 KT20 7JQ

5th February 1998

Mrs P Birch
 Rights of Way Dept.
 County Hall
 Kingston upon Thames
 Surrey
 KT1 2DY

Dear Mrs Birch,

I refer to our telephone conversation today regarding my land adjacent to the lime kilns at Brockham. I wish to make the following statement regarding a permissive right of way across the northern border of my land. I enclose a copy of my deeds plan marked as suggested.

Statement

I Richard Peter Dakin of Clovelly Caravan Park, Boxhill Road, Tadworth, Surrey KT20 7JQ do solemnly and sincerely declare as follows:

I am the owner of the property / land known as Lime Kilns Cottage (Bungalow), Chalkpit Lane, Brockham, Surrey, RH3 7EZ which is coloured pink on the attached plan marked TQ 1980 5090.

This declaration is made in accordance with the provisions of section 31 of the Highways Act 1980 to state that I have not dedicated, nor shall dedicate any part of the property / land as a public highway, nor as a public right of way of any sort, nor do I recognise any other such public right of way whatsoever.

Upon the said plan there is marked in blue a path for which I have given consent to members of the public to walk over, as a permissive footpath. However, this path is not being dedicated to the public at large to use. I reserve the right to withdraw my consent for members of the public to use this path at any time.

signed [Redacted]

(landowner)

date 5th February 1998

Yours sincerely,

[Redacted Signature]

Mr. R. P. Dakin

ORDNANCE SURVEY PLAN REFERENCE	TQ 1950	SECTION G	Scale 1/1250
COUNTY SURREY		DISTRICT MOLE VALLEY	© Crown Copyright All rights reserved

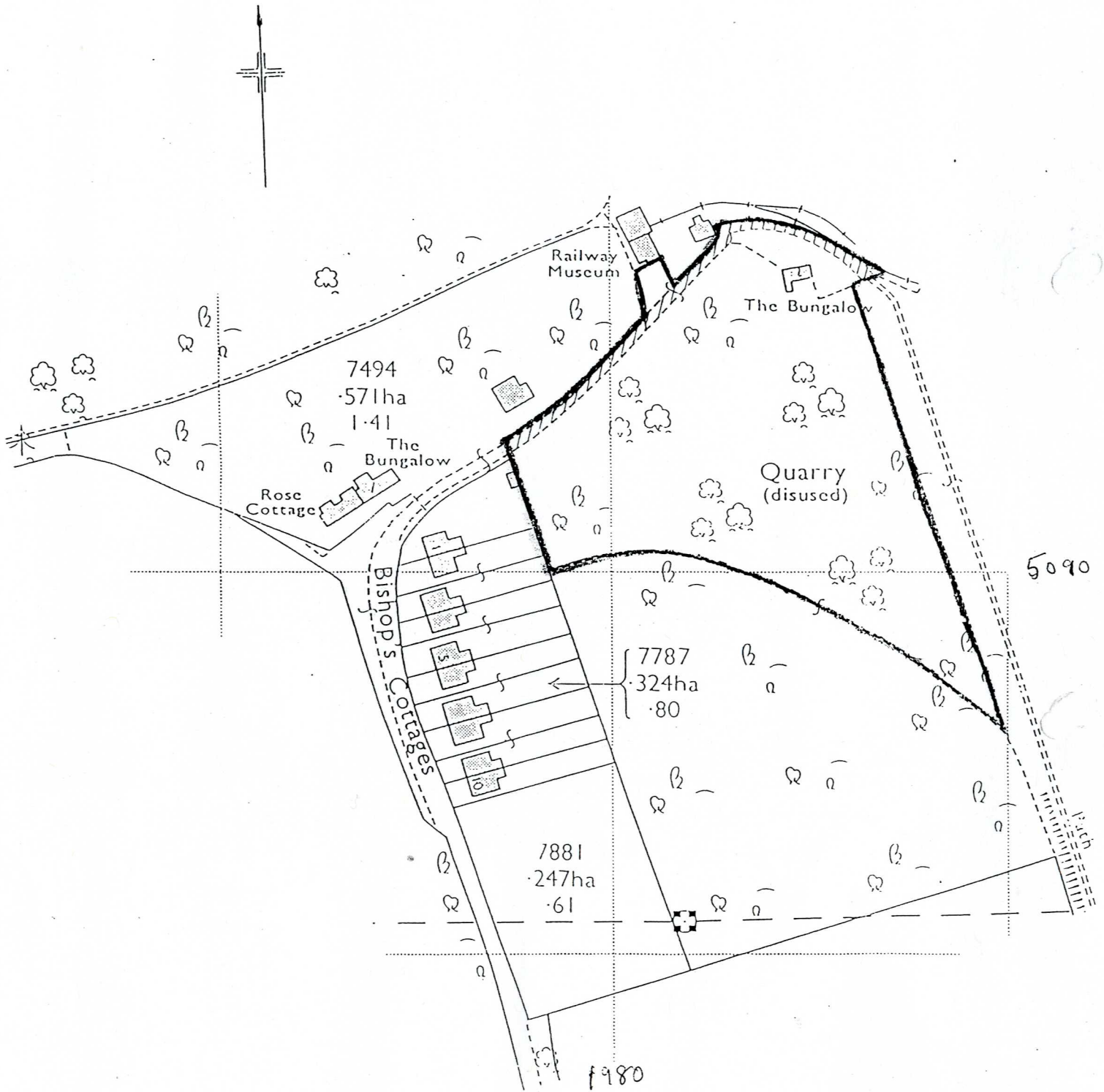

REGISTRY
 [Redacted Stamp]