

**DEPOSIT OF STATEMENT and PLAN
SECTION 31(6) OF THE HIGHWAYS ACT 1980**

To Surrey County Council:

1. I am and have been since 30.11.2011 [day, month, year] the owner within the meaning of the above section of the land known as MARDONS, SHOPHOUSE LANE, FARLEY GREEN GU5 9EQ
2. [name of farm, etc.] more particularly delineated on the plan accompanying this statement and thereon edged red.
3. The aforementioned land lies in the Parishes/Communities of ALBURY [name] and ~~..... [name].~~ *
- ~~4. The ways coloured brown on the said plan have been dedicated as highways with public vehicular status. *~~
- ~~5. The ways coloured plum on the said plan have been dedicated as restricted byways with public access in non-mechanically powered vehicles. *~~
- ~~6. The ways coloured green on the said plan have been dedicated as public bridleways. *~~
7. The ways coloured purple on the said plan have been dedicated as public footpaths. *
8. In accordance with the provisions of Section 31 of the Highways Act 1980, I declare that there are no other public rights of way of any sort over the aforesaid land nor do I recognise any other such public right of way whatsoever. *
- ~~9. Upon the said plan there is marked in blue a path for which I have given consent to members of the public to walk/ride over. However, this path is not being dedicated to the public at large to use. *~~
10. The deposit shall comprise this statement and accompanying plan.

* Delete as applicable

Signed [landowner]

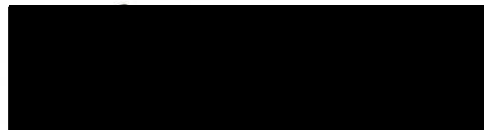

Name [of landowner]

ANTHONY WREFORD

Address

MARDONS
SHOPHOUSE LANE
FARLEY GREEN
ALBURY, SURREY GU5 9EQ.

Date

12.08.2013.

Signed [witness]

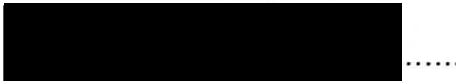

Name [of witness]

NEIL McCANCE

Address

2. PADDINGTON FARM COTTAGES
ABINGER HAMMER,
RHS. 6.SJ

Occupation

GARDENER

CY ALL

20 AUG 2013

RECEIVED

MARDONS, SHOPHOUSE LANE, FARLEY GREEN, ALBURY, GU15 9EQ.

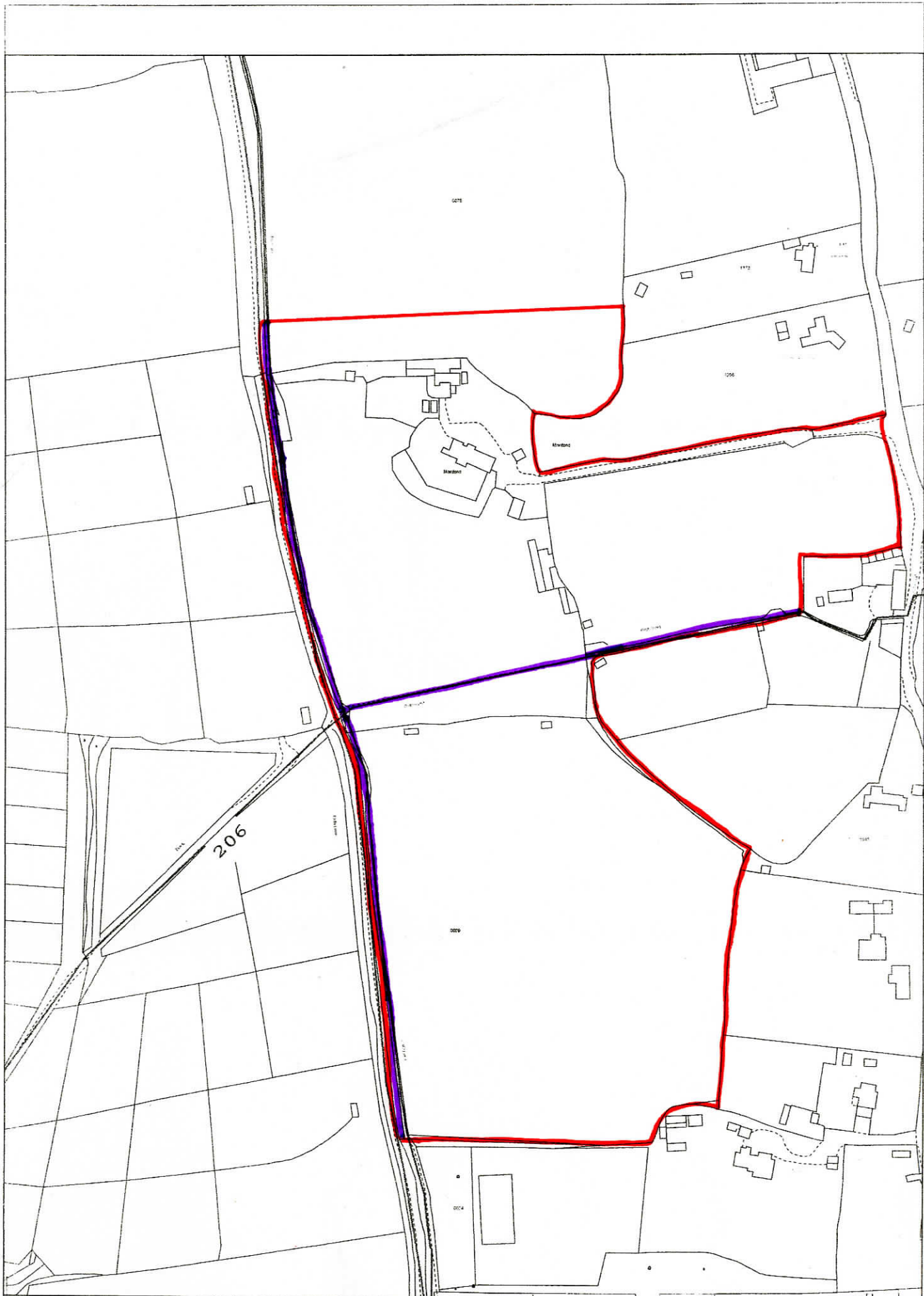

Scale 1:2500

© Crown Copyright Licence No. 100019613, Surrey County Council, 2006. Except A-Z mapping © Copyright of the Publishers Geographers' A-Z Map Company Ltd.

Date: 05/08/2013