

DEPOSIT OF STATEMENT and PLAN
SECTION 31(6)

To Surrey County Council:

1. We are and have been since ^{*1st April 1978*} [day, month, year] the owners within the meaning of the above section of the land known as land at Binscombe, Godalming more particularly delineated on the plan labelled "DJMW1" accompanying this statement and thereon edged red.
- 2 The aforementioned land lies in the Parish of Compton.
- 3 The ways coloured green on the said plan have been dedicated as public bridleways.
- 4 The ways coloured purple on the said plan have been dedicated as public footpaths.
- 5 In accordance with the provisions of Section 31 of the Highways Act 1980, we declare that there are no other public rights of way of any sort over the aforesaid land nor do we recognise any other such public right of way whatsoever.
- 6 The deposit shall comprise this statement and accompanying plan.

Signed [landowner]

[Redacted signature]

Name [of landowner] Guildford Diocesan Board of Finance

Address Diocesan House, Quarry Street, Guildford, Surrey GU1 3XG

Date

✓ 7 September 2007

Signed [witness]

[Redacted signature]

Name [of witness] SUSAN R MATTIN

Address

.....
DIOCESAN HOUSE
.....
QUARRY STREET
.....
GUILDFORD GU1 3XG
.....

Occupation

.....
PROPERTY ADMINISTRATOR
.....

* by virtue of Endowments and Glebe Measure 1976 and since time immemorial by successive Incumbents of the Benefice of Compton *

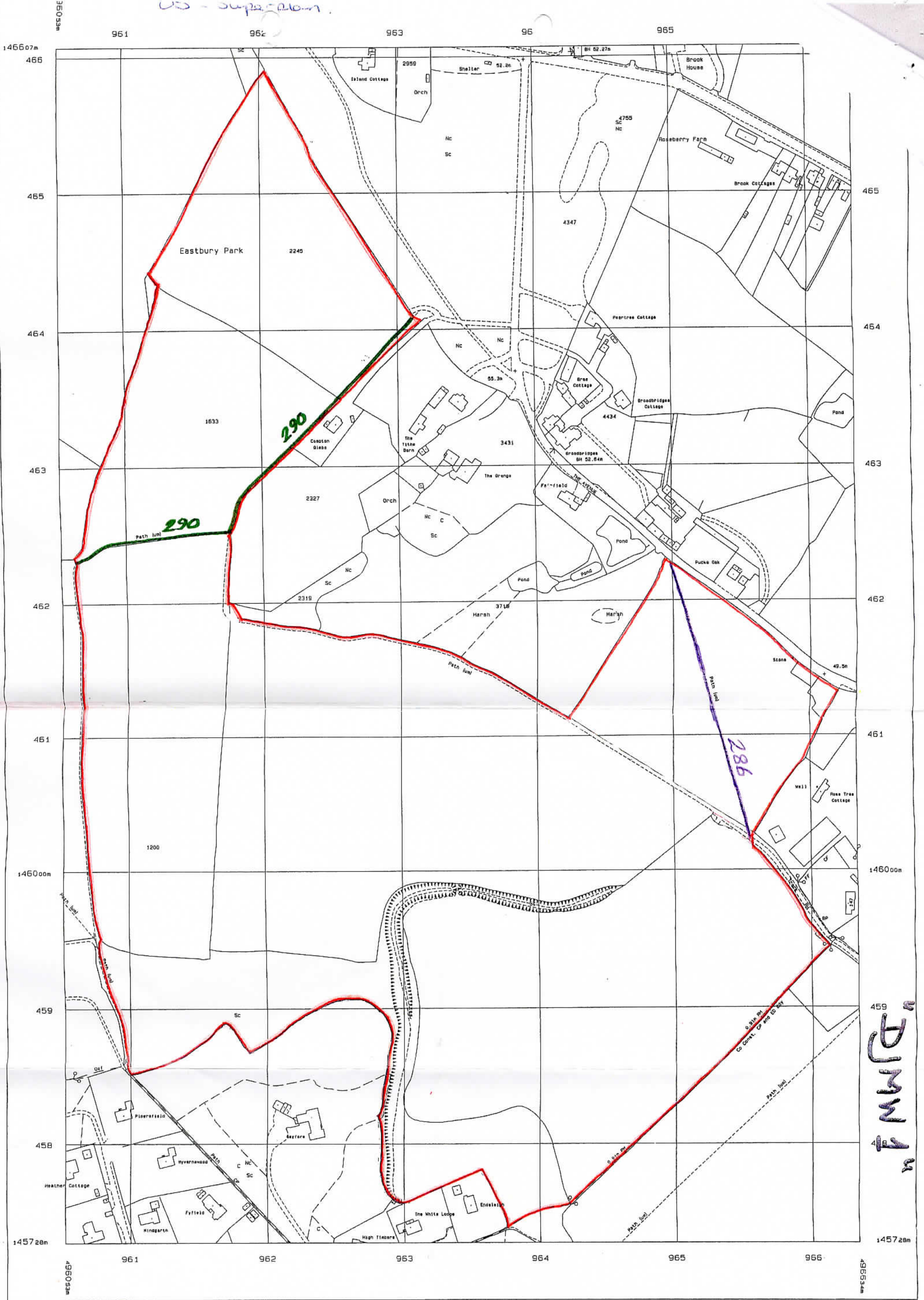

Produced 20 Feb 2002 from Ordnance Survey digital data and incorporating surveyed revision available at this date. © Crown Copyright 2002.

Reproduction in whole or in part is prohibited without the prior permission of Ordnance Survey.

Ordnance Survey the OS symbol and Superbrand

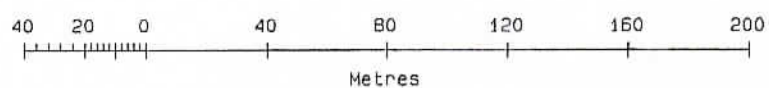

Scale 1:2500

National Grid sheet reference at centre