

Patrons:

Dame Sylvia Crowe, D.B.E.; The Right Honourable Lord Denning;
Dame Elisabeth Frink, D.B.E., R.A.; P. F. Garthwaite Esq., O.B.E.;
Sir Charles Groves, C.B.E.; R. Hammond Innes Esq., C.B.E.;
Professor W. G. Hoskins, C.B.E.; The Earl of Lichfield;
Miss Moura Lympany, C.B.E.; E. M. Nicholson Esq., C.B., C.V.O.

Council of Management:

K. Watkins, O.B.E. (Chairman); S. Edgcombe, J.P., F.C.A.;
C. P. Wright, M.Sc., A.R.I.C.S., A.L.I.; R. H. Trafford, M.A.;
D. G. Waddams, F.C.C.A.; T. H. White, F.R.I.C.S.;
T. W. Wright, B.Sc. (For), Ph.D.; D. H. Marks, M.I.P.A.



Executive Director: John D. James

If no telephone response at the number below
please ring (0476) 74297

Please reply to:

Chief Executive
Chief Executive Department
County Hall
Kingston-upon-Thames
Surrey
KT1 2DT

Brenda Leck
c/o Rose Cottage
Newton Tony
Salisbury
Wiltshire
SP4 OHS
Tel: 0252 547852

F.A.O. Mr Mike Hart

Our Ref: BL/vc/280

28th January 1991

Dear Sir

The Woodland Trust, a company limited by guarantee and registered charity No. 294344, of Autumn Park, Dysart Road, Grantham, Lincolnshire, freehold owners of the property known as Great Earls Wood which is shown outlined in red on the attached plan, hereby gives notice in accordance with the Section 31(6) of the Highways Act 1980 that there are no ways over the land shown on the attached plan as being owned by the Woodland Trust which have been dedicated a public highway except for those shown as such on the plan.

Yours faithfully

[Redacted signature]

28.1.91

BRENDA LECK
Assistant Woodland Officer authorised to sign on behalf of the
Woodland Trust

Enc

GREAT EARLS WOOD

The Woodland Trust

Registered Charity No. 264781

Autumn Park, Dysart Road,
Grantham,
Lincolnshire NG31 6LL
Telephone: (0476) 74297

Reproduced from the Ordnance Survey's

1:2500 (scale) map of

1966 (year) with the

permission of the Controller of
Her Majesty's Stationery Office,
Crown copyright reserved.

The Woodland Trust Date
Autumn Park, Grantham, Lincs NG31 6LL

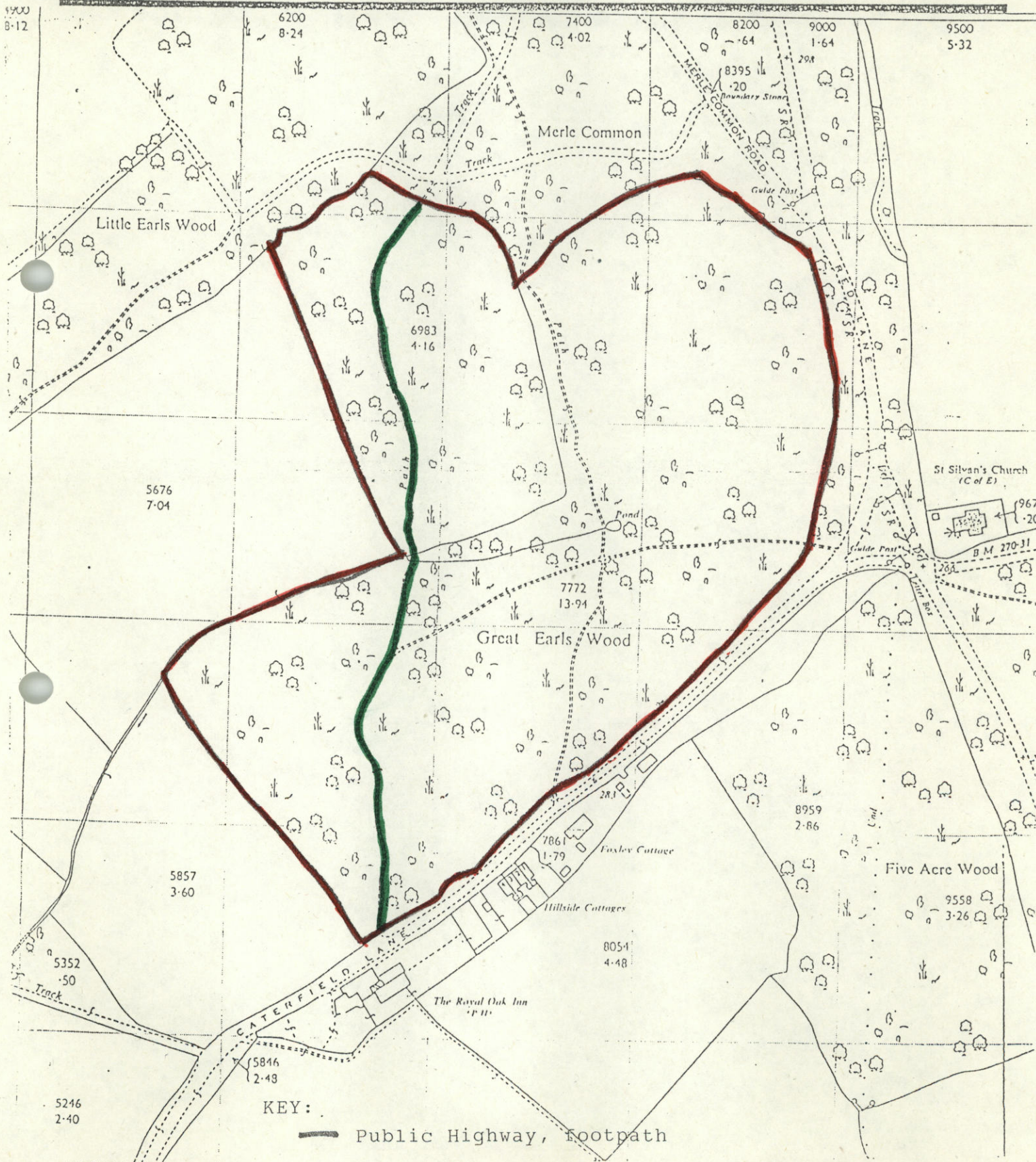

Patrons:
Dame Sylvia Crowe, D.B.E.; The Right Honourable Lord Denning;
Dame Elisabeth Frink, D.B.E., R.A.; P. F. Garthwaite Esq., O.B.E.;
Sir Charles Groves, C.B.E.; R. Hammond Innes Esq., C.B.E.;
Professor W. G. Hoskins, C.B.E.; The Earl of Lichfield;
Miss Moura Lympny, C.B.E.; E. M. Nicholson Esq., C.B., C.V.O.

Council of Management:
K. Watkins, O.B.E. (Chairman); S. Edgcumbe, J.P., F.C.A.;
C. P. Wright, M.Sc., A.R.I.C.S., A.L.I.; R. H. Trafford, M.A.;
D. G. Waddams, F.C.C.A.; T. H. White, F.R.I.C.S.;
T. W. Wright, B.Sc. (For), Ph.D.; D. H. Marks, M.I.P.A.



Executive Director: John D. James

If no telephone response at the number below
please ring (0476) 74297

Please reply to:

Chief Executive
Chief Executive Department
County Hall
Kingston-upon-Thames
Surrey
KT1 2DT

Brenda Leck
c/o Rose Cottage
Newton Tony
Salisbury
Wiltshire
SP4 OHS
Tel: 0252 547852

F.A.O. Mr Mike Hart

Our Ref: BL/vc/287

28th January 1991

Dear Sir

The Woodland Trust, a company limited by guarantee and registered charity No. 294344, of Autumn Park, Dysart Road, Grantham, Lincolnshire, freehold owners of the property known as Woodland by Sylvan Lodge being land on the north side of Murtmead Lane, Puttenham, Surrey which is shown outlined in red on the attached plan, hereby gives notice in accordance with the Section 31(6) of the Highways Act 1980 that there are no ways over the land shown on the attached plan as being owned by the Woodland Trust which have been dedicated a public highway except for those shown as such on the plan.

Yours faithfully

[Redacted signature]

28-1-91

BRENDA LECK
Assistant Woodland Officer authorised to sign on behalf of the
Woodland Trust

Enc

LASCOMBE WALK

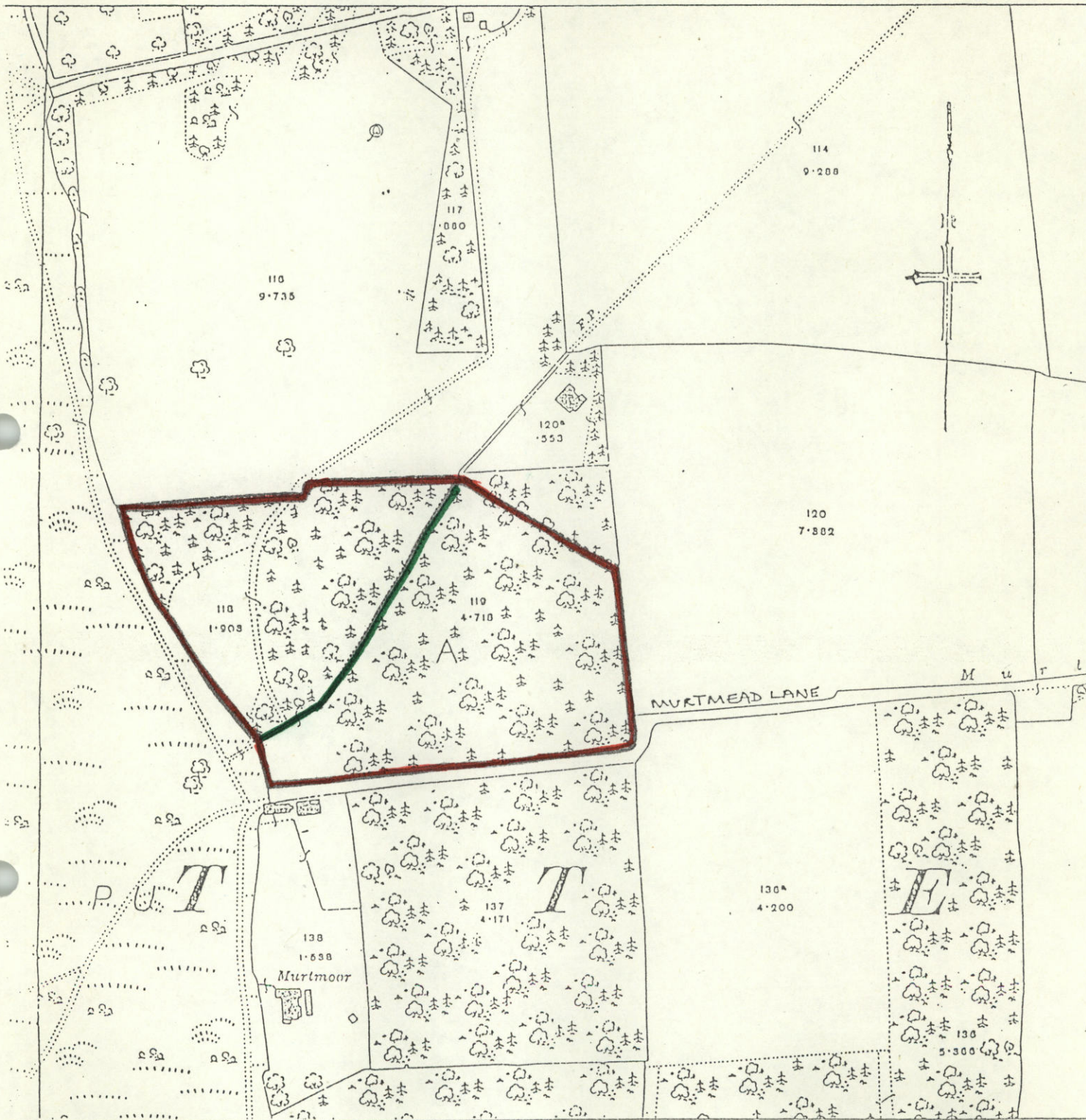

KEY:  Public Highway, footpath

Director: John D. James
Deputy Director: E.A. Hamilton, M.A., M.Sc.

The Woodland Trust
Autumn Park, Grantham,
Lincolnshire NG31 6LL.
Tel. (0476) 74297.

Reproduced from the Ordnance Survey's
1:2500 (scale) map of
1928 (year) with the
permission of the Controller of
Her Majesty's Stationery Office.
Crown copyright reserved.
The Woodland Trust Date
Autumn Park, Grantham, Lincs NG31 6LL

