

**DEPOSIT OF STATEMENT and PLAN  
SECTION 31(6) OF THE HIGHWAYS ACT 1980**

To: Surrey County Council  
Countryside Legal  
Room 365a County Hall  
Penrhyn Road  
Kingston-upon-Thames  
KT1 2DY

1. I am and have been since 10 August 2009 the registered co-owner, along with Nicola Jane Kentish-Barnes as the trustees of the BAFCOL Trust, within the meaning of the above Section, of the freehold land known as land lying to the south of the railway line, Jenkins Hill, Bagshot, Surrey (registered under H.M. Land Registry freehold Title Number SY368912) more particularly delineated on the extract of the Land Registry Filed Plan accompanying this statement and thereon edged in red marked 'Plan 1'.
2. The aforementioned land lies in the Parish of Windlesham Parish Council.
3. Upon a separate plan accompanying this statement marked 'Plan 2', and prepared by Surrey County Council, and which is an extract from their Definitive Map, I have also shown edged in red the extent of my land. There are presently no public rights of way shown crossing my land within the red edging.
4. In accordance with the provisions of Section 31 of the Highways Act 1980, I declare that there are no public rights of way of any sort over the aforementioned land nor do I recognise any such public rights of way over the said land.
5. The deposit shall comprise this statement and accompanying plans marked 'Plan 1' and 'Plan 2'.

Signed (landowner) .....  .....  
Mr Peter John Fane

Name of landowners: Mr Peter John Fane and Nicola Jane Kentish Barnes (as Trustees of the BAFCOL Trust)

Address of landowner: C/O Thomson Snell & Passmore, 3 Lonsdale Gardens, Tunbridge Wells, TN1 1NX

Date: ..... 21 FEBRUARY 2011 .....

Signed (witness):  .....

Address (of witness): ..... 6 CANBERRA CLOSE .....

..... LATEWELL HANTS GU46 7PZ .....

Occupation (of witness): ..... FINANCER .....



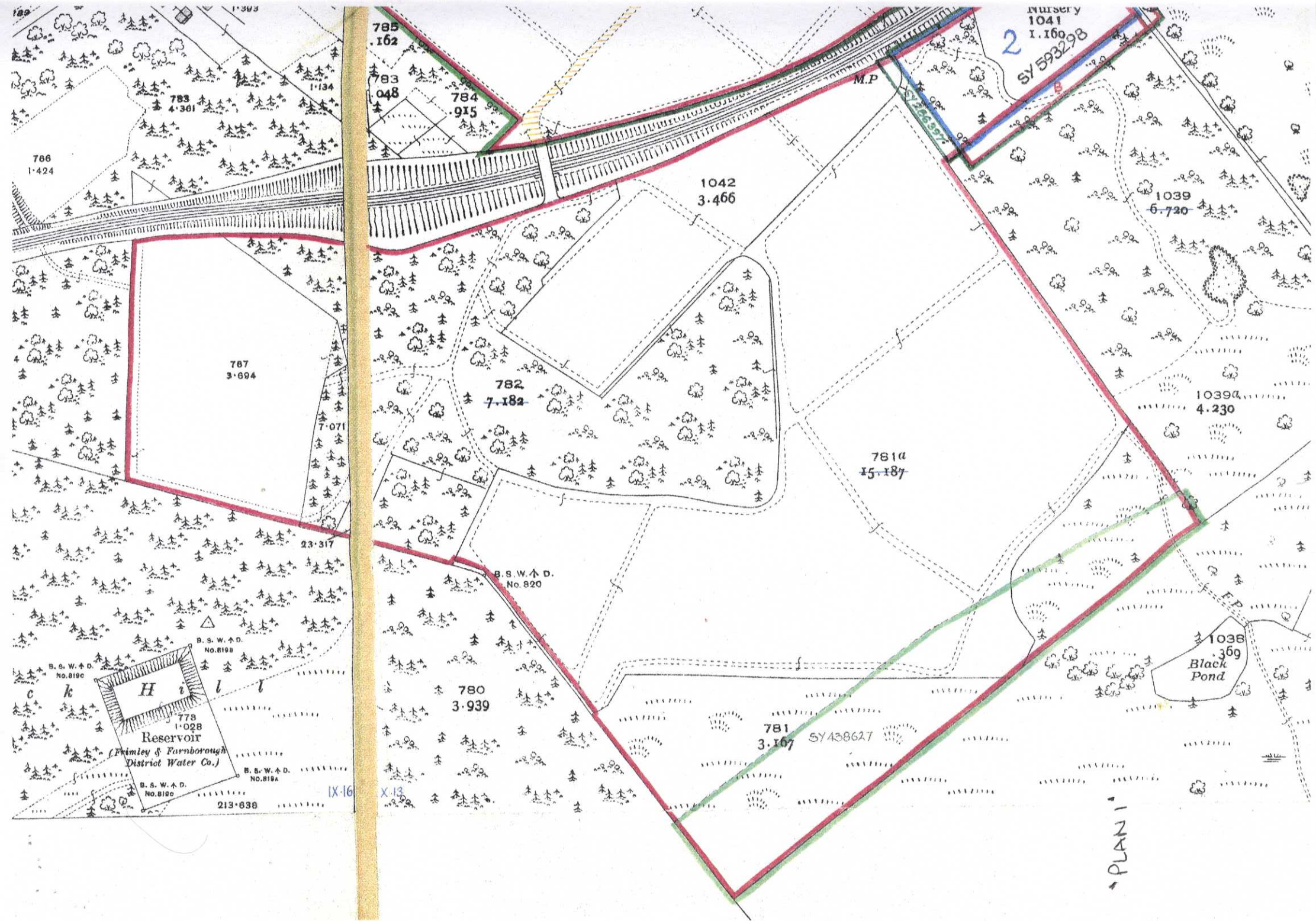

Nursery  
1041  
1.160  
SY 593298

M.P.

766  
1.424

783  
4.361

785  
1.162

783  
0.48

784  
0.915

1042  
3.466

787  
3.694

782  
7.182

781a  
15.187

1039  
6.720

1039a  
4.230

B.S.W. & D.  
No. 820

780  
3.939

781  
3.167  
SY 438627

1038  
369  
Black Pond

H 2  
778  
1.028  
Reservoir  
(Himley & Earningborough  
District Water Co.)

B.S.W. & D.  
No. 819c

B.S.W. & D.  
No. 819a

213-638

IX-16

X-13

PLAN 1



BERKSHIRE COUNTY  
THAMES VALLEY EURO CONST  
LONG 0° 42' W  
BRACKNELL DISTRICT  
EAST BERKSHIRE CO CONST

- Path
- ence of a right of way
- track
- Standard gauge
- armway
- al line
- gauge
- Coppice
- Orchard
- Coniferous trees
- Non-coniferous trees

- Chalk pit, clay pit or quarry
- Gravel pit
- Sand pit
- Refuse or slag heap
- Sand
- Shingle
- Sloping wall
- Lake, loch or pond

- lands Area (Scotland)
- European Assembly sheets containing areas (larger scales) where there is no publication (es)
- Const & ED Bdy picture whether or not a

CONVERSION SCALE

