

STATUTORY DECLARATION
SECTION 31(6) OF THE HIGHWAYS ACT 1980

I, Ian Vernon Cresswell, of County Hall Kingston upon Thames Surrey KT1 2DN

DO SOLEMNLY AND SINCERELY DECLARE as follows: -

1. I am a Chartered Surveyor employed at Surrey County Council ("the Council") as its Area Delivery Manager. I have been employed at Surrey County Council since March 1986.

1 The Council is the owner of the areas of land shown on the attached schedule and has been from the dates shown thereon and more particularly delineated on the plans accompanying this declaration and thereon edged black.

2 On the 21st day of June 2010 the Council deposited with Surrey County Council, being the appropriate Council, statements accompanied by plans delineating its property shown on the attached schedule by black edging which stated that the ways coloured purple on the said plans and on the plans accompanying this declaration had been dedicated as footpaths. *which I produce as Exhibit "IVC 1"*

* 3 No additional ways have been dedicated over the areas of land edged black on the plans accompanying this declaration since the statement dated 21st day of June 2010 referred to in paragraph 2 above other than those footpaths coloured on the plans accompanying this declaration. *which I produce as Exhibit "IVC 2"*

AND I MAKE this solemn declaration on the *16th* day of *August* 2010 conscientiously believing it to be true and by virtue of the Statutory Declarations Act 1835.

Declared at [address]

W H Matthews & Co
19 Penryhn Road
Kingston upon Thames
Surrey KT1 2BZ

Signed on behalf of the landowner

[Redacted signature]

Before me [Commissioner for Oaths or a Justice of the Peace or Solicitor]

[Redacted signature]

ROSANNA LEIST

This is the Exhibit marked "IVC1" referred to in the Declaration of Ian Vernon Cresswell.

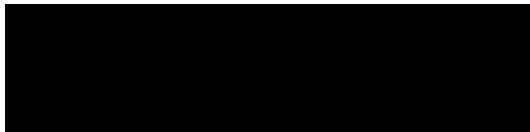

Declared before me Leist ROSANNA LEIST
This 16th day of August in the year 2010.

W H Matthews & Co
19 Penryhn Road
Kingston upon Thames
Surrey KT1 2BZ

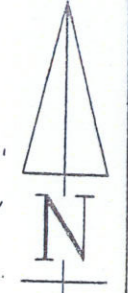

Client



SURREY
 COUNTY COUNCIL

Notes
 Based upon 1986 Ordnance Survey 1:1250 mapping with the permission of the Controller of H.M.S.O. © Crown copyright. Unauthorised reproduction infringes Crown copyright and may lead to prosecution or civil proceedings.

Rev.	Description	Date	By	Chk'd

O.S. Ref. TQ 0266

Surveyed by	Drawn by	Checked by
Date	Date 30.11.98	Date 30.11.98

BRUTON
KNOWLES

Bruton Knowles
 Shelsley House
 Randalls Business Park
 Randalls Way
 Leatherhead Tel: 01372 226100
 Surrey KT22 7TX Fax: 01372 226200

Scale
 1:1250

Location
 ALMERS FARM
 ALMERS ROAD
 LYNE

Title
 ESTATE PLAN

Plan Reg. No.	BK 454
Plan File No.	D 21

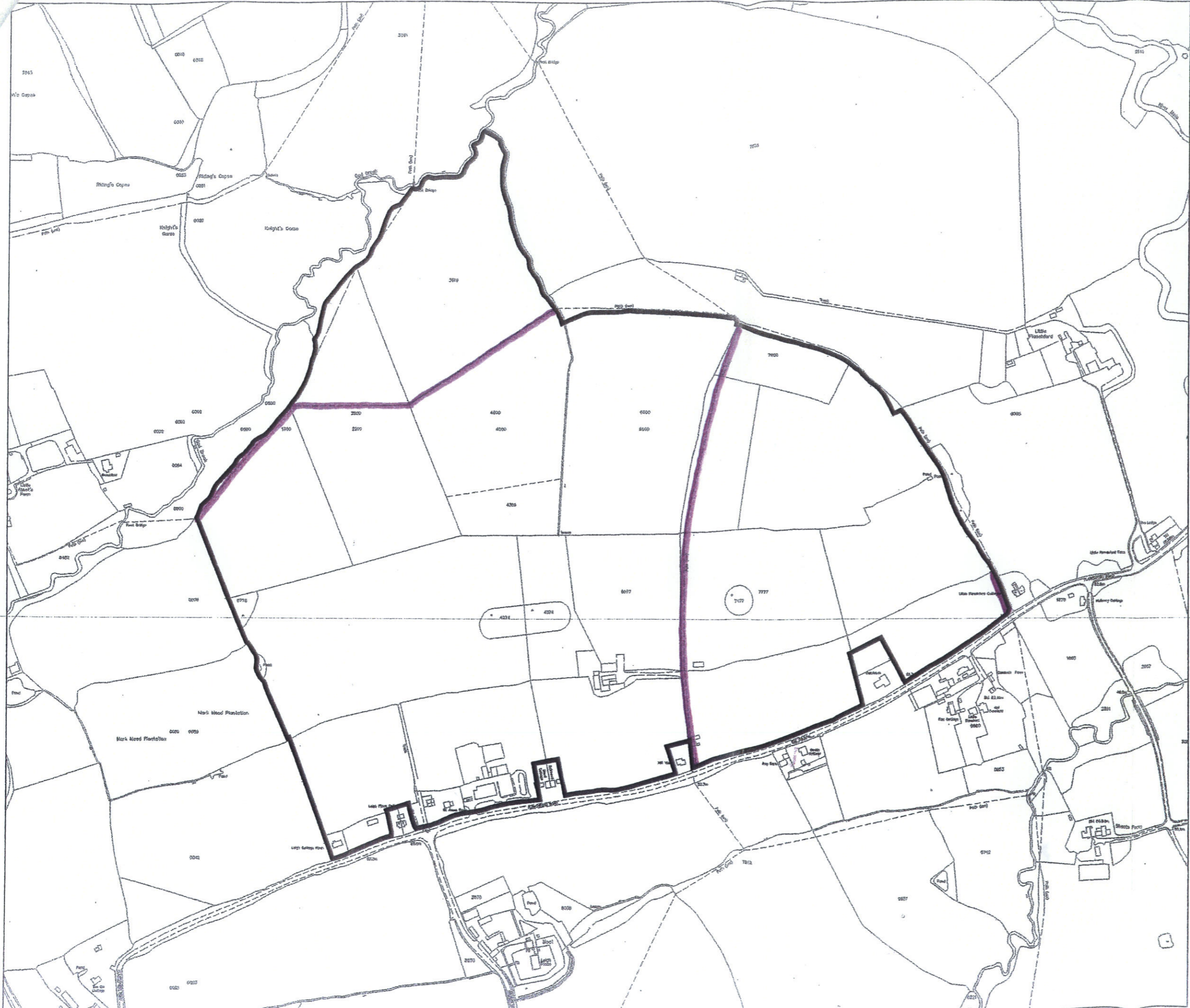

Based upon the Ordnance Survey mapping with the permission of the Controller of H.M.S.O. © Crown Copyright. Unauthorised reproduction infringes Crown Copyright and may lead to prosecution or civil proceedings. Surrey County Council LA 076872 1996.

Notes
 1. Computer file number: H:\CMU\SURVEY\acad drawings CM885

Rev.	Description	Date	By	Chk'd
------	-------------	------	----	-------



Construction Management Unit, County Hall,
 Penryhn Road, Kingston upon Thames, Surrey, KT1 2DN.
 Tel : 020 8541 9231

O.S. Ref.	SU 9440 NE/9441 SE		
Scale	1:5000		
Surveyed by	Drawn by	Checked by	
	SLH	KBD	
Date	Date 12.10.05	Date 12.10.05	

Location
LEIGH PLACE ESTATE
LEIGH

Title
ESTATE PLAN

Plan Reg. No.	CM 885
Plan File No.	D 23

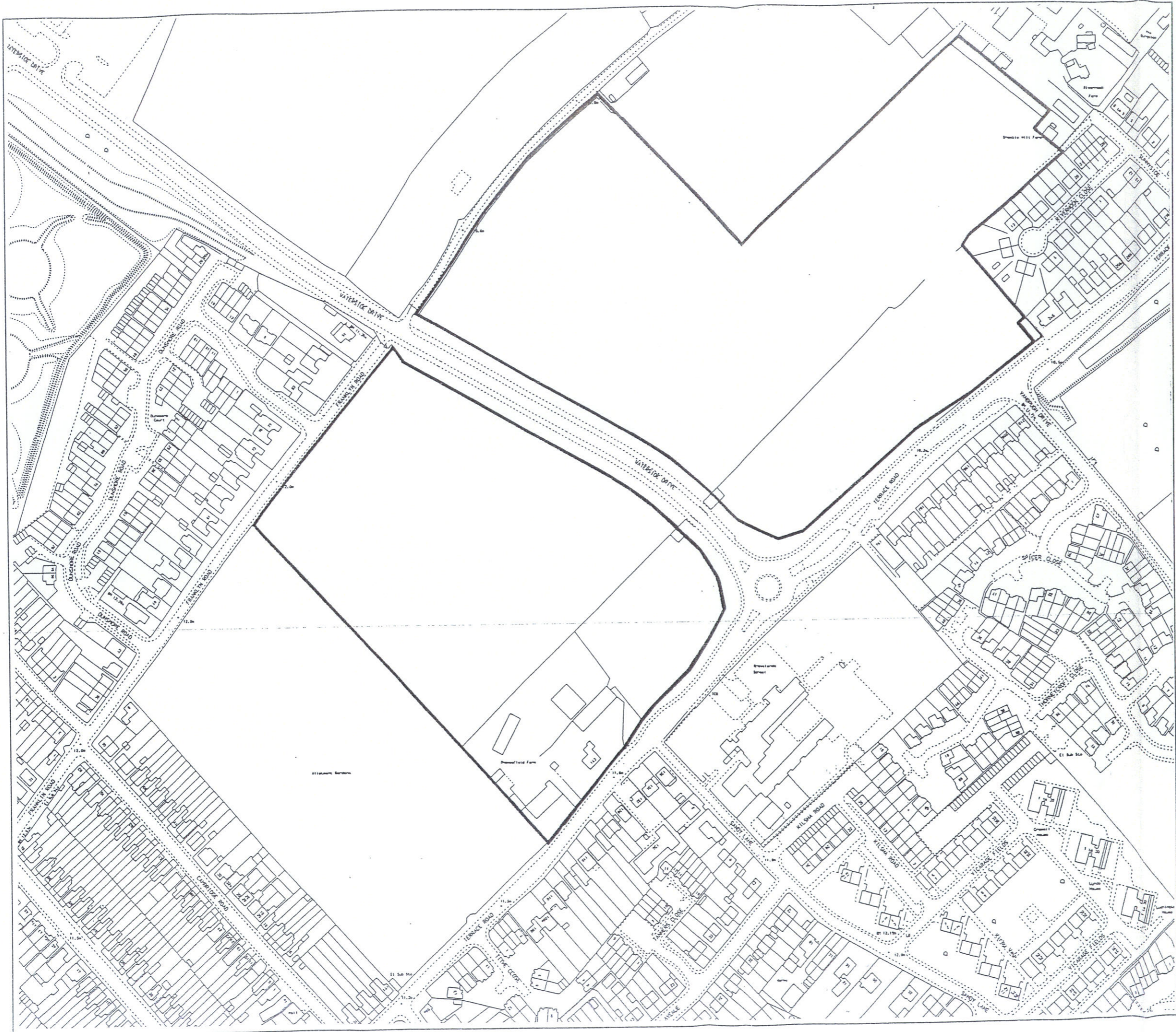

Client



Based upon the Ordnance Survey mapping with the permission of the Controller of H.M.S.O. © Crown Copyright. Unauthorised reproduction infringes Crown Copyright and may lead to prosecution or civil proceedings. Surrey County Council LA 076872 1996.

Notes

1. Computer file number: \\BKSU01\AutoCAD drawings\BK458A

Rev.	Description	Date	By	Chk'd
A	Boundary amended	30.10.01	SLH	GST

BK

Bruton Knowles
Shelsley House
Randalls Business Park
Randalls Way
Leatherhead
Surrey KT22 7TX

THE PROPERTY
ASSETS
CONSULTANCY

Tel: 01372 226100
Fax: 01372 226200

O.S. Ref. TQ 16 NW

Scale 1:2500

Surveyed by	Drawn by	Checked by
	SLH	GST
Date	Date 30.11.98	Date 30.11.98

Location

THAMESFIELD FARM
TERRACE ROAD
WALTON - ON - THAMES

Title

ESTATE PLAN

Plan Reg. No.	BK 458A
Plan File No.	D 30

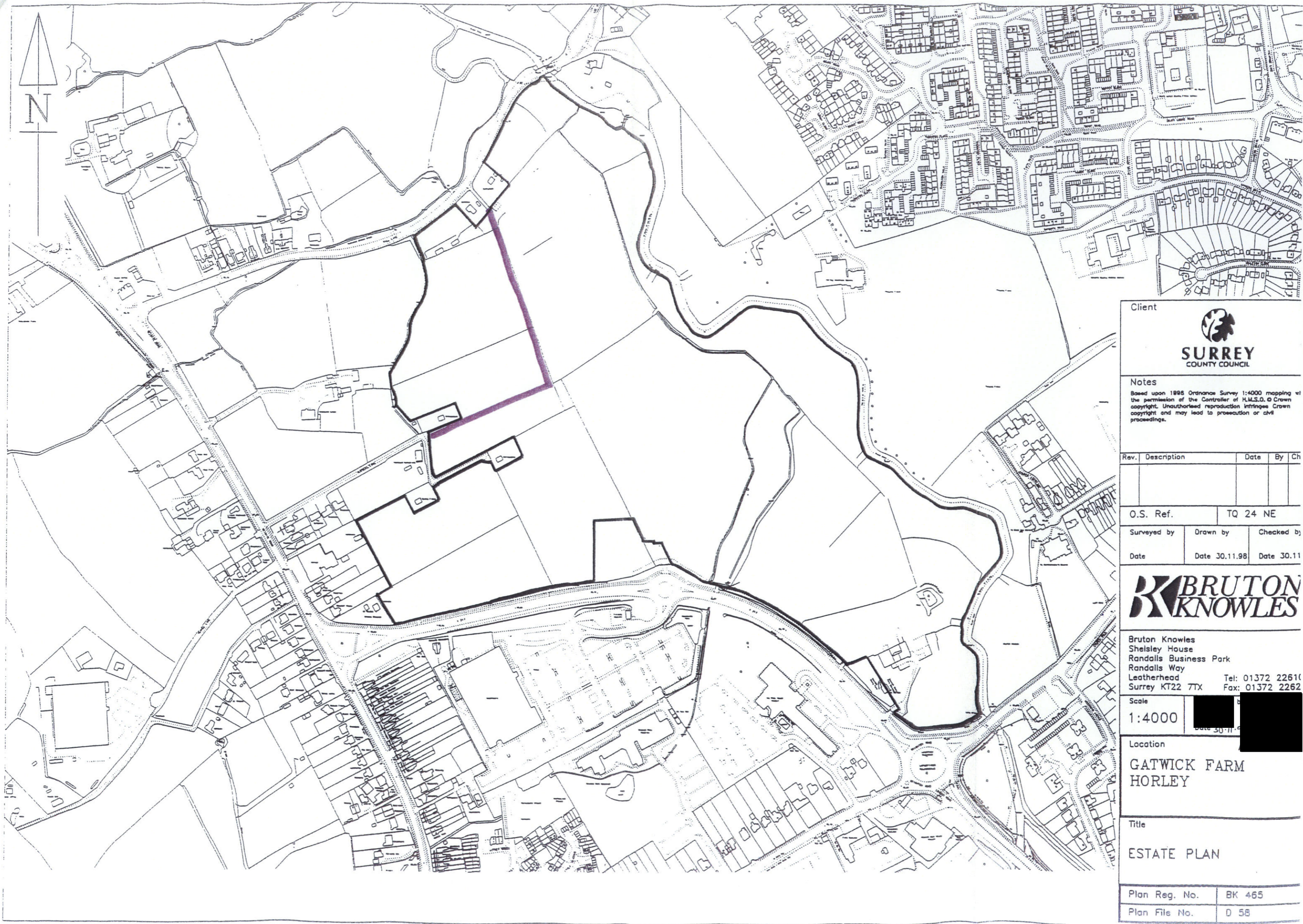

Client



SURREY
 COUNTY COUNCIL

Notes
 Based upon 1996 Ordnance Survey 1:4000 mapping with the permission of the Controller of H.M.S.O. © Crown copyright. Unauthorised reproduction infringes Crown copyright and may lead to prosecution or civil proceedings.

Rev.	Description	Date	By	Ch

O.S. Ref. TQ 24 NE

Surveyed by	Drawn by	Checked by
Date	Date 30.11.98	Date 30.11

BRUTON
KNOWLES

Bruton Knowles
 Shelsley House
 Randalls Business Park
 Randalls Way
 Leatherhead Tel: 01372 22610
 Surrey KT22 7TX Fax: 01372 2262

Scale
 1:4000

Location
GATWICK FARM
HORLEY

Title
ESTATE PLAN

Plan Reg. No.	BK 465
Plan File No.	D 58

Client



SURREY COUNTY COUNCIL

Notes

Based upon 1998 Ordnance Survey 1:2500 mapping with the permission of the Controller of H.M.S.O. © Crown copyright. Unauthorised reproduction infringes Crown copyright and may lead to prosecution or civil proceedings.

Rev.	Description	Date	By	Chk'd

O.S. Ref. SU 8246

Surveyed by [Redacted] Checked by [Redacted]
Date 08.12.98 Date 08.12.98



Bruton Knowles
Shelsley House
Randalls Business Park
Randalls Way
Leatherhead
Surrey KT22 7TX
Tel: 01372 226100
Fax: 01372 226200

Scale 1:5000 by [Redacted] /1-99

Location

COXBRIDGE FARM
FARNHAM

Title

ESTATE PLAN

Plan Reg. No. BK 463

Plan File No. D 54

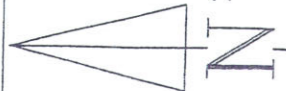

KEY	
[Symbol]	K Kenward
[Symbol]	Grazing

Client



Notes
Based upon 1998 Ordnance Survey 1:2500 mapping with the permission of the Controller of H.M.S.O. © Crown copyright. Unauthorised reproduction infringes Crown copyright and may lead to prosecution or civil proceedings.

Rev. Description Date By Chk'd

O.S. Ref. TO 24 SE

Surveyed by [Redacted] Checked by [Redacted]
Date 30.11.98 Date 30.11.98



Bruton Knowles
Shelsley House
Randalls Business Park
Randalls Way
Leatherhead
Surrey KT22 7TX
Tel: 01372 226100
Fax: 01372 226200

Scale 1:2500
Drawn by [Redacted] Date 31-08-99
Checked by [Redacted] Date 17/11/99

Location
BAYHORNE FARM
HORLEY

Title
ESTATE PLAN
Plan Reg. No. BK 464
Plan File No. D 56

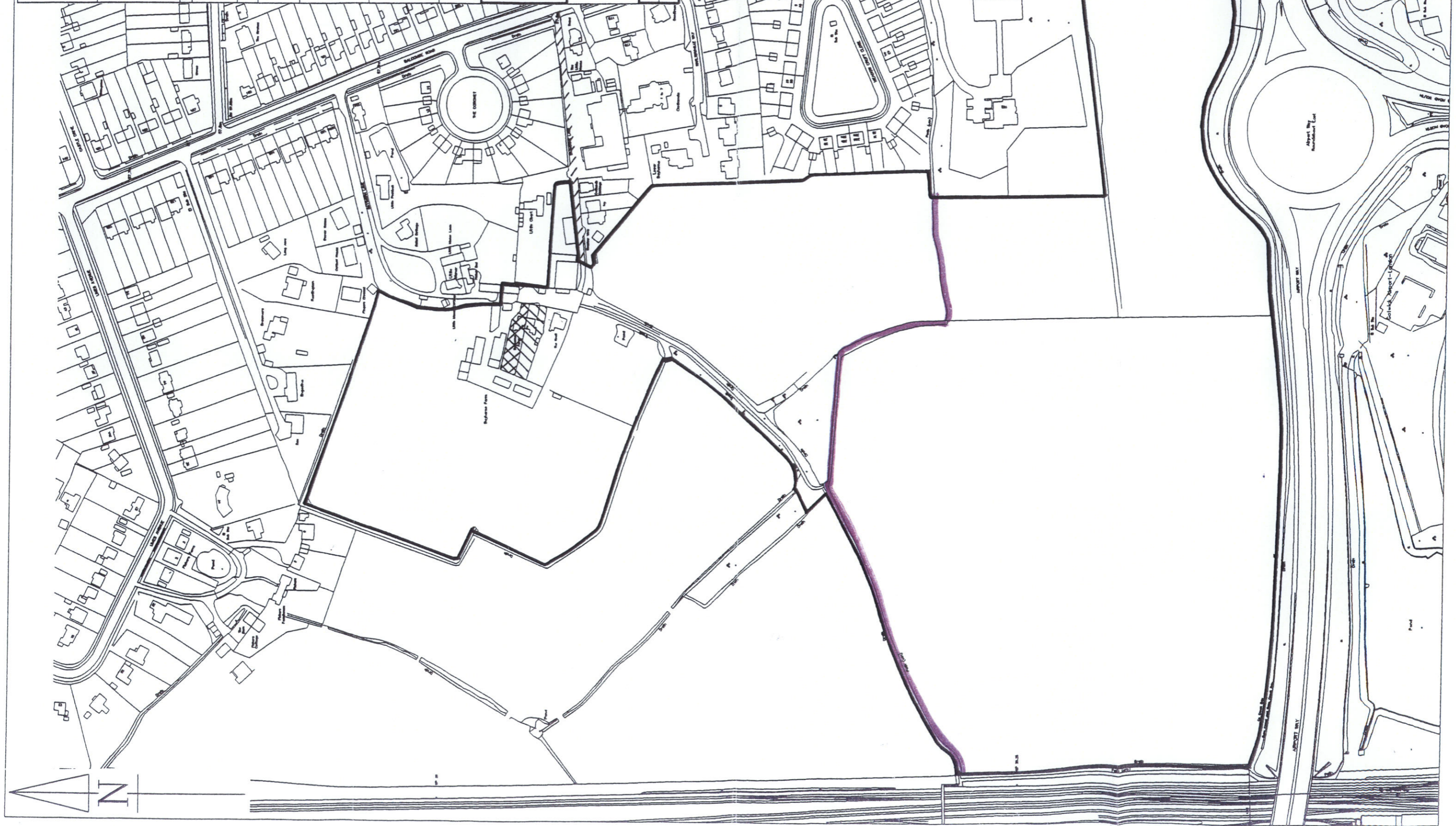

This is the Exhibit marked "IVC2" referred to in the Declaration of Ian Vernon Cresswell.



Declared before me



ROSANNA LEIST

This 16th day of August in the year 2010.

W H Matthews & Co
19 Penryhn Road
Kingston upon Thames
Surrey KT1 2BZ

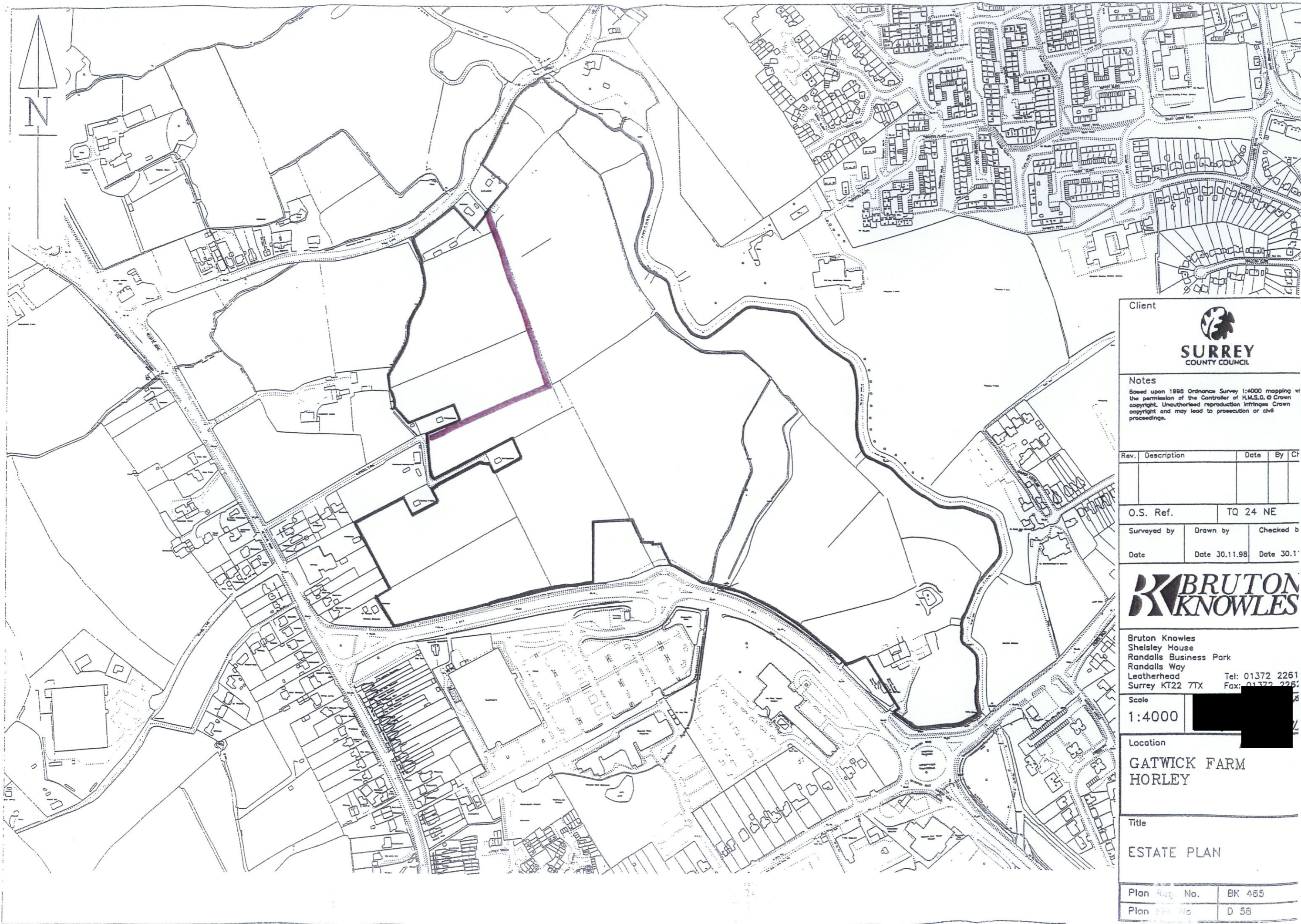

Client



SURREY
COUNTY COUNCIL

Notes

Based upon 1995 Ordnance Survey 1:4000 mapping of the permission of the Controller of H.M.S.O. © Crown copyright. Unauthorised reproduction infringes Crown copyright and may lead to prosecution or civil proceedings.

Rev.	Description	Date	By	Cl

O.S. Ref. TQ 24 NE

Surveyed by	Drawn by	Checked by

Date Date 30.11.98 Date 30.11.98



Bruton Knowles
Shelsley House
Randalls Business Park
Randalls Way
Leatherhead Tel: 01372 2261
Surrey KT22 7TX Fax: 01372 2262

Scale
1:4000

Location
GATWICK FARM
HORLEY

Title
ESTATE PLAN

Plan Ref. No. BK 465

Plan File No. D 58

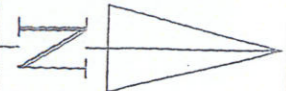

Client



Notes
Based upon 1998 Ordnance Survey 1:2500 mapping with the permission of the Controller of H.M.S.O. © Crown copyright. Unauthorised production infringes Crown proceedings and may lead to prosecution or civil proceedings.

Rev.	Description	Date	By	Chk'd
	O.S. Ref.	SU 8246		
	Surveyed by	Drawn by	Checked by	
	Date	Date 08.12.98	Date 08.12.98	



Bruton Knowltes
Shelsley House
Randalls Business Park
Randalls Way
Leatherhead
Surrey KT22 7TX
Tel: 01372 226100
Fax: 01372 226200

Scale
1:5000
Compiled by [redacted] Checked by [redacted]
Date 3.06.99 Date 17.11.99

Location
COXBRIDGE FARM
FARNHAM

Title
ESTATE PLAN

Plan Reg. No. BK 463
Plan File No. D 54

KEY	
	K Kenward
	Grazing

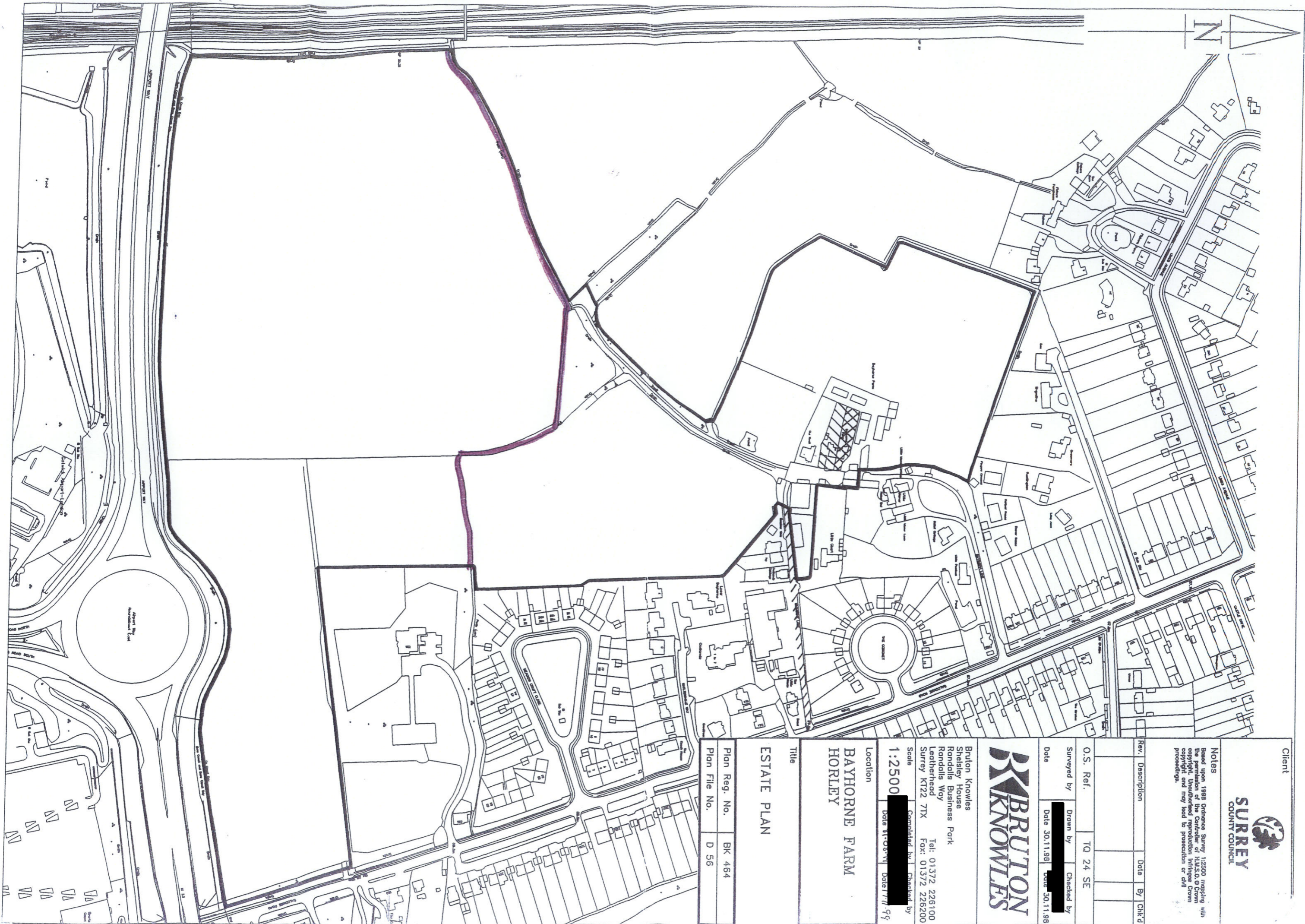

Client



SURREY
COUNTY COUNCIL

Notes
Based upon 1998 Ordnance Survey 1:2500 mapping with the permission of the Controller of H.M.S.O. © Crown copyright and may lead to prosecution or civil proceedings.

Rev.	Description	Date	By	CHK'd
	O.S. Ref.	TQ 24 SE		
	Surveyed by	Drawn by	Checked by	
	Date	Date 30.11.98	Date 30.11.98	



BRUTON KNOWLES
Shelsley House
Rondalls Business Park
Rondalls Way
Leatherhead
Surrey KT22 7TX
Tel: 01372 226100
Fax: 01372 226200

Scale
1:2500
Completed by
Date 11.05.98
Checked by
Date 17.7.98

Location
**BAYHORNE FARM
HORLEY**

Title
ESTATE PLAN

Plan Reg. No. BK 464
Plan File No. D 56



Based upon the Ordnance Survey mapping with the permission of the Controller of H.M.S.O. © Crown Copyright. Unauthorised reproduction infringes Crown Copyright and may lead to prosecution or civil proceedings. Surrey County Council LA 076872 1996.

Notes
 1. Computer file number: H:\CMU\Survey\acad drawings CM885

Rev.	Description	Date	By	Chk'd
------	-------------	------	----	-------

SURREY COUNTY COUNCIL
 Construction Management Unit, County Hall,
 Penryhn Road, Kingston upon Thames, Surrey, KT1 2DN.
 Tel : 020 8541 9231

O.S. Ref.	SU 9440 NE/9441 SE
-----------	--------------------

Scale	1:5000
-------	--------

Surveyed by	Drwn by	Checked by
	SLH	KBD
Date	Date 12.10.05	Date 12.10.05

Location
LEIGH PLACE ESTATE
LEIGH

Title
ESTATE PLAN

Plan Reg. No.	CM 885
Plan File No.	D 23