

DEPOSIT OF STATEMENT and PLAN
SECTION 31(6) OF THE HIGHWAYS ACT 1980

To Surrey County Council:

- 1 The applicant is and has been since March 1913 the owner within the meaning of the above section of the land known as Gatwick Farm, Hookwood more particularly delineated on the plan accompanying this statement and thereon edged black.
- 2 The aforementioned land lies in the Paris/Community of Hookwood, Horley.
- 3 The ways coloured purple on the said plan have been dedicated as public footpaths.
- 4 In accordance with the provisions of Section 31 of the Highways Act 1980, the applicant declares that there are no other public rights of way of any sort over the aforesaid land nor does it recognise any other such public right of way whatsoever.
- 5 The deposit shall comprise this statement and accompanying plan.

Signed on behalf the landowner

[REDACTED]

Name of signatory

J V CRESSWELL

Status of signatory

DELIVERY MANAGER - ERM

Name of landowner

Surrey County Council

Address

County Hall
Kingston upon Thames
KT1 2DN

Date

21/01/2010

Signed witness

[REDACTED]

Name of witness

ADRIAN SAUCROFT

Status of signatory

ESTATES SURVEY

Address

COUNTY HALL
KINGSTON UPON THAMES
KT1 2DN

Occupation

CHARTERED SURVEYOR

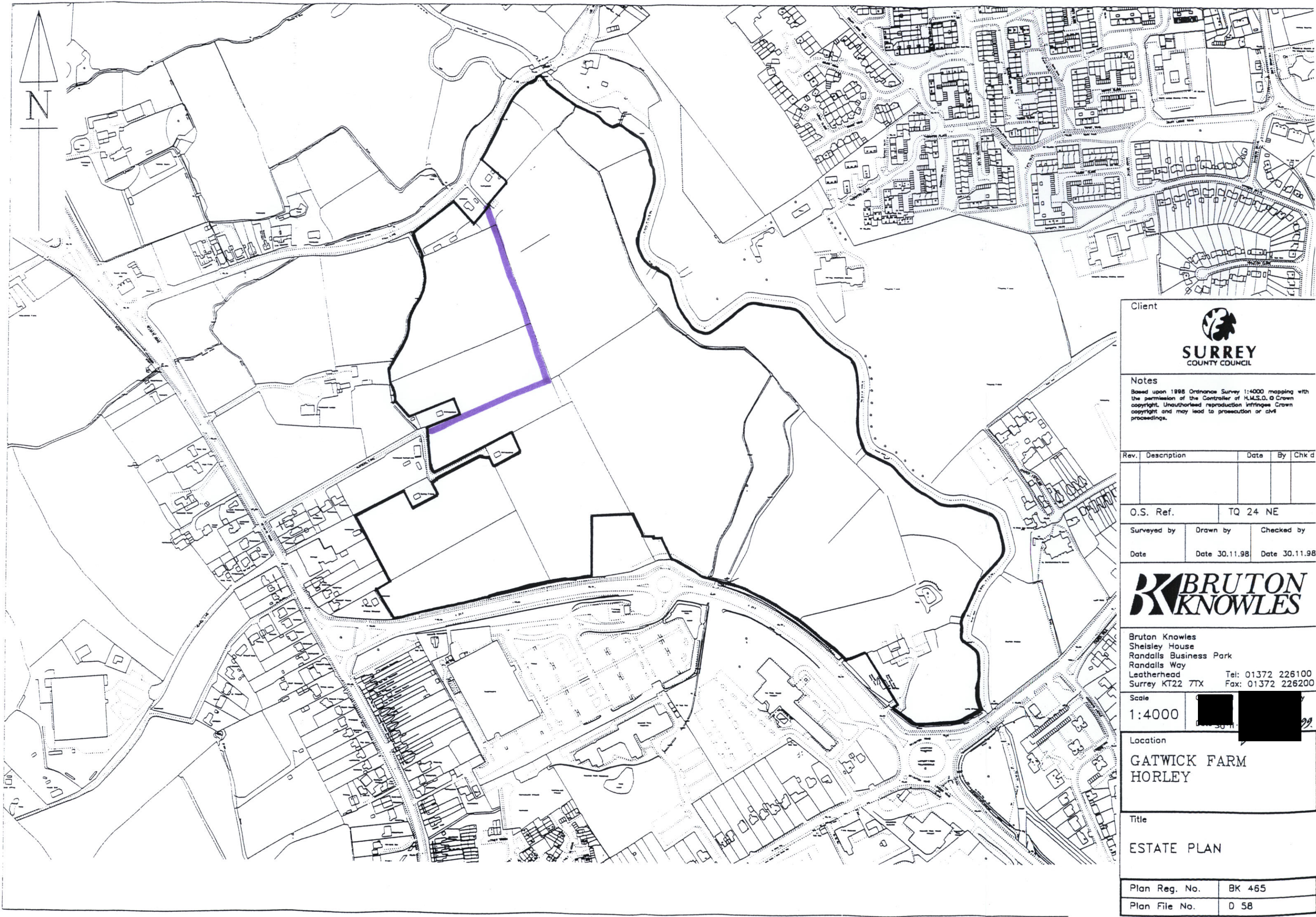

Client

SURREY
 COUNTY COUNCIL

Notes

Based upon 1988 Ordnance Survey 1:4000 mapping with the permission of the Controller of H.M.S.O. © Crown copyright. Unauthorised reproduction infringes Crown copyright and may lead to prosecution or civil proceedings.

Rev.	Description	Date	By	Chk'd

O.S. Ref. TQ 24 NE

Surveyed by	Drawn by	Checked by
Date	Date 30.11.98	Date 30.11.98

BRUTON
KNOWLES

Bruton Knowles
 Shelsley House
 Randalls Business Park
 Randalls Way
 Leatherhead Surrey KT22 7TX
 Tel: 01372 226100
 Fax: 01372 226200

Scale
 1:4000

Location
GATWICK FARM
HORLEY

Title
ESTATE PLAN

Plan Reg. No.	BK 465
Plan File No.	D 58

DEPOSIT OF STATEMENT and PLAN
SECTION 31(6) OF THE HIGHWAYS ACT 1980

To Surrey County Council:

- 1 The applicant is and has been since March 1913 the owner within the meaning of the above section of the land known as Gatwick Farm, Hookwood more particularly delineated on the plan accompanying this statement and thereon edged black.
- 2 The aforementioned land lies in the Parish/Community of Hookwood, Horley.
- 3 The ways coloured purple on the said plan have been dedicated as public footpaths.
- 4 In accordance with the provisions of Section 31 of the Highways Act 1980, the applicant declares that there are no other public rights of way of any sort over the aforesaid land nor does it recognise any other such public right of way whatsoever.
- 5 The deposit shall comprise this statement and accompanying plan.

Signed on behalf the landowner

[Redacted Signature]

Name of signatory

J. V. CRESSWELL

Status of signatory

DELIVERY MANAGER - EPM

Name of landowner

Surrey County Council

Address

County Hall
Kingston upon Thames
KT1 2DN

Date

14/6/2010.

Signed witness

[Redacted Signature]

Name of witness

ADRIAN SANCROFT

Status of signatory

ESTATES SURVEYOR

Address

COUNTY HALL
KINGSTON UPON THAMES
KT1 2DN

Occupation

CHARTERED SURVEYOR

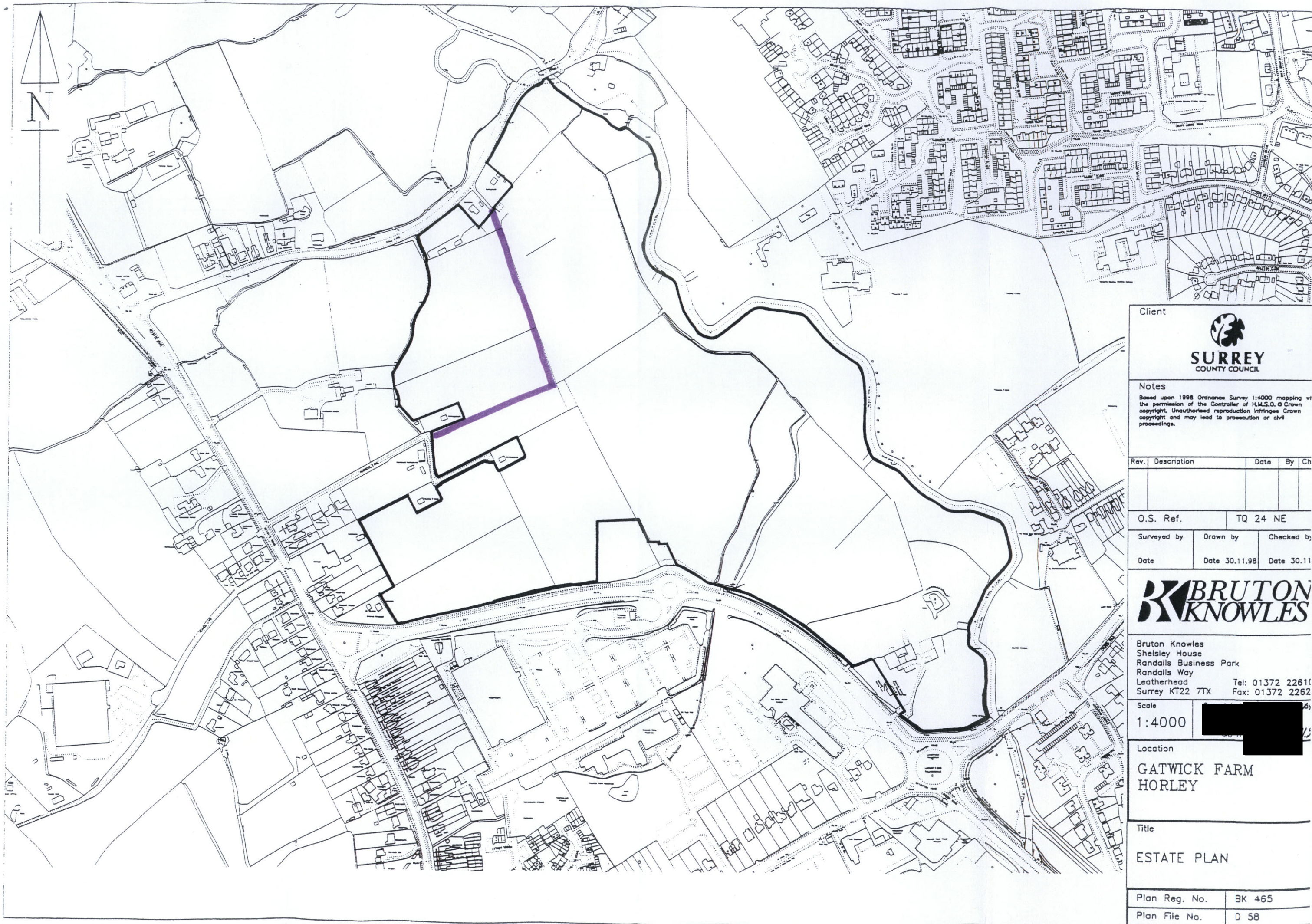

Client



SURREY
 COUNTY COUNCIL

Notes
 Based upon 1998 Ordnance Survey 1:4000 mapping with the permission of the Controller of H.M.S.O. © Crown copyright. Unauthorised reproduction infringes Crown copyright and may lead to prosecution or civil proceedings.

Rev.	Description	Date	By	Ch

O.S. Ref. TQ 24 NE

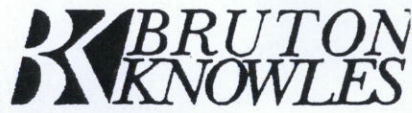
Surveyed by	Drawn by	Checked by
Date	Date 30.11.98	Date 30.11

BRUTON
KNOWLES

Bruton Knowles
 Shelsley House
 Randalls Business Park
 Randalls Way
 Leatherhead Surrey KT22 7TX
 Tel: 01372 22610
 Fax: 01372 2262

Scale
 1:4000

Location
GATWICK FARM
HORLEY

Title
ESTATE PLAN

Plan Reg. No.	BK 465
Plan File No.	D 58