

DEPOSIT OF STATEMENT and PLAN
SECTION 31(6) OF THE HIGHWAYS ACT 1980

To Surrey County Council:

- 1 The applicant is and has been since April 1965 the owner within the meaning of the above section of the land known as Land adjoining The Mayford Centre, Smarts Heath Road, Woking more particularly delineated on the plan accompanying this statement and thereon edged red.
- 2 The aforementioned land lies in the Parish/Community of Mayford and Woking.
- 3 In accordance with the provisions of Section 31 of the Highways Act 1980, the applicant declares that there are no public rights of way of any sort over the aforesaid land nor does it recognise any other such public right of way whatsoever.
- 4 The deposit shall comprise this statement and accompanying plan.

Signed on behalf the landowner 

Name of signatory J. V. CRESSWELL

Status of signatory AREA DELIVERY MANAGER - EDM.

Name of landowner Surrey County Council

Address County Hall
Kingston upon Thames
KT1 2DN

Date 29 DECEMBER 2011

Signed witness 

Name of witness SARAH E. WALKER

Status of signatory SENIOR ESTATES SURVEYOR

Address COUNTY HALL
..... KINGSTON UPON THAMES
..... KT1 2DN

Occupation CHARTERED SURVEYOR

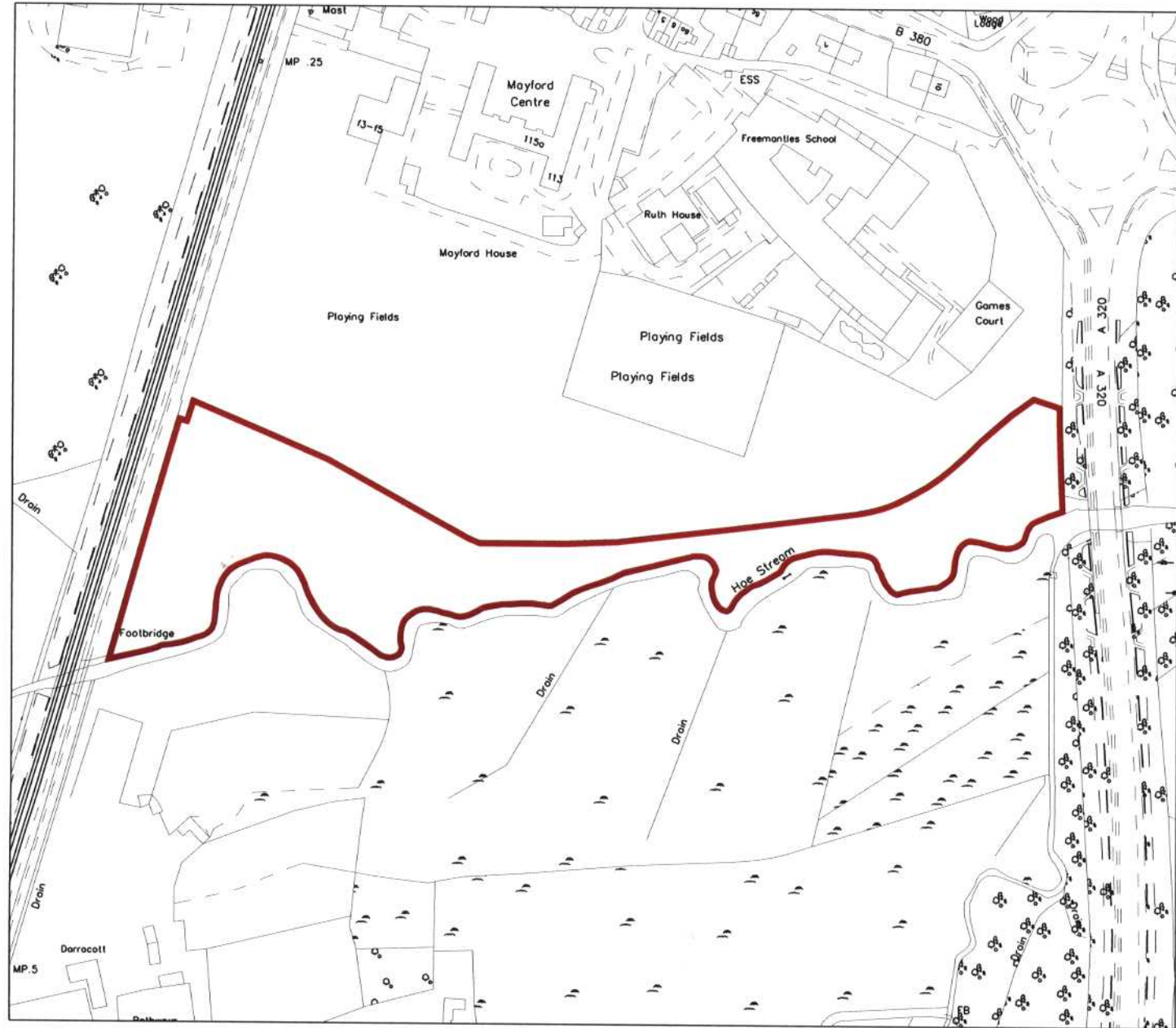

Based upon the Ordnance Survey mapping with the permission of the Controller of H.M.S.O. © Crown copyright. Unauthorised reproduction infringes Crown copyright and may lead to prosecution or civil proceedings. Surrey County Council LA 076872 1996.

Notes

Rev.	Description	Date	By	Chk'd



Estates Planning & Management, County Hall,
Penryhn Road, Kingston upon Thames, Surrey, KT1 2DW.
Tel : 020 8541 7233

O.S. Ref.	SU 9955		
Scale	1:2500 @ A4		
Surveyed by	Drawn by	Checked by	
Date	KBD	Date 22.11.11	Date

Location
LAND ADJACENT THE MAYFORD CENTRE
SMARTS HEATH ROAD
WOKING

HIGHWAYS ACT 1980
S.31(6) DECLARATION