

**STATUTORY DECLARATION**  
**SECTION 31(6) OF THE HIGHWAYS ACT 1980**

I, Ian Vernon Cresswell, of County Hall Kingston upon Thames Surrey KT1 2DN

DO SOLEMNLY AND SINCERELY DECLARE as follows: -

1. I am a Chartered Surveyor employed at Surrey County Council ("the Council") as its Area Delivery Manager. I have been employed at Surrey County Council since March 1986.

1 The Council is the owner of the areas of land shown on the attached schedule and has been from the dates shown thereon and more particularly delineated on the plans accompanying this declaration and thereon edged black.

2 On the 21<sup>st</sup> day of June 2010 the Council deposited with Surrey County Council, being the appropriate Council, statements accompanied by plans delineating its property shown on the attached schedule by black edging which stated that the ways coloured purple on the said plans and on the plans accompanying this declaration had been dedicated as footpaths *which I produce as Exhibit "IVC 1"*

\* 3 No additional ways have been dedicated over the areas of land edged black on the plans accompanying this declaration since the statement dated 21<sup>st</sup> day of June 2010 referred to in paragraph 2 above other than those footpaths coloured on the plans accompanying this declaration. *which I produce as Exhibit "IVC 2"*

AND I MAKE this solemn declaration on the *16<sup>th</sup>* day of *August* 2010 conscientiously believing it to be true and by virtue of the Statutory Declarations Act 1835.

Declared at [address] .....

**W H Matthews & Co**  
19 Penryhn Road  
Kingston upon Thames  
Surrey KT1 2BZ

Signed on behalf of the landowner

[Redacted Signature]

Before me [~~Commissioner for Oaths or a Justice of the Peace or Solicitor~~]

[Redacted Signature]

*ROSANNA LEIST*

This is the Exhibit marked "IVC1" referred to in the Declaration of Ian Vernon Cresswell.

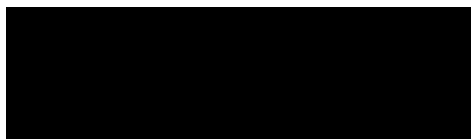

Declared before me





ROSANNA LEIST

This 16<sup>th</sup> day of August in the year 2010.

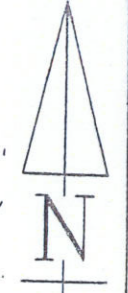
**W H Matthews & Co**  
19 Penryhn Road  
Kingston upon Thames  
Surrey KT1 2BZ



Client			
 <b>SURREY</b> COUNTY COUNCIL			
Notes			
Based upon 1986 Ordnance Survey 1:1250 mapping with the permission of the Controller of H.M.S.O. © Crown copyright. Unauthorised reproduction infringes Crown copyright and may lead to prosecution or civil proceedings.			
Rev.	Description	Date	By Chk'd
O.S. Ref.		TQ 0266	
Surveyed by	Drawn by	Checked by	
	S.L. Hempton	[Redacted]	
Date	Date 30.11.98	Date 30.11.98	
			
Bruton Knowles Shelsley House Randalls Business Park Randalls Way Leatherhead Surrey KT22 7TX Tel: 01372 226100 Fax: 01372 226200			
Scale	Completed by	Checked by	
1:1250	S.L. Hempton	[Redacted]	
	Date 20.05.99	Date 19.11.99	
Location			
<b>ALMERS FARM</b> <b>ALMERS ROAD</b> <b>LYNE</b>			
Title			
<b>ESTATE PLAN</b>			
Plan Reg. No.	BK 454		
Plan File No.	D 21		

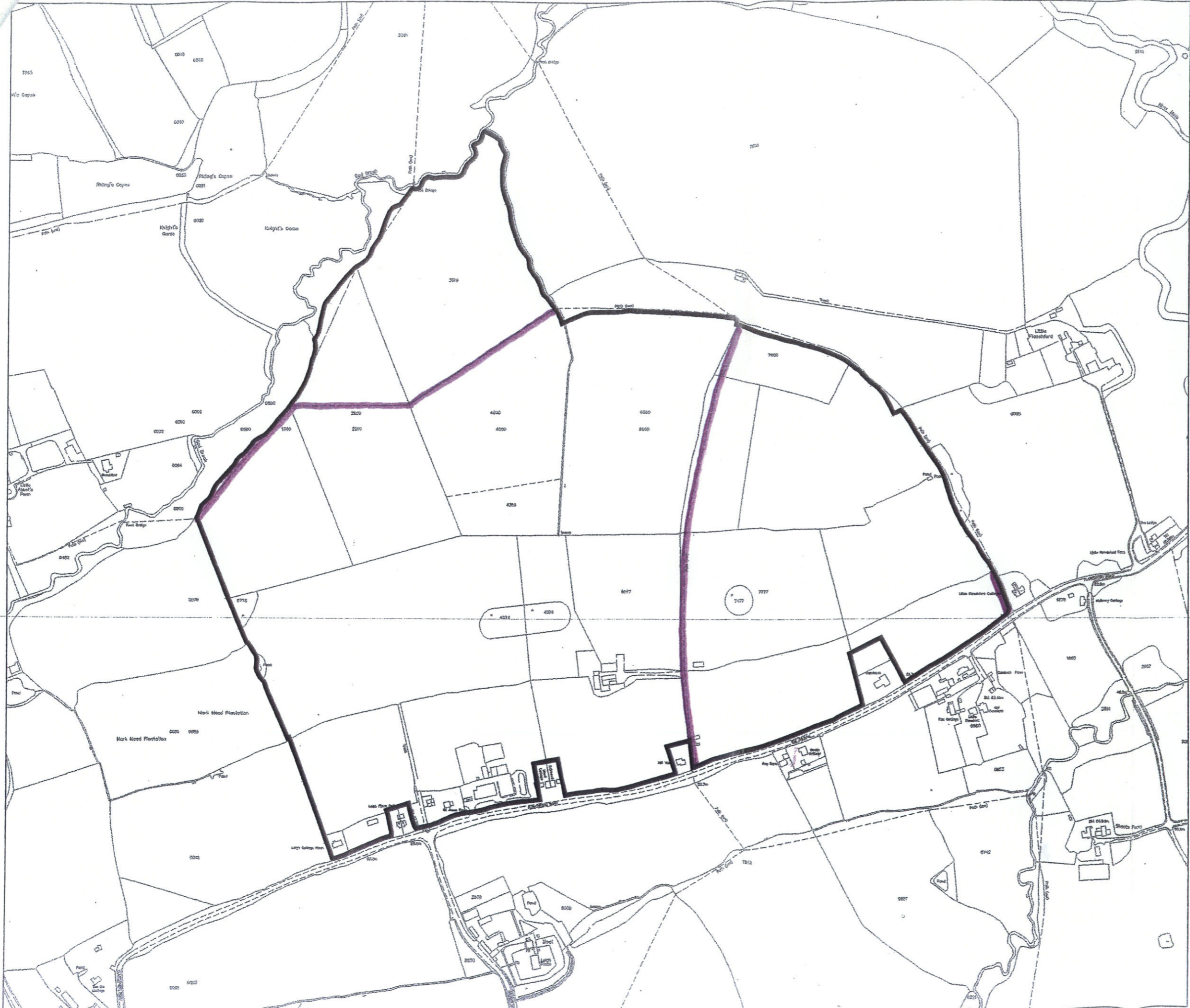

Based upon the Ordnance Survey mapping with the permission of the Controller of H.M.S.O. © Crown Copyright. Unauthorised reproduction infringes Crown Copyright and may lead to prosecution or civil proceedings. Surrey County Council LA 076872 1996.

Notes  
1. Computer file number: H:\CMU\SURVEY\acad drawings CM885

Rev.	Description	Date	By	Chk'd
------	-------------	------	----	-------



Construction Management Unit, County Hall,  
Penryhn Road, Kingston upon Thames, Surrey, KT1 2DN.  
Tel : 020 8541 9231

O.S. Ref.	SU 9440 NE/9441 SE		
Scale	1:5000		
Surveyed by	Drawn by	Checked by	
	SLH	KBD	
Date	Date 12.10.05	Date 12.10.05	

Location  
**LEIGH PLACE ESTATE**  
**LEIGH**

Title  
**ESTATE PLAN**

Plan Reg. No.	CM 885
Plan File No.	D 23

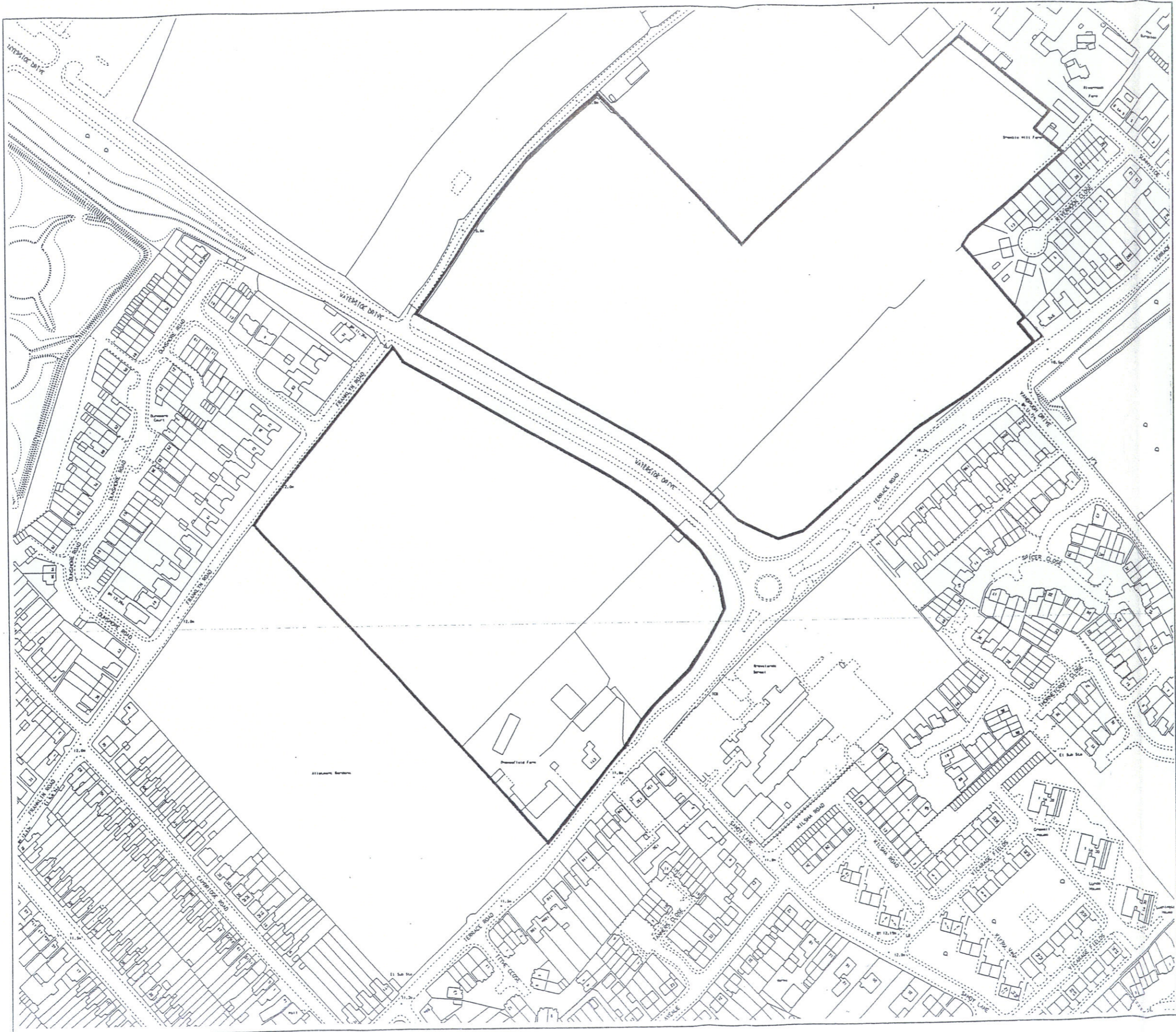

Client



Based upon the Ordnance Survey mapping with the permission of the Controller of H.M.S.O. © Crown Copyright. Unauthorised reproduction infringes Crown Copyright and may lead to prosecution or civil proceedings. Surrey County Council LA 076872 1996.

Notes

1. Computer file number: \\BKSU01\AutoCAD drawings\BK458A

Rev.	Description	Date	By	Chk'd
A	Boundary amended	30.10.01	SLH	GST

BK

Bruton Knowles  
Shelsley House  
Randalls Business Park  
Randalls Way  
Leatherhead  
Surrey KT22 7TX

THE PROPERTY  
ASSETS  
CONSULTANCY

Tel: 01372 226100  
Fax: 01372 226200

O.S. Ref. TQ 16 NW

Scale 1:2500

Surveyed by	Drawn by	Checked by
	SLH	GST
Date	Date 30.11.98	Date 30.11.98

Location

THAMESFIELD FARM  
TERRACE ROAD  
WALTON - ON - THAMES

Title

ESTATE PLAN

Plan Reg. No.	BK 458A
Plan File No.	D 30

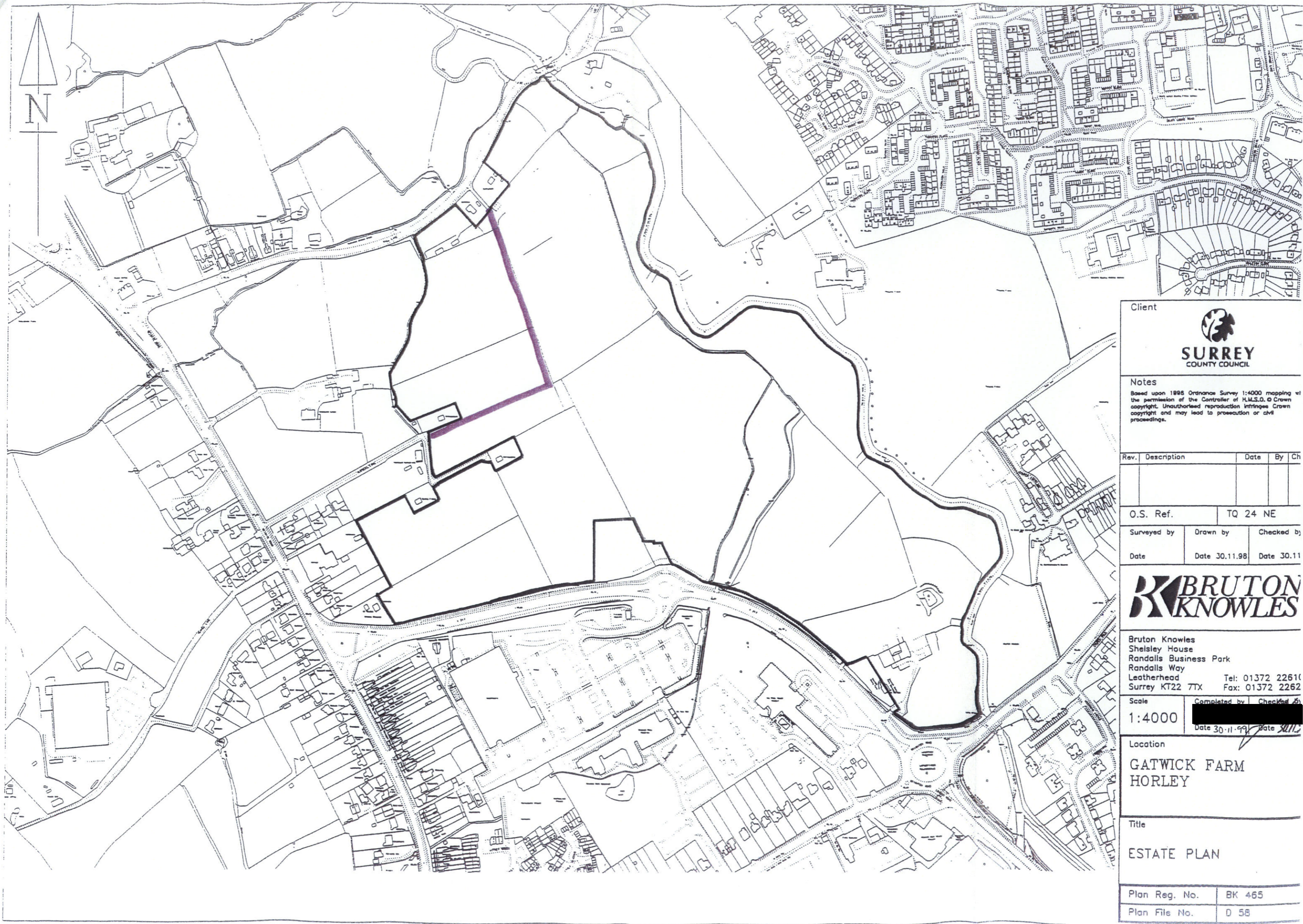

Client

  
**SURREY**  
 COUNTY COUNCIL

Notes

Based upon 1996 Ordnance Survey 1:4000 mapping with the permission of the Controller of H.M.S.O. © Crown copyright. Unauthorised reproduction infringes Crown copyright and may lead to prosecution or civil proceedings.

Rev.	Description	Date	By	Ch

O.S. Ref. TQ 24 NE

Surveyed by	Drawn by	Checked by
Date	Date 30.11.98	Date 30.11

  
**BRUTON**  
**KNOWLES**

Bruton Knowles  
 Shelsley House  
 Randalls Business Park  
 Randalls Way  
 Leatherhead Surrey KT22 7TX  
 Tel: 01372 22610  
 Fax: 01372 22622

Scale	Completed by	Checked by
1:4000		
	Date 30.11.99	Date 30.11.99

Location

**GATWICK FARM**  
**HORLEY**

Title

**ESTATE PLAN**

Plan Reg. No.	BK 465
Plan File No.	D 58



Client

**SURREY**  
COUNTY COUNCIL

Notes  
Based upon 1998 Ordnance Survey 1:2500 mapping with the permission of the Controller of H.M.S.O. © Crown copyright. Unauthorised reproduction infringes Crown copyright and may lead to prosecution or civil proceedings.

Rev.	Description	Date	By	Chk'd

O.S. Ref. SU 8246

Surveyed by	Drawn by	Checked by
Date	S.L. Hempton Date 08.12.98	[Redacted] Date 08.12.98

**BRUTON KNOWLES**

Bruton Knowles  
Shelsley House  
Randalls Business Park  
Randalls Way  
Leatherhead Surrey KT22 7TX  
Tel: 01372 226100  
Fax: 01372 226200

Scale 1:5000 by [Redacted]  
Date 2.06.99 Date 17.11.99

Location  
**COXBRIDGE FARM  
FARNHAM**

Title  
**ESTATE PLAN**

Plan Reg. No.	BK 463
Plan File No.	D 54

KEY	
[Hatched Box]	K Kenward
[Hatched Box]	Grazing



Client

**SURREY COUNTY COUNCIL**

Notes  
Based upon 1998 Ordnance Survey 1:2500 mapping with the permission of the Controller of H.M.S.O. © Crown copyright. Unauthorised reproduction infringes Crown copyright and may lead to prosecution or civil proceedings.

Rev.	Description	Date	By	Chk'd

O.S. Ref. TQ 24 SE

Surveyed by [redacted] Drawn by S. C. Hempton Checked by [redacted]  
Date [redacted] Date 30.11.98 Date 30.11.98

**BRUTON KNOWLES**

Bruton Knowles  
Shelsley House  
Randalls Business Park  
Randalls Way  
Leatherhead Surrey KT22 7TX  
Tel: 01372 226100 Fax: 01372 226200

Scale 1:2500  
Created by [redacted] Checked by [redacted]  
Date 31-08-99 Date 17/11/99

Location  
**BAYHORNE FARM HORLEY**

Title  
**ESTATE PLAN**

Plan Reg. No.	BK 464
Plan File No.	D 56



This is the Exhibit marked "IVC2" referred to in the Declaration of Ian Vernon Cresswell.

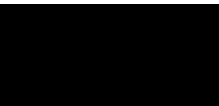

Declared before me  ROSANNA LEIST  
This 16<sup>th</sup> day of August in the year 2010.

**W H Matthews & Co**  
19 Penryhn Road  
Kingston upon Thames  
Surrey KT1 2BZ

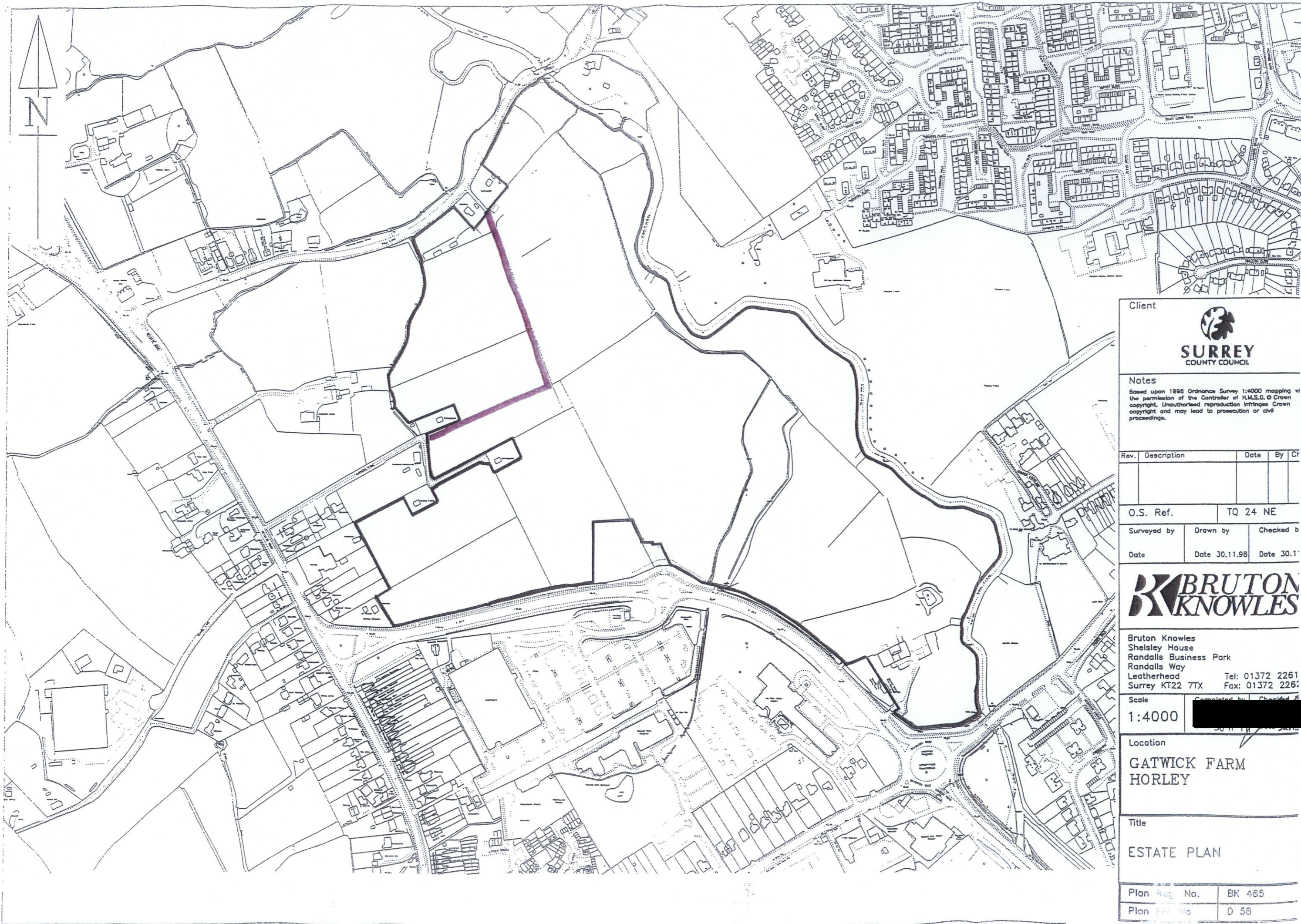

Client



**SURREY**  
COUNTY COUNCIL

Notes

Based upon 1995 Ordnance Survey 1:4000 mapping of the permission of the Controller of H.M.S.O. © Crown copyright. Unauthorised reproduction infringes Crown copyright and may lead to prosecution or civil proceedings.

Rev.	Description	Date	By	Cl

O.S. Ref.      TQ 24 NE

Surveyed by	Drawn by	Checked by

Date      Date 30.11.98      Date 30.11.98



**BRUTON**  
**KNOWLES**

Bruton Knowles  
Shelsley House  
Randalls Business Park  
Randalls Way  
Leatherhead      Tel: 01372 2261  
Surrey KT22 7TX      Fax: 01372 2262

Scale      1:4000

Location

**GATWICK FARM**  
**HORLEY**

Title

**ESTATE PLAN**

Plan Reg. No.	BK 465
Plan Ref. No.	D 58



Client

  
**SURREY**  
 COUNTY COUNCIL

Notes  
 Based upon 1998 Ordnance Survey 1:2500 mapping with the permission of the Controller of H.M.S.O. © Crown copyright. Unauthorised reproduction infringes Crown copyright and may lead to prosecution or civil proceedings.

Rev.	Description	Date	By	Chk'd

O.S. Ref. SU 8246

Surveyed by	Drawn by	Checked by
Date	S.L. Hempton	[Redacted]
	Date 08.12.98	Date 08.12.98

  
**BRUTON**  
**KNOWLES**

Bruton Knowles  
 Shelsley House  
 Randalls Business Park  
 Randalls Way  
 Leatherhead Surrey KT22 7TX  
 Tel: 01372 226100  
 Fax: 01372 226200

Scale  
 1:5000 [Redacted]

Location  
 COXBRIDGE FARM  
 FARNHAM

Title  
 ESTATE PLAN

Plan Reg. No.	BK 463
Plan File No.	D 54

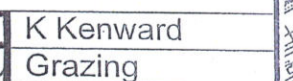
KEY	
	K Kenward
	Grazing

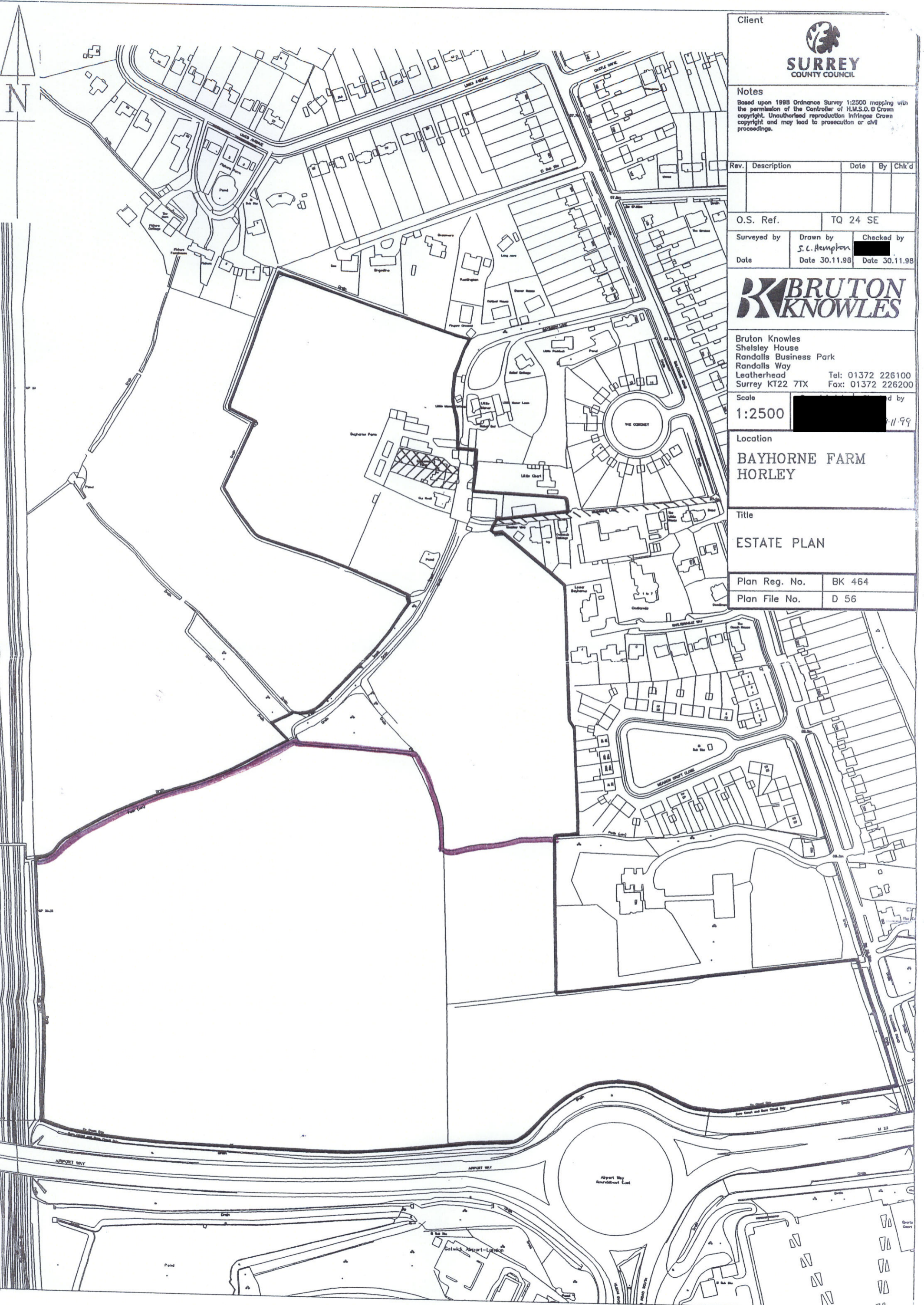

Client

**SURREY COUNTY COUNCIL**

Notes  
Based upon 1998 Ordnance Survey 1:2500 mapping with the permission of the Controller of H.M.S.O. © Crown copyright. Unauthorised reproduction infringes Crown copyright and may lead to prosecution or civil proceedings.

Rev.	Description	Date	By	Chk'd

O.S. Ref. TQ 24 SE

Surveyed by	Drawn by	Checked by
	S. C. Hempton	
Date	Date 30.11.98	Date 30.11.98

**BRUTON KNOWLES**

Bruton Knowles  
Shelsley House  
Randalls Business Park  
Randalls Way  
Leatherhead Surrey KT22 7TX  
Tel: 01372 226100  
Fax: 01372 226200

Scale 1:2500

Location  
**BAYHORNE FARM  
HORLEY**

Title  
**ESTATE PLAN**

Plan Reg. No.	BK 464
Plan File No.	D 56



Based upon the Ordnance Survey mapping with the permission of the Controller of H.M.S.O. © Crown Copyright. Unauthorised reproduction infringes Crown Copyright and may lead to prosecution or civil proceedings. Surrey County Council LA 076872 1996.

Notes  
 1. Computer file number: H:\CMU\Survey\acad drawings CM885

Rev.	Description	Date	By	Chk'd
------	-------------	------	----	-------

  
**SURREY**  
 COUNTY COUNCIL  
 Construction Management Unit, County Hall,  
 Penryhn Road, Kingston upon Thames, Surrey, KT1 2DN.  
 Tel : 020 8541 9231

O.S. Ref.	SU 9440 NE/9441 SE
-----------	--------------------

Scale	1:5000
-------	--------

Surveyed by	Drwn by	Checked by
	SLH	KBD
Date	Date 12.10.05	Date 12.10.05

Location  
**LEIGH PLACE ESTATE**  
**LEIGH**

Title  
**ESTATE PLAN**

Plan Reg. No.	CM 885
Plan File No.	D 23