

DEPOSIT OF STATEMENT and PLAN
SECTION 31(6) OF THE HIGHWAYS ACT 1980

To Surrey County Council:

- 1 The applicant is and has been since October 1930 the owner within the meaning of the above section of the land known as Bayhorne Farm, Balcombe Road, Horley more particularly delineated on the plan accompanying this statement and thereon edged black.
- 2 The aforementioned land lies in the Parish/Community of Horley.
- 3 The ways coloured purple on the said plan have been dedicated as public footpaths.
- 4 In accordance with the provisions of Section 31 of the Highways Act 1980, the applicant declares that there are no other public rights of way of any sort over the aforesaid land nor does it recognise any other such public right of way whatsoever.
- 5 The deposit shall comprise this statement and accompanying plan.

Signed on behalf the landowner ..



Name of signatory ..

I.V. CRESSWELL

Status of signatory ..

DELIVERY MANAGER - EPM

Name of landowner

Surrey County Council

Address

County Hall
Kingston upon Thames
KT1 2DN

Date ..

21/6/2010

Signed witness ..



Name of witness ..

ADRIAN SANCRIFT

Status of signatory ..

ESTATES SURVEYOR

Address ..

COUNTY HALL
KINGSTON UPON THAMES
KT1 2DN

Occupation ..

CHARTERED SURVEYOR

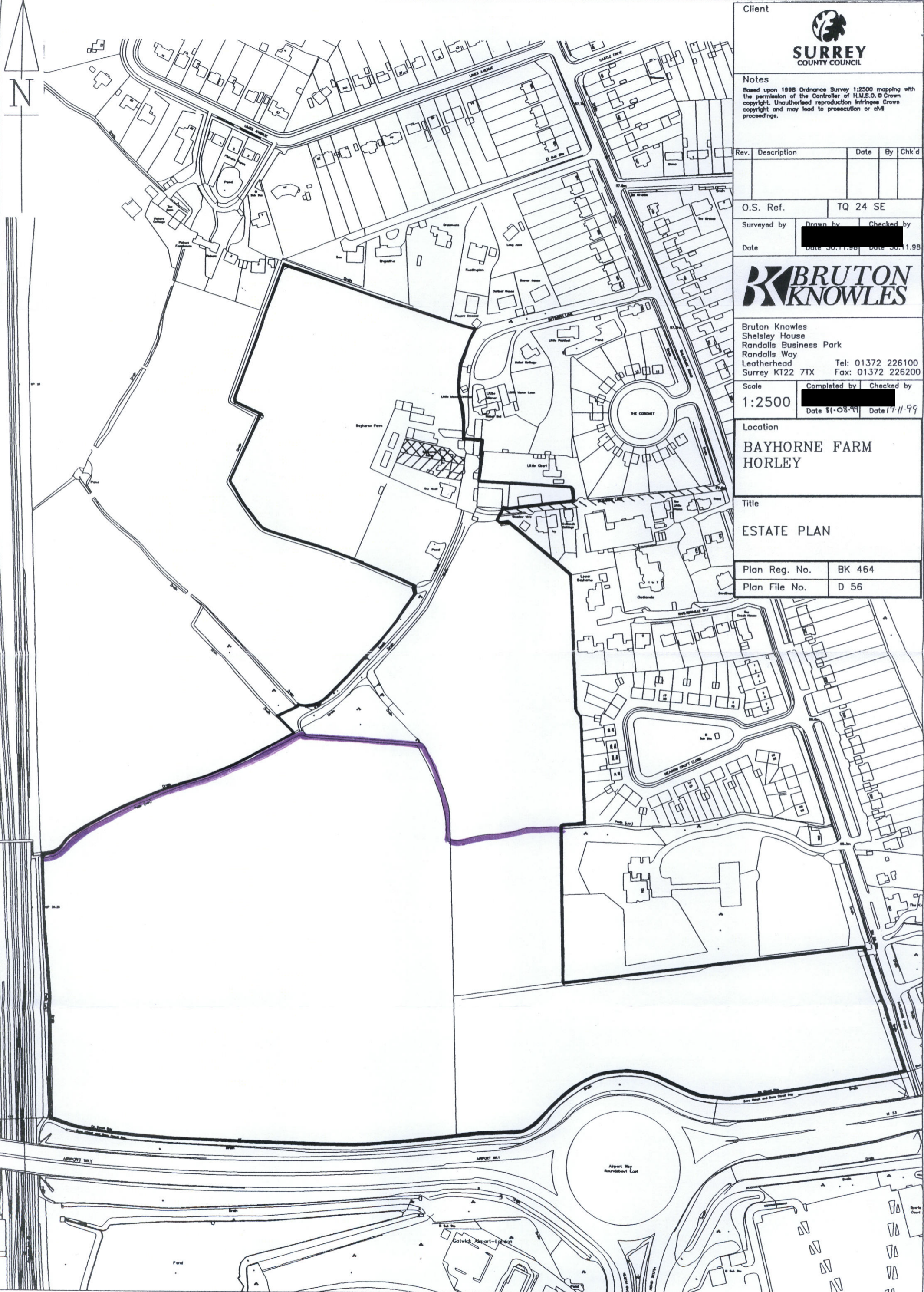

Client

SURREY COUNTY COUNCIL

Notes
Based upon 1988 Ordnance Survey 1:2500 mapping with the permission of the Controller of H.M.S.O. © Crown copyright. Unauthorised reproduction infringes Crown copyright and may lead to prosecution or civil proceedings.

Rev.	Description	Date	By	Chk'd

O.S. Ref. TQ 24 SE

Surveyed by [redacted] Drawn by [redacted] Checked by [redacted]

Date [redacted] Date 30.11.98 Date 30.11.98

BRUTON KNOWLES

Bruton Knowles
Shelsley House
Randalls Business Park
Randalls Way
Leatherhead Surrey KT22 7TX
Tel: 01372 226100
Fax: 01372 226200

Scale 1:2500
Completed by [redacted] Checked by [redacted]

Date 11.08.99 Date 11.11.99

Location
**BAYHORNE FARM
HORLEY**

Title
ESTATE PLAN

Plan Reg. No.	BK 464
Plan File No.	D 56

DEPOSIT OF STATEMENT and PLAN
SECTION 31(6) OF THE HIGHWAYS ACT 1980

To Surrey County Council:

- 1 The applicant is and has been since October 1930 the owner within the meaning of the above section of the land known as Bayhorne Farm, Balcombe Road, Horley more particularly delineated on the plan accompanying this statement and thereon edged black.
- 2 The aforementioned land lies in the Parish/Community of Horley.
- 3 The ways coloured purple on the said plan have been dedicated as public footpaths.
- 4 In accordance with the provisions of Section 31 of the Highways Act 1980, the applicant declares that there are no other public rights of way of any sort over the aforesaid land nor does it recognise any other such public right of way whatsoever.
- 5 The deposit shall comprise this statement and accompanying plan.

Signed on behalf the landowner

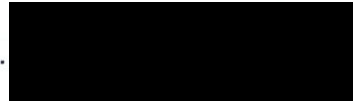

Name of signatory

T. V. CRESSWELL

Status of signatory

DELIVERY MANAGER - EPM

Name of landowner

Surrey County Council

Address

County Hall
Kingston upon Thames
KT1 2DN

Date

14/6/2010.

Signed witness

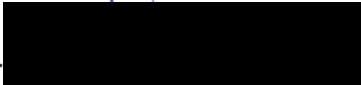

Name of witness

ADRIAN SANCRIFT

Status of signatory

ESTATES SURVEYOR

Address

*COUNTY HALL
KINGSTON UPON THAMES
KT1 2DN*

Occupation

CHARTERED SURVEYOR



Client

SURREY COUNTY COUNCIL

Notes
Based upon 1988 Ordnance Survey 1:2500 mapping with the permission of the Controller of H.M.S.O. © Crown copyright. Unauthorised reproduction infringes Crown copyright and may lead to prosecution or civil proceedings.

Rev.	Description	Date	By	Chk'd

O.S. Ref. TQ 24 SE

Surveyed by [redacted] Drawn by [redacted] Checked by [redacted]

Date Date 30.11.98 Date 30.11.98

BRUTON KNOWLES

Bruton Knowles
Shelsley House
Randalls Business Park
Randalls Way
Leatherhead Surrey KT22 7TX
Tel: 01372 226100
Fax: 01372 226200

Scale 1:2500 Completed by [redacted] Checked by [redacted]

Date 11-08-99 Date 11-11-99

Location
**BAYHORNE FARM
HORLEY**

Title
ESTATE PLAN

Plan Reg. No.	BK 464
Plan File No.	D 56