

Mr. & Mrs. M. E. Philps
Woodside Cottage
Hatchford Wood
Hatchford Park
Cobham, Surrey

Date:

The Secretary & Solicitors Dept.
Surrey County Council,
County Hall,
Kingston upon Thames,
Surrey KT1 2DN

Dear Sir,

Rights of way - land at Hatchford Wood Ockham Lane Cobham Surrey

We, Michael Edward Philps and Barbara Jean Philps of Woodside Cottage Hatchford Wood Hatchford Park Cobham Surrey, do solemnly and sincerely Declare as follows :-

1. We are the owners of the property and buildings on the north east side of Old Lane and the north west side of Ockham Lane and Hatchford Wood Hatchford Park Cobham Surrey which is coloured pink on the attached plan marked "MEP 1"
2. This Declaration is made in accordance with the provisions of Section 31 of The Highways Act 1980 that we have not dedicated nor shall dedicate any part of the said land as a public highway
3. In accordance with the provisions of Section 31 of The Highways Act 1980 we Declare that there are no other public rights of way of any sort over the aforesaid land nor do we recognise any other such public right of way whatsoever
4. That we have not knowingly permitted trespass on the said land coloured pink
5. That to the best of our knowledge and belief the previous owners of the land coloured pink R. A. Behrman and G. H. Kahan neither dedicated any part thereof for use by the public or knowingly permitted trespass thereon

Yours faithfully,

Michael Edward Philps

Barbara Jean Philps

Hatchford Wood

110
110
110
110
110

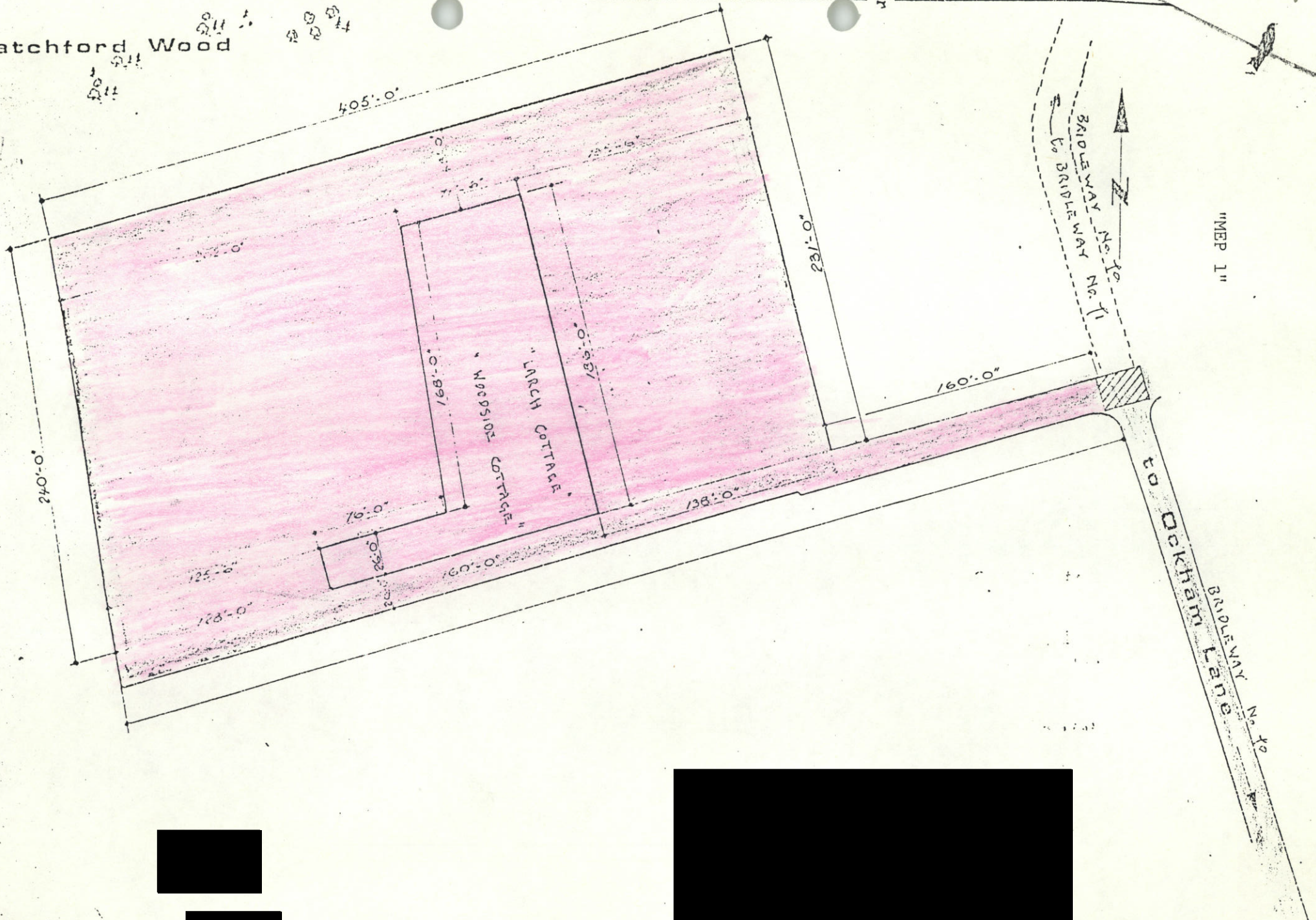

"MAP 1"

Scale
1:200

