

**DEPOSIT OF STATEMENT and PLAN
SECTION 31(6) OF THE HIGHWAYS ACT 1980**

To: Surrey County Council
Countryside Legal
Room 365a County Hall
Penrhyn Road
Kingston-upon-Thames KT1 2DY

1. I am and have been since 10 August 2009 the co-owner, along with Nicola Jane Kentish-Barnes, as trustees for the BAFCOL Trust, within the meaning of the above Section, of the land known as land on the south side of New Road, Windlesham, Surrey (registered under H.M. Land Registry freehold Title Number SY405556) more particularly delineated on the plan marked 'Plan 1' accompanying this statement and thereon edged in red.
2. The aforementioned land lies in the Parish of Windlesham Parish Council.
3. Upon a separate plan of my abovementioned land accompanying this statement marked 'Plan 2', and prepared by Surrey County Council, there is marked in blue a path running through points A, B, C, F and E for which Nicola Jane Kentish-Barnes and I hereby give temporary consent to members of the public to walk over for a maximum period of 12 months from the date of this statement. However, this path is not being dedicated to the public at large to use.
4. In accordance with the provisions of Section 31 of the Highways Act 1980, I declare that there are no other public rights of way of any sort over the aforesaid land nor do I recognise any other such public right of way whatsoever.
5. The deposit shall comprise this statement and accompanying plans marked 'Plan 1' and 'Plan 2'.

Signed (landowner) 
Mr Peter John Fane

Name of landowners: Mr Peter John Fane and Nicola Jane Kentish Barnes (as Trustees of the BAFCOL Trust)

Address of landowner: C/O Thomson Snell & Passmore, 3 Lonsdale Gardens, Tunbridge Wells, TN1 1NX

Date: 04-05-2010

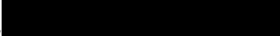
Signed (witness): 

Address (of witness): 16, May Close Heath Park
Owlsmoor Sandhurst Berks. GULF 7 0UG

Occupation (of witness): Administrator

H.M. LAND REGISTRY

SY405556

ORDNANCE SURVEY
PLAN REFERENCE

COUNTY

SHEET

NATIONAL GRID

SUBSILY

KJA

Scale: 1:2500

SURREY HEATH DISTRICT

© Crown Copyright

NOTE: AREAS ON THIS PLAN ARE EXPRESSED
IN ACRES AND HECTARES:

The boundaries shown by
dotted lines have been plotted
from the transfer plan and are
subject to revision on survey.

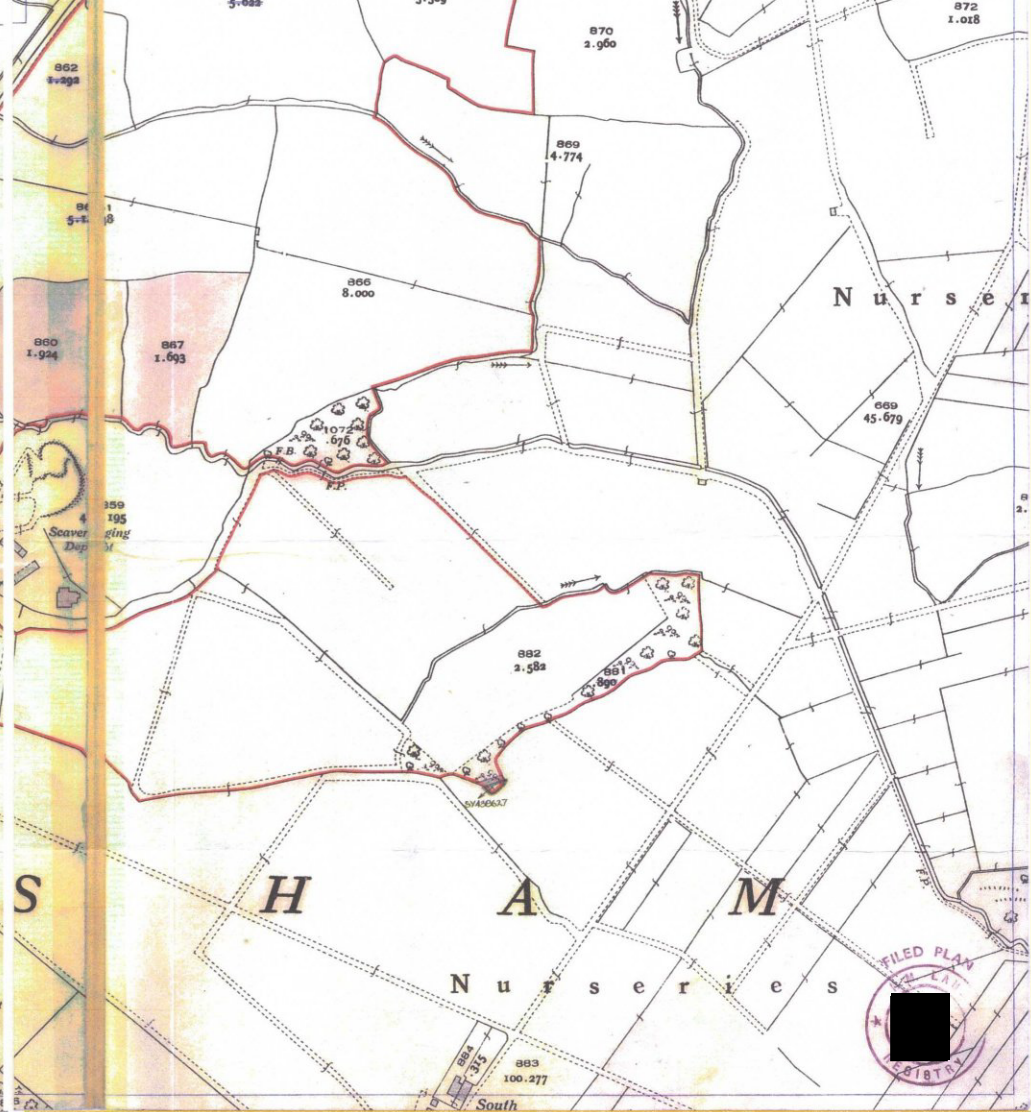
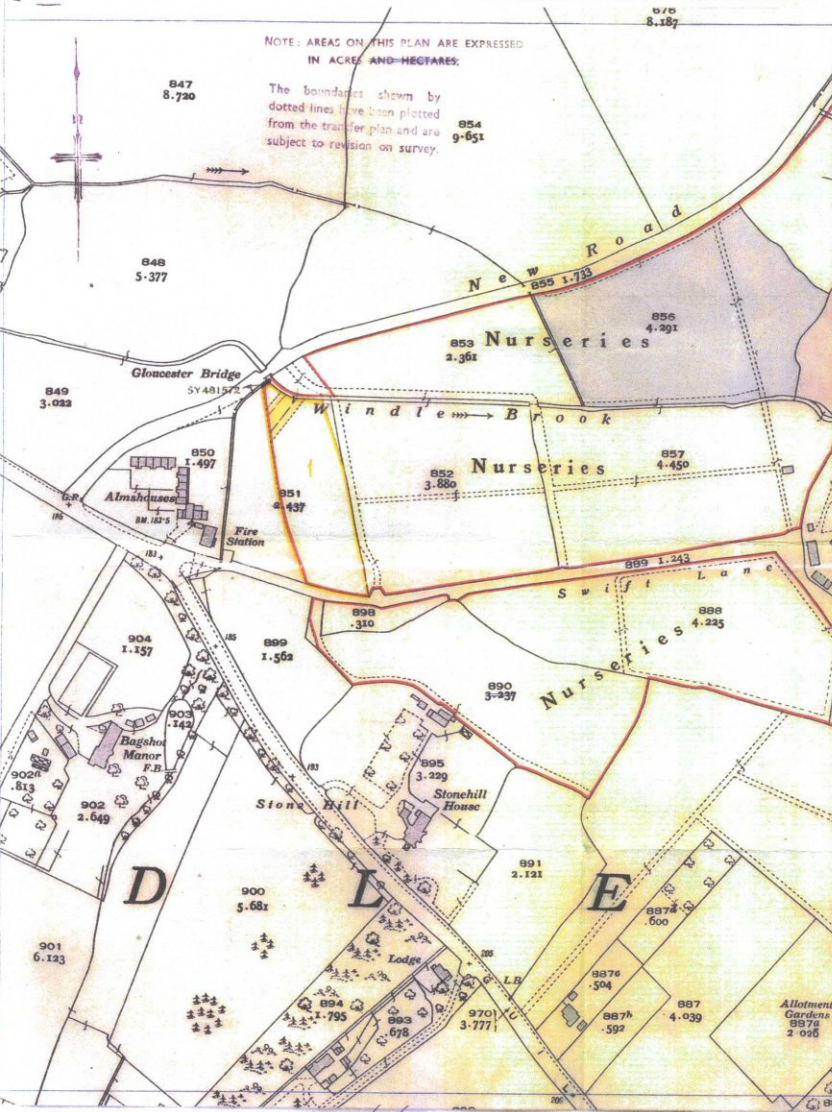

FILED PLAN
[Redacted]
1987

This official copy issued on 29/5/2009 shows the state of this title plan on 29/5/2009 at 00:00:00. It is admissible in evidence to the same extent as the original (s.67 Land Registration Act 2002). This title plan shows the general position, not the exact line, of the boundaries. It may be subject to distortions in scale. Measurements scaled from this plan may not match measurements between the same points on the ground. See Land Registry Public Guide 7 - Title Plans. This title is dealt with by Land Registry, Durham Boldon Office. © Crown Copyright. Produced by Land Registry. Reproduction in whole or part is prohibited

'Plan 2'

492510,163353



FP 64 Windlesham



Scale 1:2500

Date: 10/11/2009

Printed by:

Drawing No.:

© Crown Copyright Licence No. 100019613,
Surrey County Council, 2006. Except A-Z
mapping © Copyright of the Publishers
Geographers' A-Z Map Company Ltd.

