

Tel. 0252 28578

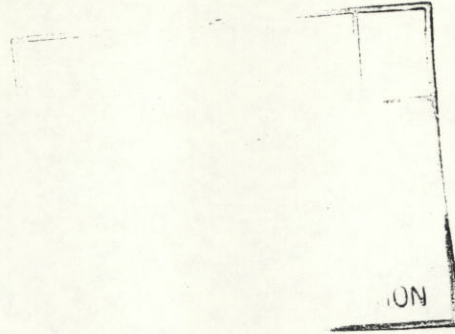

D. W. Swabey,
90 Manor Road,
Ash,
Aldershot,
Hants.,
GU12 6QD

29th Sept 1993

Dear Sir,

Land bounded by Guildford Road & Pirbright Road,
Normandy.

I have been advised to write informing you that the paths within the area bounded red on the enclosed map are on private property and are not public rights of way.

Yours faithfully,



Kand's Plantation

THE REGISTERED LAND CONSISTING OF THE PARTS OR PARTS ENDED WITH A THICK LINE REPRESENTING THE RED EDGING ON THE FILED PLAN IS MORE PARTICULARLY DESCRIBED IN THE PROPERTY REGISTER. IF THE THICK LINE ENCLOSES ANY NUMBERED PARTS BEARING LETTERED PREFIXES, THEN THOSE PARTS HAVE BEEN REMOVED FROM THE TITLE.

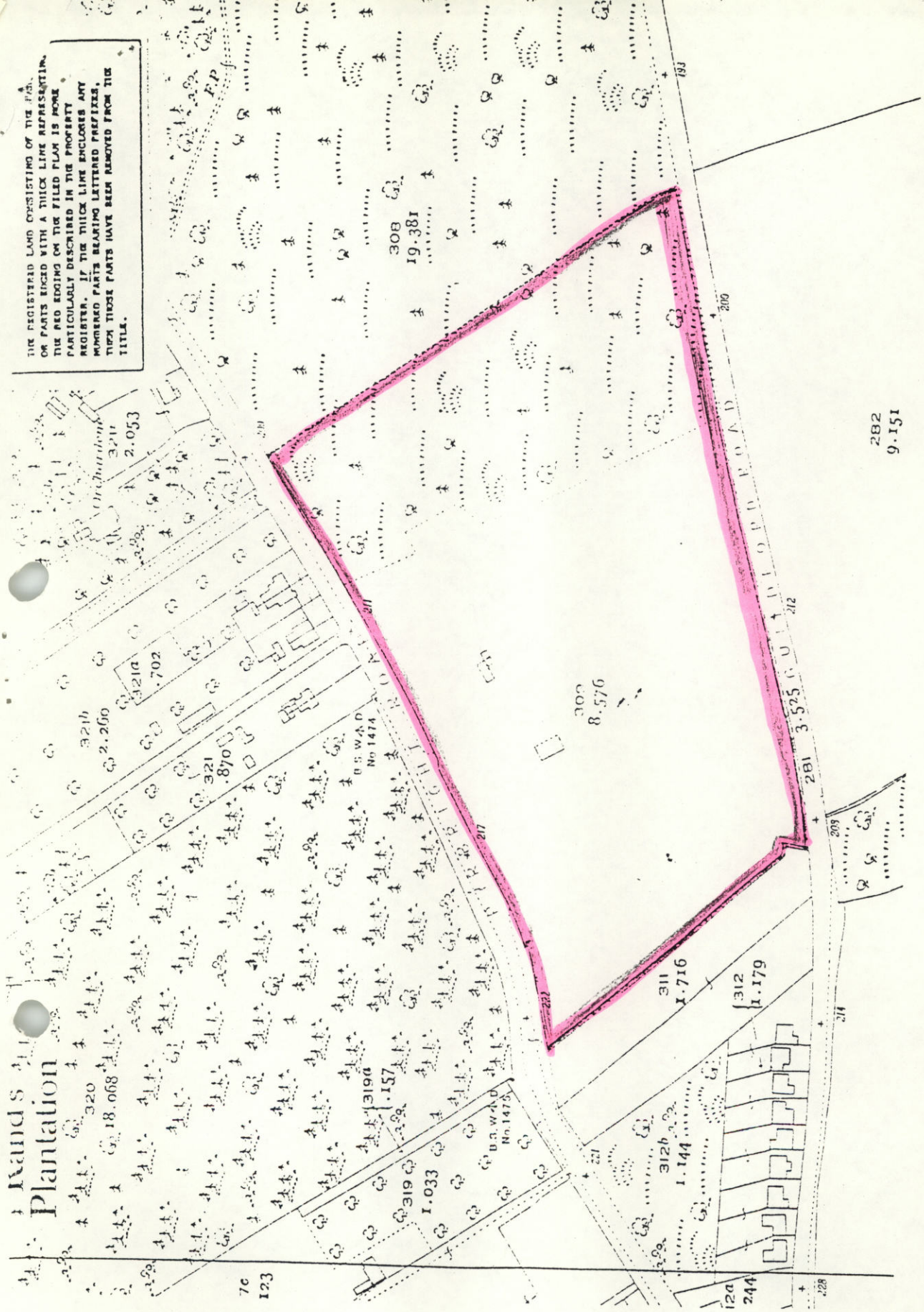

282
9.151