

DEPOSIT OF STATEMENT AND MAP

SECTION 31 (6) OF THE HIGHWAYS ACT 1980

To Surrey County Council

1. I am and have been since 31st December 1991 the owner (together with Mary Helen Baker, Katherine Margaret Goode and Victoria Mary Pattinson) within the meaning of the above section of the land known as Coneycroft, Milford, Godalming, Surrey, more particularly delineated on the map accompanying this statement and thereon edged red.
2. The aforementioned land lies in the Parishes/Communities of Milford.
3. No ways over the land have been dedicated as highways.
4. The deposit shall comprise this statement and accompanying map.

Signed

Name

Colin Frederick Baker

Address

Chesil Cottage
Mousehill Lane
Milford
Surrey GU8 5BH

Date

10 March 2010

Signed (witness)

Name (of witness)

Address

Occupation

Brian Walton
14 NOLAN ROAD
PETTITSHAM, HANTS GU32 2AX
book.

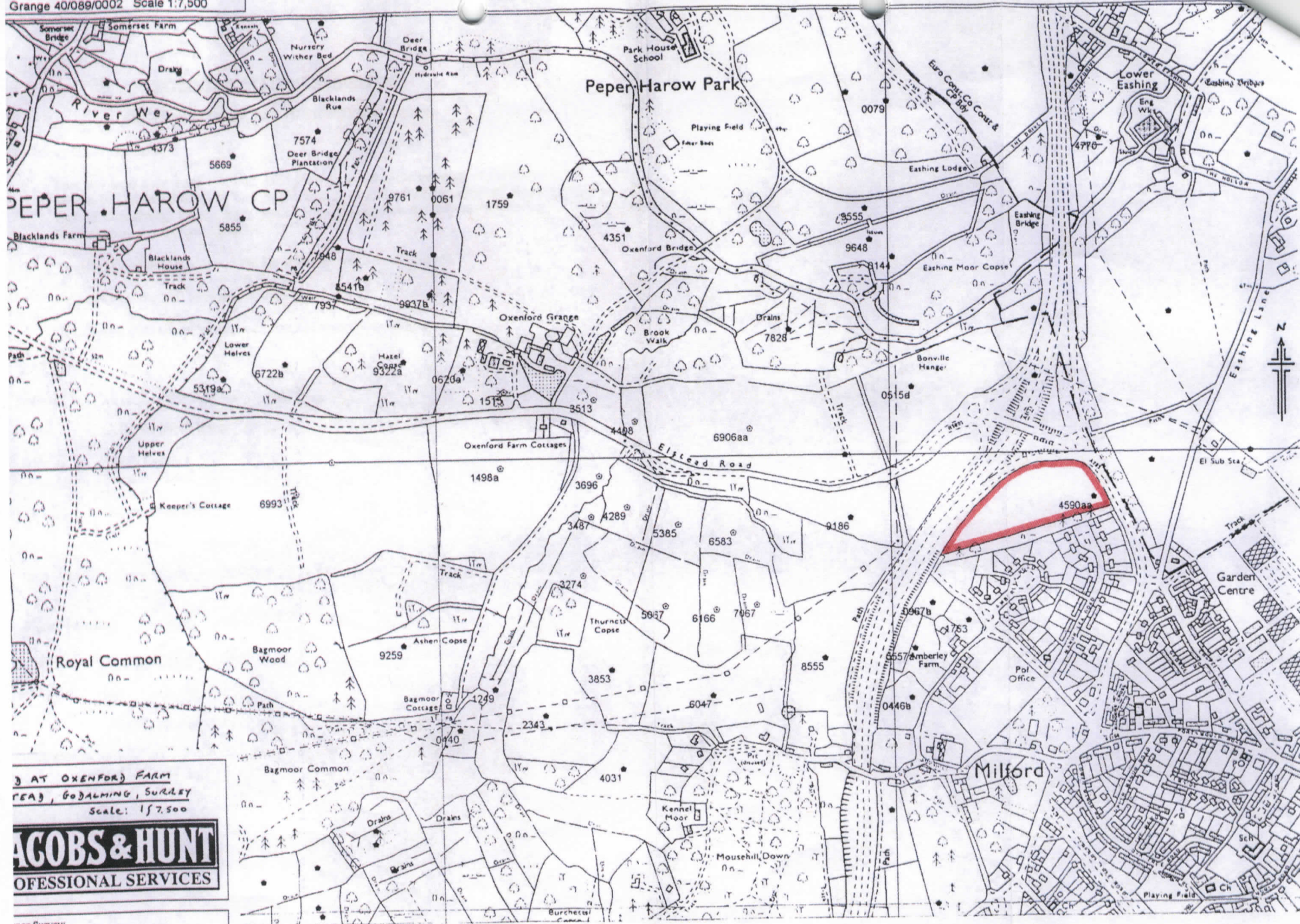

3 AT OXENFORD FARM
PEPER HAROW, GODALMING, SURREY
Scale: 1:7,500

ACOBS & HUNT
PROFESSIONAL SERVICES

Since Survey:
Copyright. All Rights Reserved
No 100004195