

DEPOSIT OF STATEMENT and PLAN
SECTION 31(6) OF THE HIGHWAYS ACT 1980

To Surrey County Council:

- 1 The applicant is and has been since October 1938 the owner within the meaning of the above section of the land known as land at Coxbridge Farm, Farnham, Surrey more particularly delineated on the plan accompanying this statement and thereon edged black and edged black hatched black.
- 2 The aforementioned land lies in the Parish/Community of Farnham.
- 3 The ways coloured purple on the said plan have been dedicated as public footpaths.
- 4 In accordance with the provisions of Section 31 of the Highways Act 1980, the applicant declares that there are no other public rights of way of any sort over the aforesaid land nor does it recognise any other such public right of way whatsoever.
- 5 The deposit shall comprise this statement and accompanying plan.

Signed on behalf the landowner

[REDACTED]

Name of signatory

I V CRESSWELL

Status of signatory

DELIVERY MANAGER - ERM

Name of landowner

Surrey County Council

Address

County Hall
Kingston upon Thames
KT1 2DN

Date

21/6/2010

Signed witness

[REDACTED]

Name of witness

ADRIAN SANCRIFT

Status of signatory

ESTATES SURVEYOR

Address

COUNTY HALL
KINGSTON UPON THAMES
KT1 2DN

Occupation

CHARTERED SURVEYOR

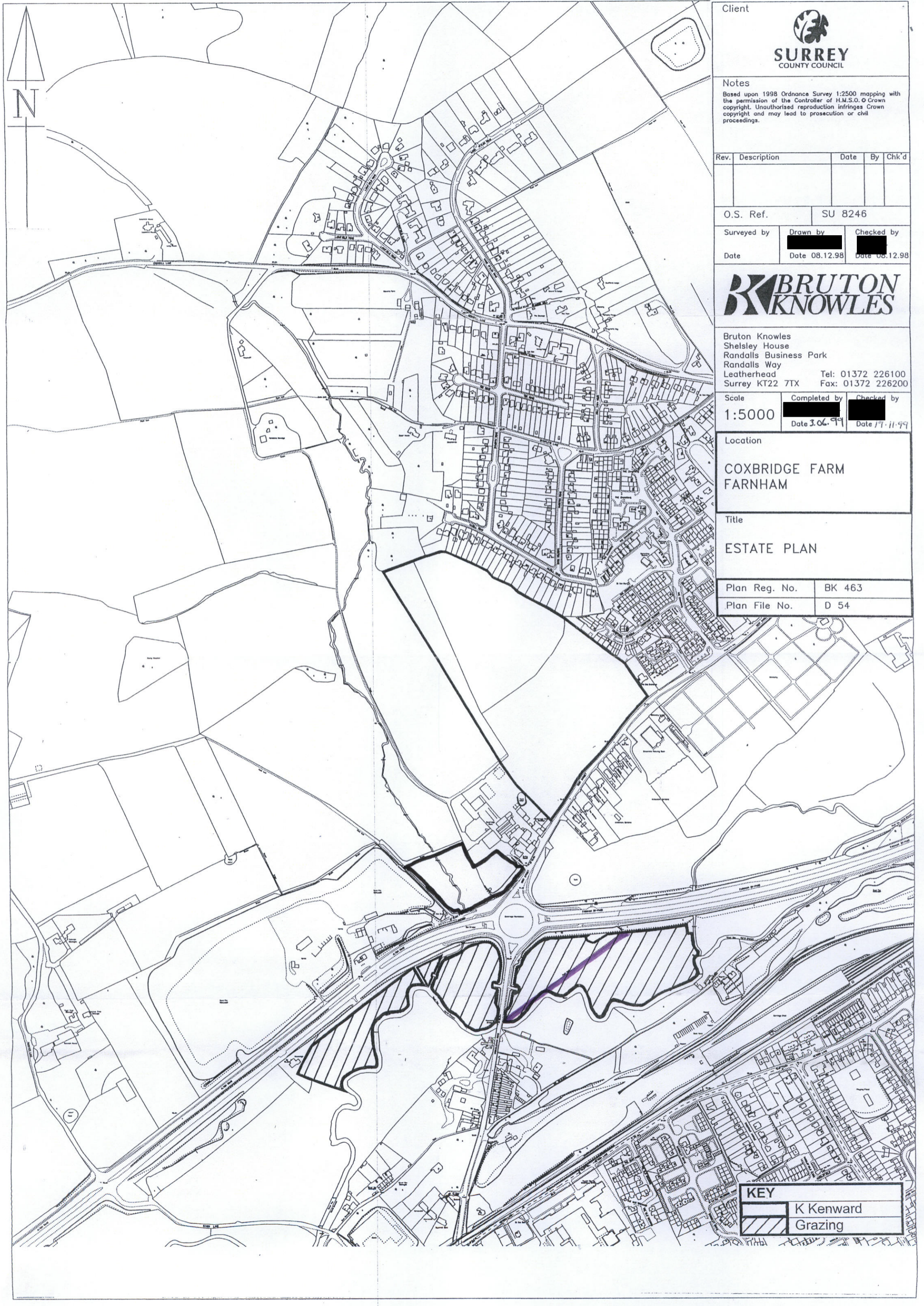

Client

SURREY
COUNTY COUNCIL

Notes
Based upon 1998 Ordnance Survey 1:2500 mapping with the permission of the Controller of H.M.S.O. © Crown copyright. Unauthorised reproduction infringes Crown copyright and may lead to prosecution or civil proceedings.

Rev.	Description	Date	By	Chk'd

O.S. Ref. SU 8246

Surveyed by	Drawn by	Checked by
Date	Date 08.12.98	Date 08.12.98

BRUTON KNOWLES

Bruton Knowles
Shelsley House
Randalls Business Park
Randalls Way
Leatherhead Surrey KT22 7TX
Tel: 01372 226100
Fax: 01372 226200

Scale	Completed by	Checked by
1:5000		
	Date 3.06.99	Date 17.11.99

Location

**COXBRIDGE FARM
FARNHAM**

Title

ESTATE PLAN

Plan Reg. No.	BK 463
Plan File No.	D 54

KEY

	K Kenward
	Grazing

DEPOSIT OF STATEMENT and PLAN
SECTION 31(6) OF THE HIGHWAYS ACT 1980

To Surrey County Council:

- 1 The applicant is and has been since October 1938 the owner within the meaning of the above section of the land known as land at Coxbridge Farm, Farnham, Surrey more particularly delineated on the plan accompanying this statement and thereon edged black and edged black hatched black.
- 2 The aforementioned land lies in the Parish/Community of Farnham.
- 3 The ways coloured purple on the said plan have been dedicated as public footpaths.
- 4 In accordance with the provisions of Section 31 of the Highways Act 1980, the applicant declares that there are no other public rights of way of any sort over the aforesaid land nor does it recognise any other such public right of way whatsoever.
- 5 The deposit shall comprise this statement and accompanying plan.

Signed on behalf the landowner

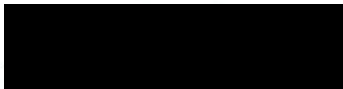

Name of signatory

I V CRESSWELL

Status of signatory

DELIVERY MANAGER - EPM

Name of landowner

Surrey County Council

Address

County Hall
Kingston upon Thames
KT1 2DN

Date

14/6/2010

Signed witness



Name of witness

ADRIAN SANCROFT

Status of signatory

ESTATES SURVEYOR

Address

COUNTY HALL
KINGSTON UPON THAMES
KT1 2DN

Occupation

CHARTERED SURVEYOR

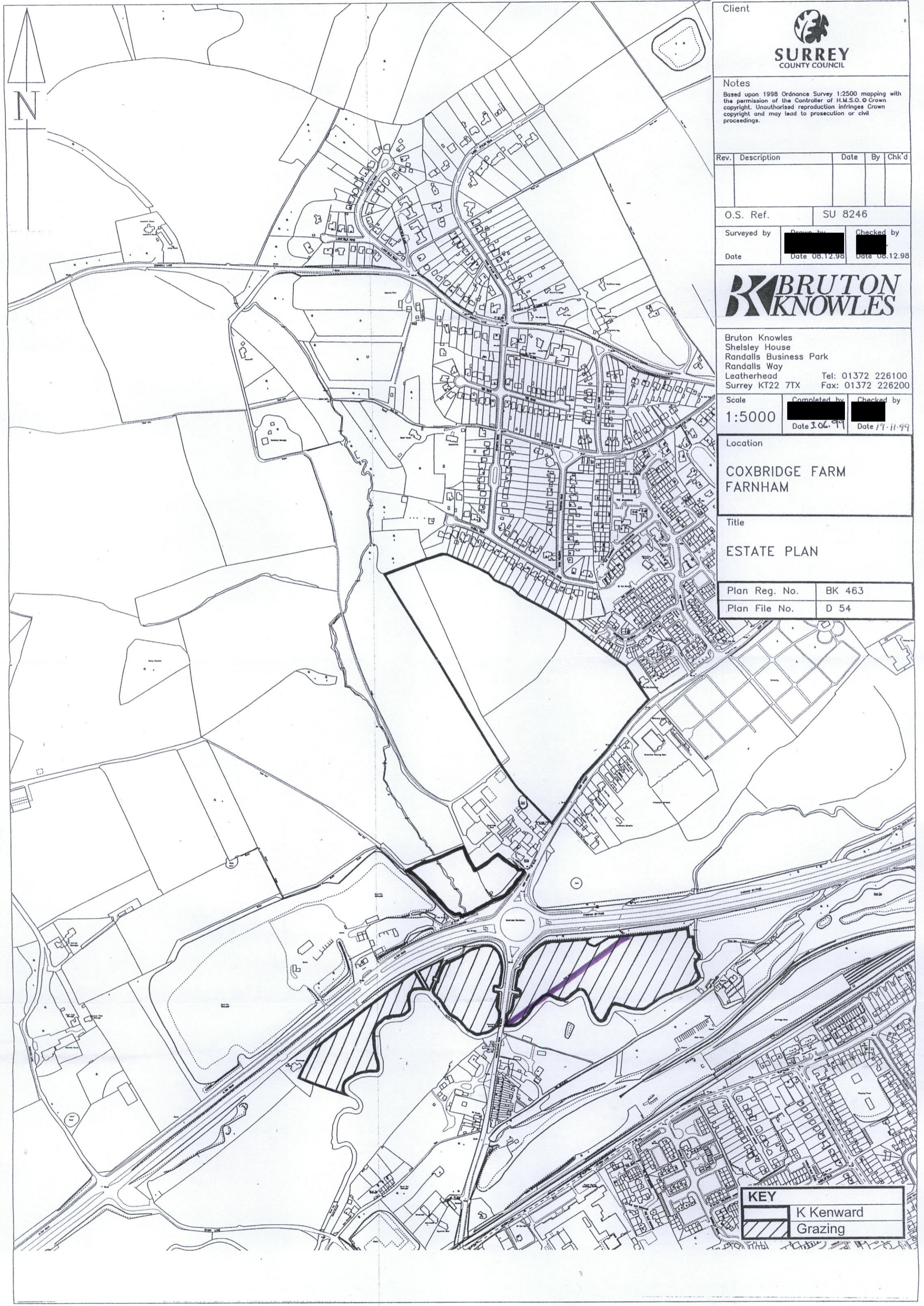

Client

SURREY
 COUNTY COUNCIL

Notes
 Based upon 1998 Ordnance Survey 1:2500 mapping with the permission of the Controller of H.M.S.O. © Crown copyright. Unauthorised reproduction infringes Crown copyright and may lead to prosecution or civil proceedings.

Rev.	Description	Date	By	Chk'd

O.S. Ref. SU 8246

Surveyed by	Drawn by	Checked by
Date	Date 08.12.98	Date 08.12.98

BRUTON KNOWLES

Bruton Knowles
 Shelsley House
 Randalls Business Park
 Randalls Way
 Leatherhead Surrey KT22 7TX
 Tel: 01372 226100
 Fax: 01372 226200

Scale	Completed by	Checked by
1:5000		
	Date 3.06.99	Date 17.11.99

Location

**COXBRIDGE FARM
 FARNHAM**

Title

ESTATE PLAN

Plan Reg. No.	BK 463
Plan File No.	D 54

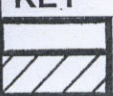
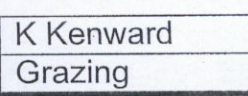
KEY	
	K Kenward
	Grazing

DEPOSIT OF STATEMENT and PLAN
SECTION 31(6) OF THE HIGHWAYS ACT 1980

To Surrey County Council:

- 1 The applicant is and has been since March 1913 the owner within the meaning of the above section of the land known as Gatwick Farm, Hookwood more particularly delineated on the plan accompanying this statement and thereon edged black.
- 2 The aforementioned land lies in the Parish/Community of Hookwood, Horley.
- 3 The ways coloured purple on the said plan have been dedicated as public footpaths.
- 4 In accordance with the provisions of Section 31 of the Highways Act 1980, the applicant declares that there are no other public rights of way of any sort over the aforesaid land nor does it recognise any other such public right of way whatsoever.
- 5 The deposit shall comprise this statement and accompanying plan.

Signed on behalf the landowner

[Redacted Signature]

Name of signatory

J. V. CRESSWELL

Status of signatory

DELIVERY MANAGER - ERM

Name of landowner

Surrey County Council

Address

County Hall
Kingston upon Thames
KT1 2DN

Date

21/6/2010

Signed witness

[Redacted Signature]

Name of witness

ADRIAN SAUCROFT

Status of signatory

ESTATES SURVEYOR

Address

COUNTY HALL
KINGSTON UPON THAMES
KT1 2DN

Occupation

CHARTERED SURVEYOR

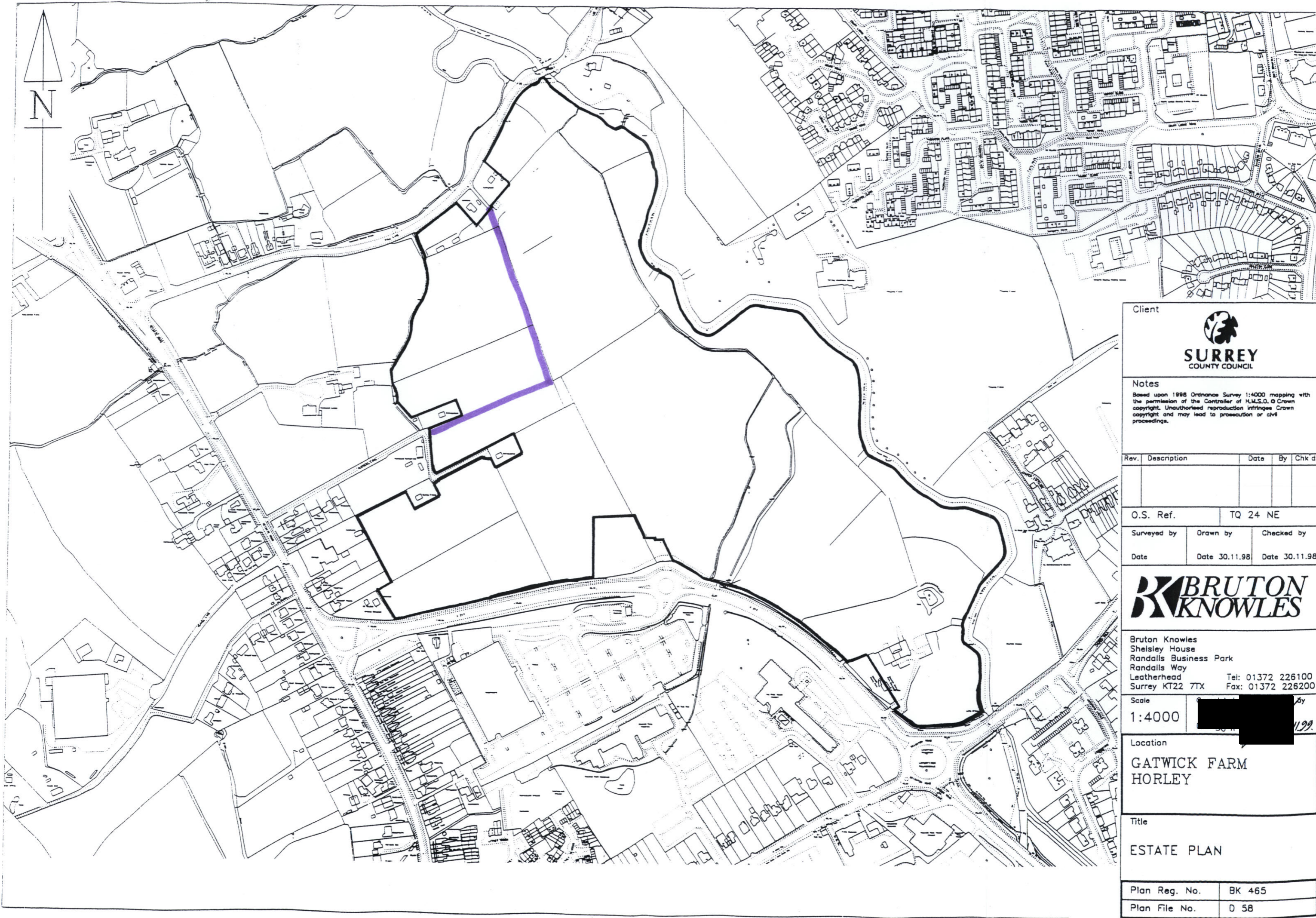

Client



SURREY
COUNTY COUNCIL

Notes

Based upon 1988 Ordnance Survey 1:4000 mapping with the permission of the Controller of H.M.S.O. © Crown copyright. Unauthorised reproduction infringes Crown copyright and may lead to prosecution or civil proceedings.

Rev.	Description	Date	By	Chk d

O.S. Ref. TQ 24 NE

Surveyed by	Drawn by	Checked by
Date	Date 30.11.98	Date 30.11.98



BRUTON
KNOWLES

Bruton Knowles
Shelsley House
Randalls Business Park
Randalls Way
Leatherhead Surrey KT22 7TX
Tel: 01372 226100
Fax: 01372 226200

Scale 1:4000

Location
GATWICK FARM
HORLEY

Title
ESTATE PLAN

Plan Reg. No.	BK 465
Plan File No.	D 58

DEPOSIT OF STATEMENT and PLAN
SECTION 31(6) OF THE HIGHWAYS ACT 1980

To Surrey County Council:

- 1 The applicant is and has been since March 1913 the owner within the meaning of the above section of the land known as Gatwick Farm, Hookwood more particularly delineated on the plan accompanying this statement and thereon edged black.
- 2 The aforementioned land lies in the Paris/Community of Hookwood, Horley.
- 3 The ways coloured purple on the said plan have been dedicated as public footpaths.
- 4 In accordance with the provisions of Section 31 of the Highways Act 1980, the applicant declares that there are no other public rights of way of any sort over the aforesaid land nor does it recognise any other such public right of way whatsoever.
- 5 The deposit shall comprise this statement and accompanying plan.

Signed on behalf the landowner

[Redacted Signature]

Name of signatory

T. V. CRESSWELL

Status of signatory

DELIVERY MANAGER - EPM

Name of landowner

Surrey County Council

Address

County Hall
Kingston upon Thames
KT1 2DN

Date

14/6/2010.

Signed witness

[Redacted Signature]

Name of witness

ADRIAN SANLCROFT

Status of signatory

ESTATES SURVEYOR

Address

COUNTY HALL
KINGSTON UPON THAMES
KT1 2DN

Occupation

CHARTERED SURVEYOR

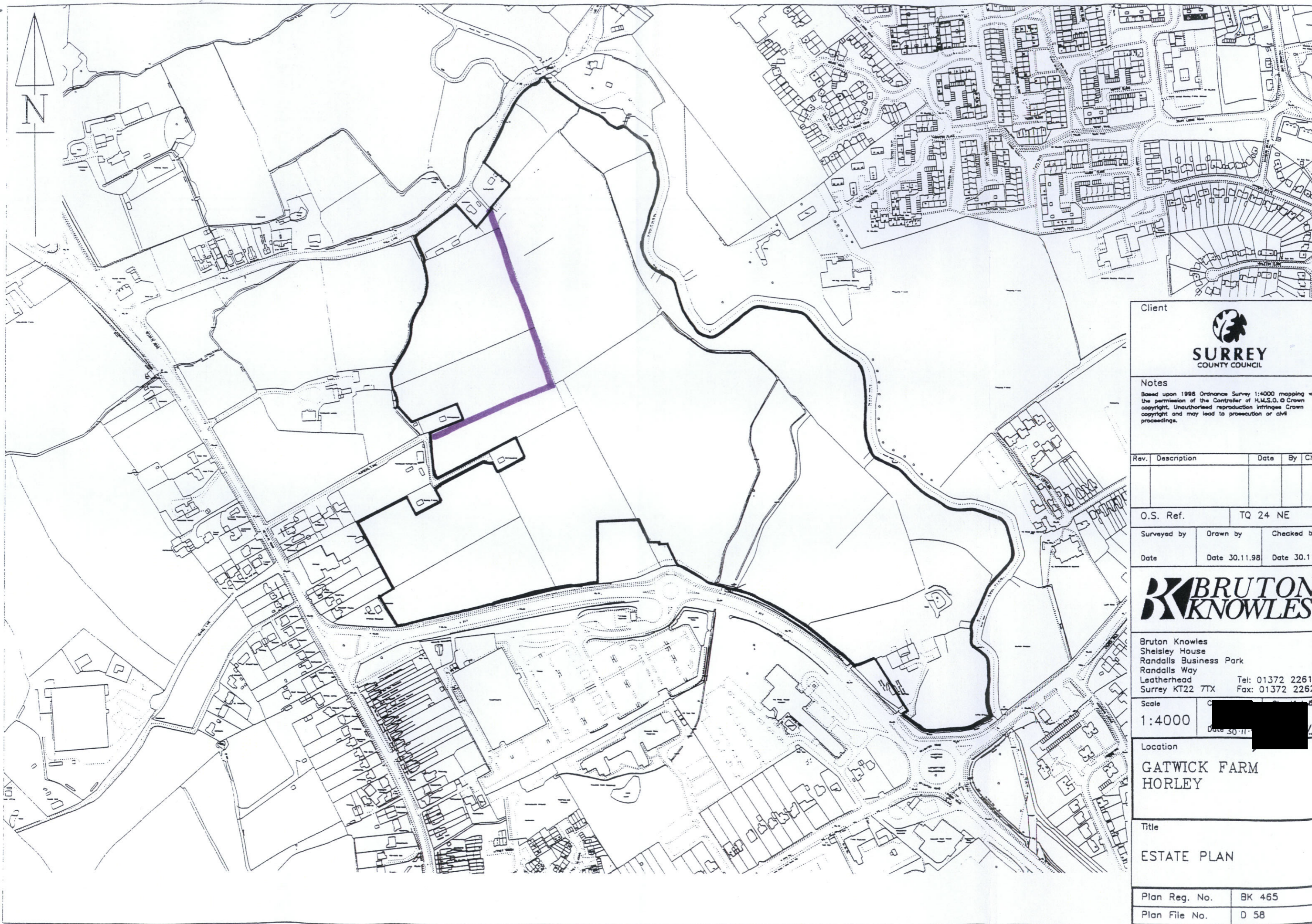

Client



Notes

Based upon 1998 Ordnance Survey 1:4000 mapping with the permission of the Controller of H.M.S.O. © Crown copyright. Unauthorised reproduction infringes Crown copyright and may lead to prosecution or civil proceedings.

Rev.	Description	Date	By	Ch

O.S. Ref. TQ 24 NE

Surveyed by	Drawn by	Checked by
Date	Date 30.11.98	Date 30.11

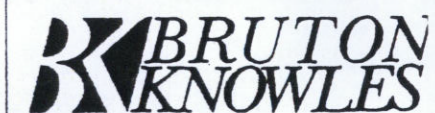

Bruton Knowles
 Sheisley House
 Randalls Business Park
 Randalls Way
 Leatherhead Surrey KT22 7TX
 Tel: 01372 22610
 Fax: 01372 22620

Scale 1:4000
 Date 30.11.98

Location
**GATWICK FARM
 HORLEY**

Title
ESTATE PLAN

Plan Reg. No.	BK 465
Plan File No.	D 58