

STATUTORY DECLARATION

HIGHWAYS ACT 1980 SECTION 31 (6)

I SARAH PRIESTMAN DO SOLEMNLY AND SINCERELY DECLARE as follows:

1. The Woodland Trust, a company limited by guarantee and registered charity no. 294344, is and has been since 4 February 1987 the owner of the land known as Oxmoor Copse, Abinger Hammer, Surrey more particularly delineated on the plan accompanying this declaration and thereon edged red.
2. On the 6 February 1991 the Woodland Trust deposited with Surrey County Council, being the appropriate Council, a statement accompanied by a plan delineating our property by red edging which stated that no ways had been dedicated as highways over our property.
3. On the 4 day of December 1996 my predecessor in title Laura Judson deposited with Surrey County Council, being the appropriate Council, a statutory declaration dated 4 December 1996 stating that that no additional ways had been dedicated since the deposit of the statement referred to in 2 above.
4. No additional ways have been dedicated over the land edged red on the plan accompanying this declaration since the statutory declaration dated 4 December 1996 referred to in 3 above and at the present time the Woodland Trust has no intention of dedicating any more public rights of way over its property.

AND I MAKE this solemn declaration on the 7 day of October 2002 conscientiously believing it to be true and by virtue of the Statutory Declarations Act 1835.

**Declared at:** The Woodland Trust, Autumn Park, Dysart Road, Grantham, Lincolnshire, NG31 6LL.

  
.....  
Sarah Priestman

Trainee Land Agent authorised to sign on behalf of the Woodland Trust

Before me, Nicola Briggs, Solicitor, of Jordans Solicitors, Dewsbury, West Yorkshire

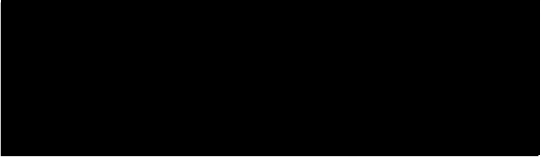

Ordnance Survey  
Superplan Data

Site-centred

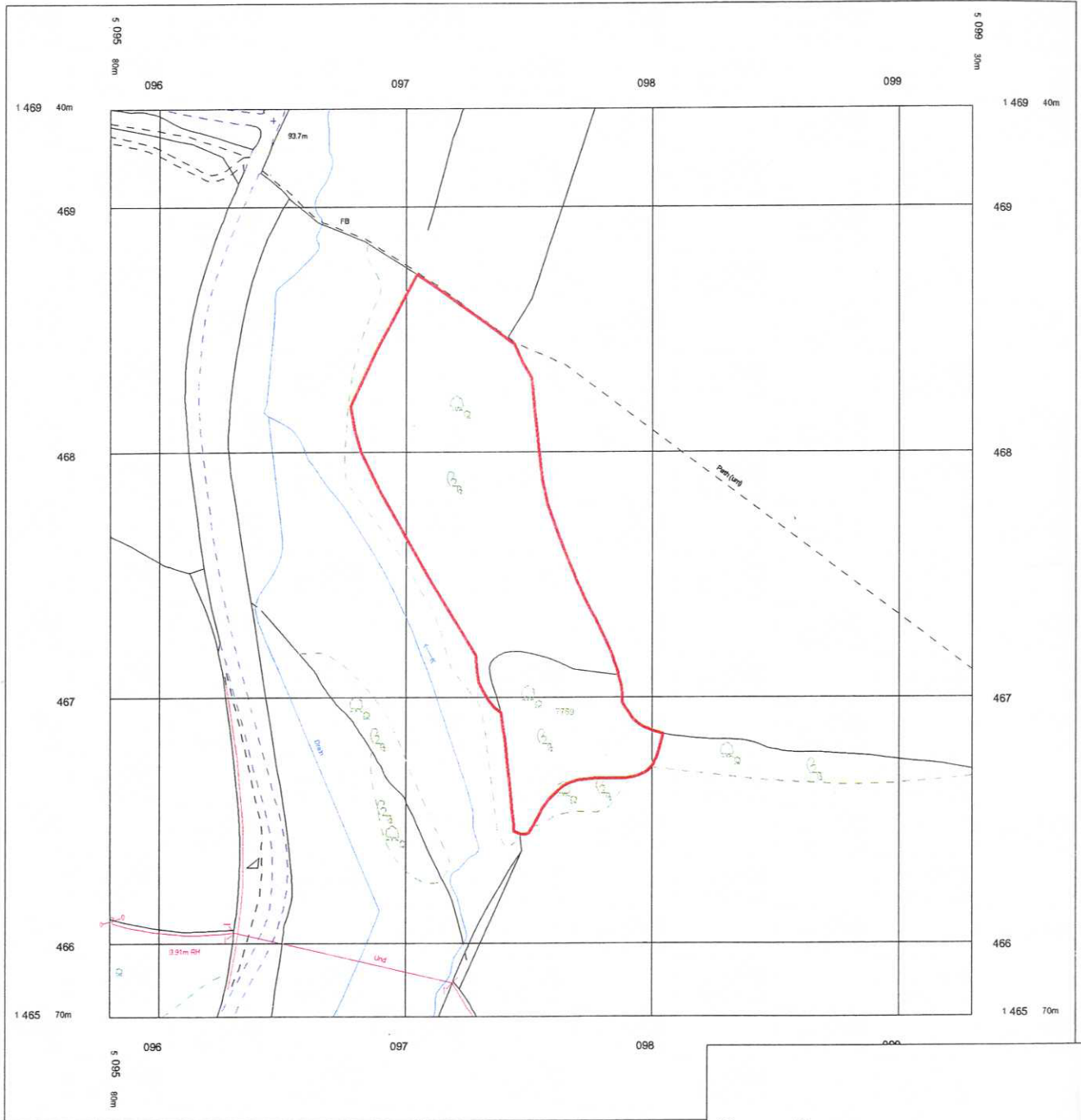

Oxmoor Copse

Produced 28 Jun 2001 from Ordnance Survey digital data and incorporating surveyed revision available at this date. © Crown Copyright

Reproduction in whole or in part is prohibited without the prior permission of Ordnance Survey.

Ordnance Survey and Superplan Data are registered trade marks of Ordnance Survey the national mapping agency of Great Britain

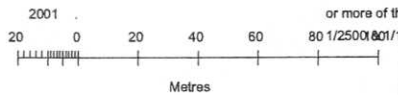

National Grid of this Superplan The representation path is no ex Heights are



Woodland Trust Cost of Map R	[Redacted]
Scale	[Redacted]
Author: SP	
Date: 18/09/2002	
Reproduced from Ordnance Survey ..... digital data © Crown Copyright. AL559385	