

**DEPOSIT OF STATEMENT and PLAN**  
**SECTION 31(6) OF THE HIGHWAYS ACT 1980**

To Surrey County Council:

- 1 The applicant is and has been since April 1974 the owner within the meaning of the above section of the land known as Former Refuse Tip, Broadford Lane, Chobham more particularly delineated on the plan accompanying this statement and thereon edged red.
- 2 The aforementioned land lies in the Parish/Community of Chobham.
- 3 In accordance with the provisions of Section 31 of the Highways Act 1980, the applicant declares that there are no public rights of way of any sort over the aforesaid land nor does it recognise any other such public right of way whatsoever.
- 4 The deposit shall comprise this statement and accompanying plan.

**Signed** on behalf the landowner

.....  .....

**Name** of signatory

..... I. V. CROSSOELL .....

**Status** of signatory

..... AREA DELIVERY MANAGER - EPM .....

**Name** of landowner

Surrey County Council

**Address**

County Hall  
Kingston upon Thames  
KT1 2DN

**Date**

..... 29 DECEMBER 2011 .....

**Signed** witness

.....  .....

**Name** of witness

..... SARAH E. WALKER .....

**Status** of signatory

..... SENIOR ESTATES SURVEYOR - EPM .....

**Address**

..... COUNTY HALL .....

..... KINGSTON UPON THAMES .....

..... KT1 2DN .....

**Occupation**

..... CHARTERED SURVEYOR .....

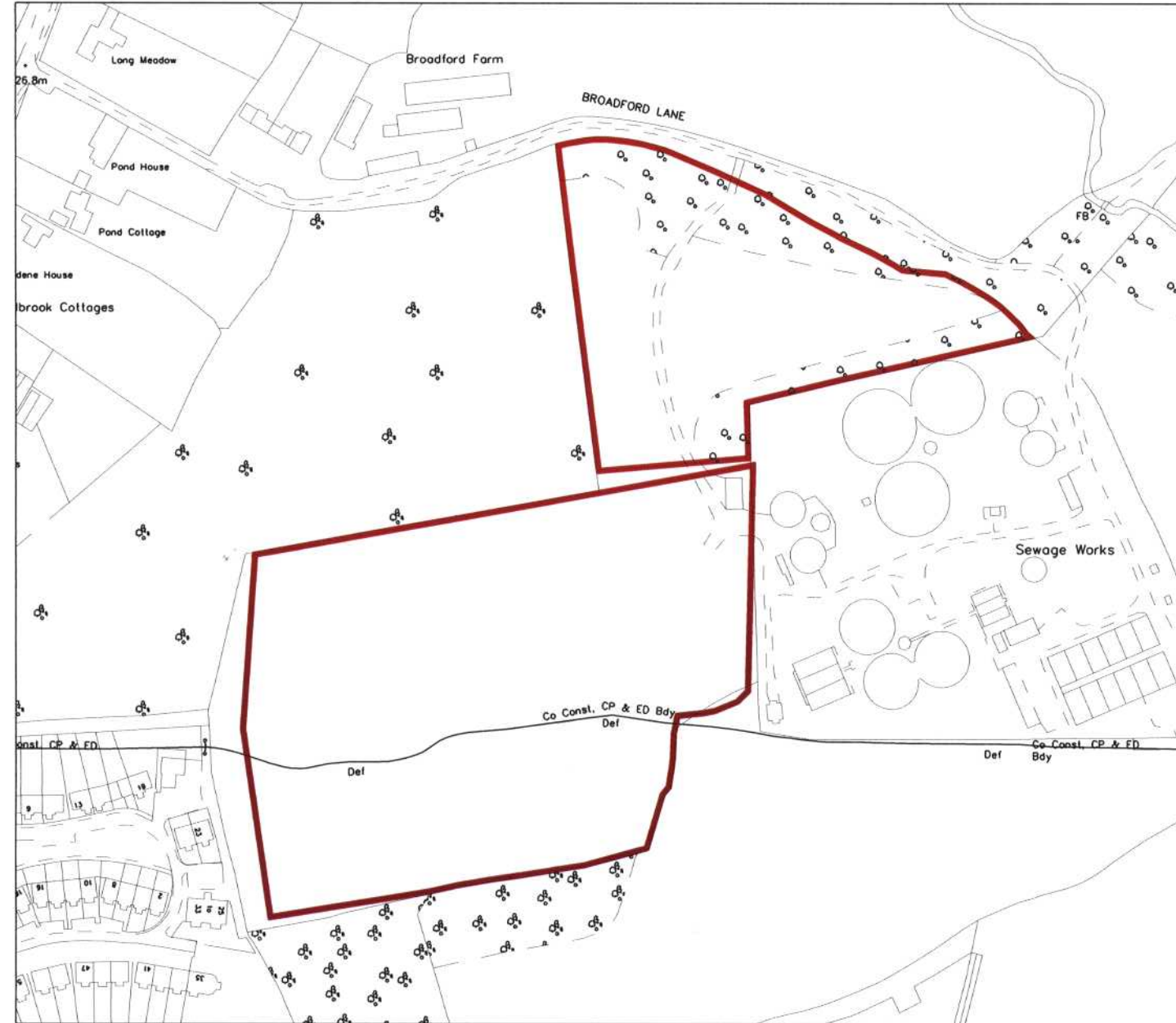

Based upon the Ordnance Survey mapping with the permission of the Controller of H.M.S.O. © Crown copyright. Unauthorised reproduction infringes Crown copyright and may lead to prosecution or civil proceedings. Surrey County Council LA 076872 1996.

Notes

Rev.	Description	Date	By	Chk'd
------	-------------	------	----	-------



Construction Management Unit, County Hall,  
Penryhn Road, Kingston upon Thames, Surrey, KT1 2DW.

Tel : 020 8541 9231

O.S. Ref.	SU 9761		
Scale	1:2500 @ A4		
Surveyed by	Drawn by KBD	Checked by	
Date	Date 25.05.11	Date	

Location  
**FORMER REFUSE TIP**  
**BROADFORD LANE**  
**CHOBHAM**

Title  
**GRAZING PLAN**  
**HIGHWAYS ACT 1980**  
**S.31(6) DECLARATION**

Plan File No.