

**OCKFORD WOOD FARM
NEW WAY
GODALMING, SURREY, GU7 2QL**

01483 415832

STATEMENT

Nigel and Fiona Gibbons of Ockford Wood Farm, New Way, Godalming, Surrey, GU7 2QL, do solemnly and sincerely declare as follows :

- 1 We are the joint owners of the property / land known as Ockford Wood Farm, New Way, Godalming, which is coloured pink on the attached plans marked No 1 and 2.
- 2 Upon the said plan there is marked in green RoW No 6 (public bridleway).
- 3 In accordance with the provisions of Section 31 of the Highways Act 1980, we declare that there are no other public rights of way of any sort over the aforesaid land nor do we recognise any other such public right of way whatsoever.

And we make this solemn declaration conscientiously believing the same to be true and by the virtue of the Statutory Declarations Act 1835.

Declared by the above named on the 6th June 1995

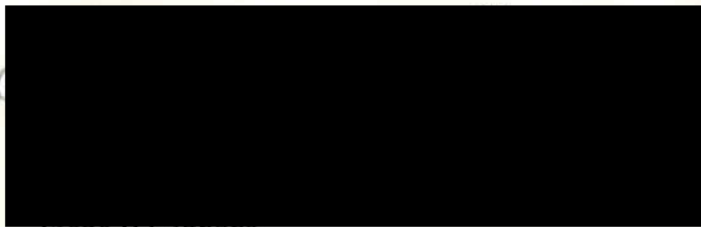

Fiona R Gibbons



Nigel Gibbons

PLAN 1

H.M. LAND REGISTRY		SY 045522	
ORDNANCE SURVEY PLAN REFERENCE	SU 9543 NE SU 9544 SE SU 9643 NW SU 9644 SW	Scale	1/1250
COUNTY SURREY	DISTRICT WAVERLEY	© Crown Copyright	

MS. CERTIFY THIS TO BE A TRUE COPY OF THE ORIGINAL BRAND AND

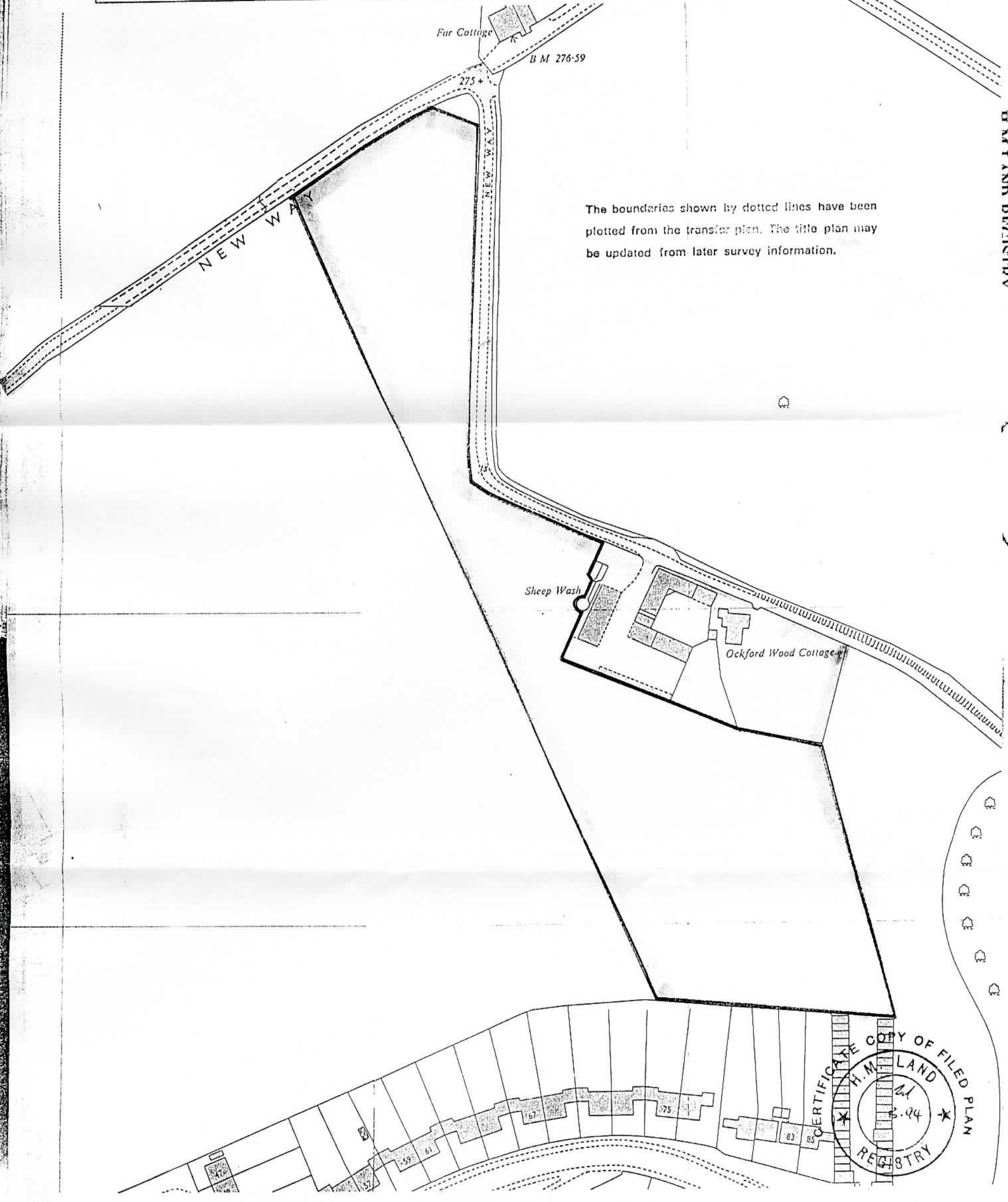

The boundaries shown by dotted lines have been plotted from the transfer plan. The title plan may be updated from later survey information.

H.M. LAND REGISTRY



OFFICE COPY

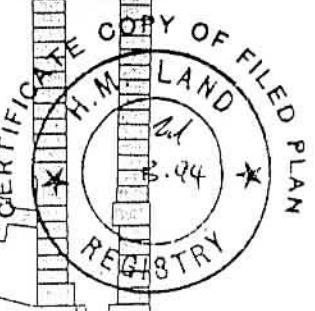

PLAN 2

BRAND (over)

H.M. LAND REGISTRY

SY 645920

Scale
1/1250

ORDNANCE SURVEY
PLAN REFERENCE

SU 9643 NW

© Crown Copyright

COUNTY SURREY

WAVERLEY DISTRICT

H.M. LAND REGISTRY



CERTIFICATE COPY OF FILED PLAN
 H.M. LAND
 REGISTRY
 M
 84