

Ockford Wood Farm

New Way

Godalming

Surrey GU7 2QL

01483 415832

STATUTORY DECLARATION
Section 31 (6) of The Highways Act 1980

Nigel and Fiona Gibbons of Ockford Wood Farm, New Way, Godalming, Surrey GU7 2QL, do solemnly and sincerely declare as follows :

- We are the joint owners of the property / land known as of Ockford Wood Farm, New Way, Godalming, which is coloured pink on the attached plans marked no. 1 and no. 2.
- Upon the said plan there is a marked in green ROW no. 6 (public bridleway), and a recent footpath marked in blue as shown on Surrey County Council's drawing no. 3/1/19/H7.
- In accordance with the provisions of Section 31 of the Highways Act 1980, we declare that there are no other public rights of way of any sort over the aforesaid land nor do we recognise any other such other public rights of way whatsoever.

And we make this solemn declaration conscientiously believing the same to be true and by the virtue of the Statutory Declarations Act 1835.

Declared by the above named on the ~~16~~ 15 May 2001.

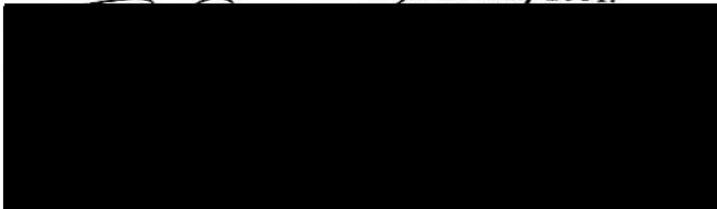

Nigel Gibbons

DECLARED AT
Connaught House
Alexandra Terrace
Guildford Surrey
GU1 3DA

Before me



A RIVER.
SOUTHERN.

PLAN 1

H.M. LAND REGISTRY		SY 045322	
ORDNANCE SURVEY PLAN REFERENCE	SU9543 NE SU9544SE SU9643NW SU9644 SW	Scale	1/1250
COUNTY SURREY	DISTRICT WAVERLEY	© Crown Copyright	

AS CERTIFIED AND INDEXED BY THE REGISTRAR
H.M. LAND REGISTRY

H.M. LAND REGISTRY

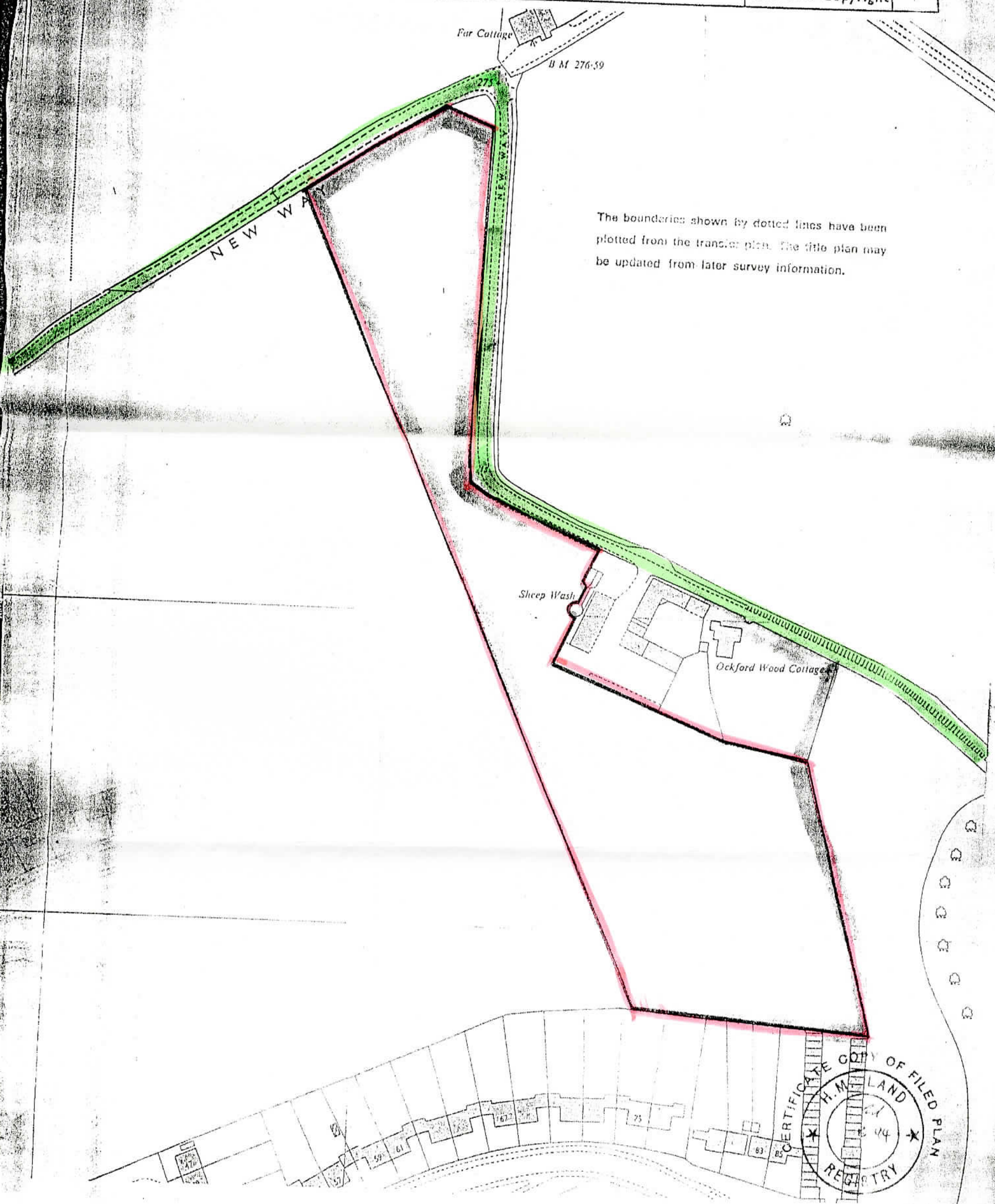

The boundaries shown by dotted lines have been plotted from the transfer plan. The title plan may be updated from later survey information.



OFFICE COPY

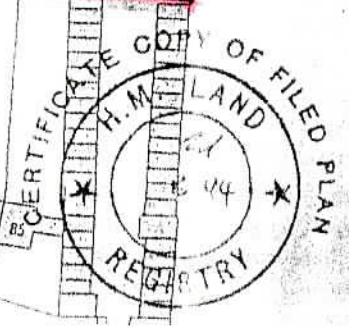

PLAN 2

PLAN 2

H.M. LAND REGISTRY		SY 645920	
ORDNANCE SURVEY PLAN REFERENCE	SU 9643 NW	Scale	1/1250
COUNTY SURREY	WAVERLEY DISTRICT	© Crown Copyright	

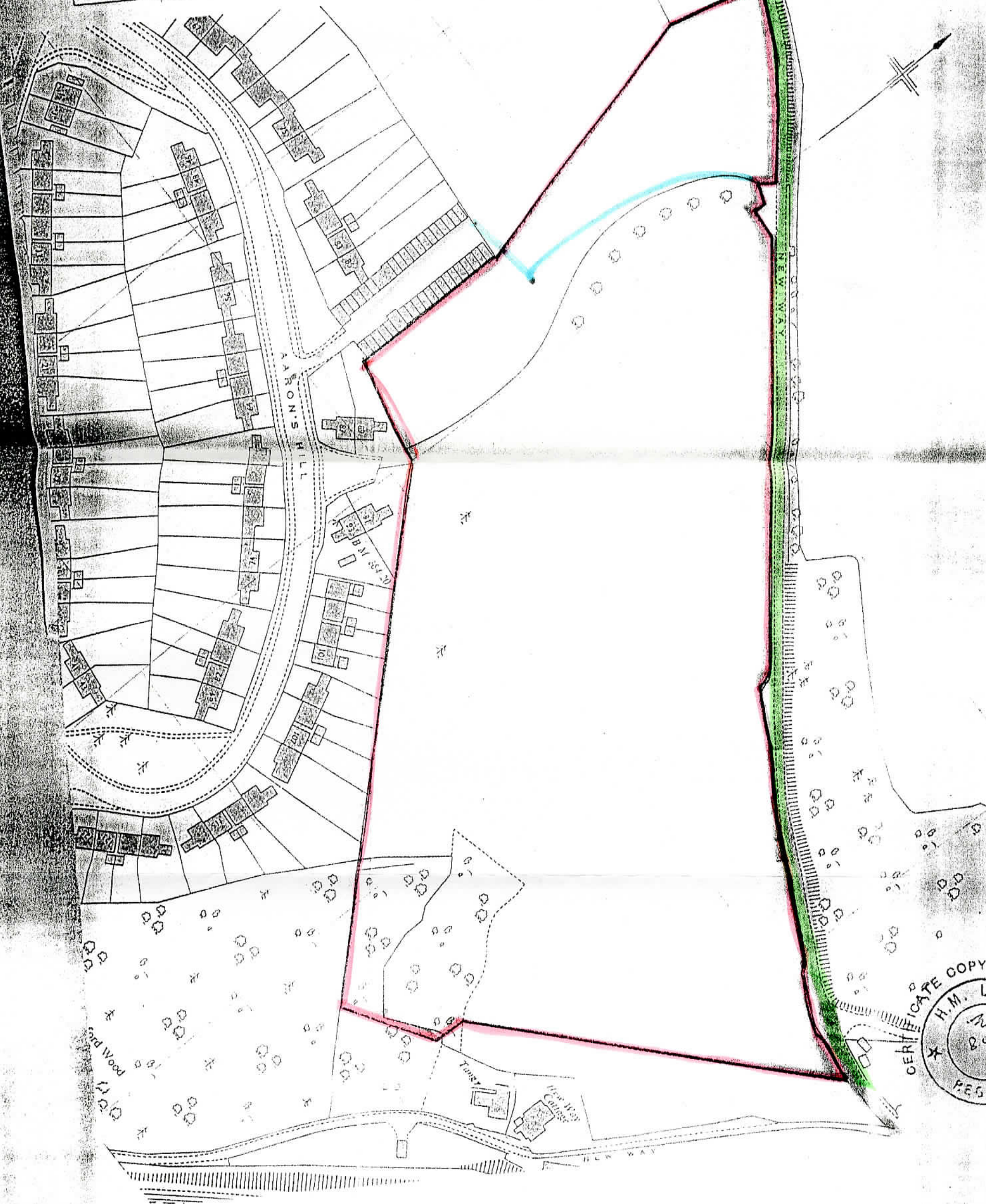

H.M. LAND REGISTRY

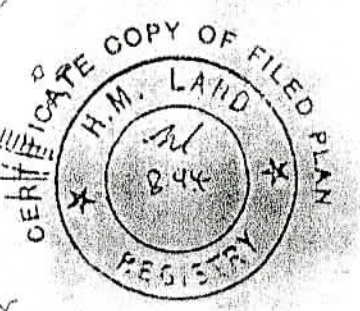

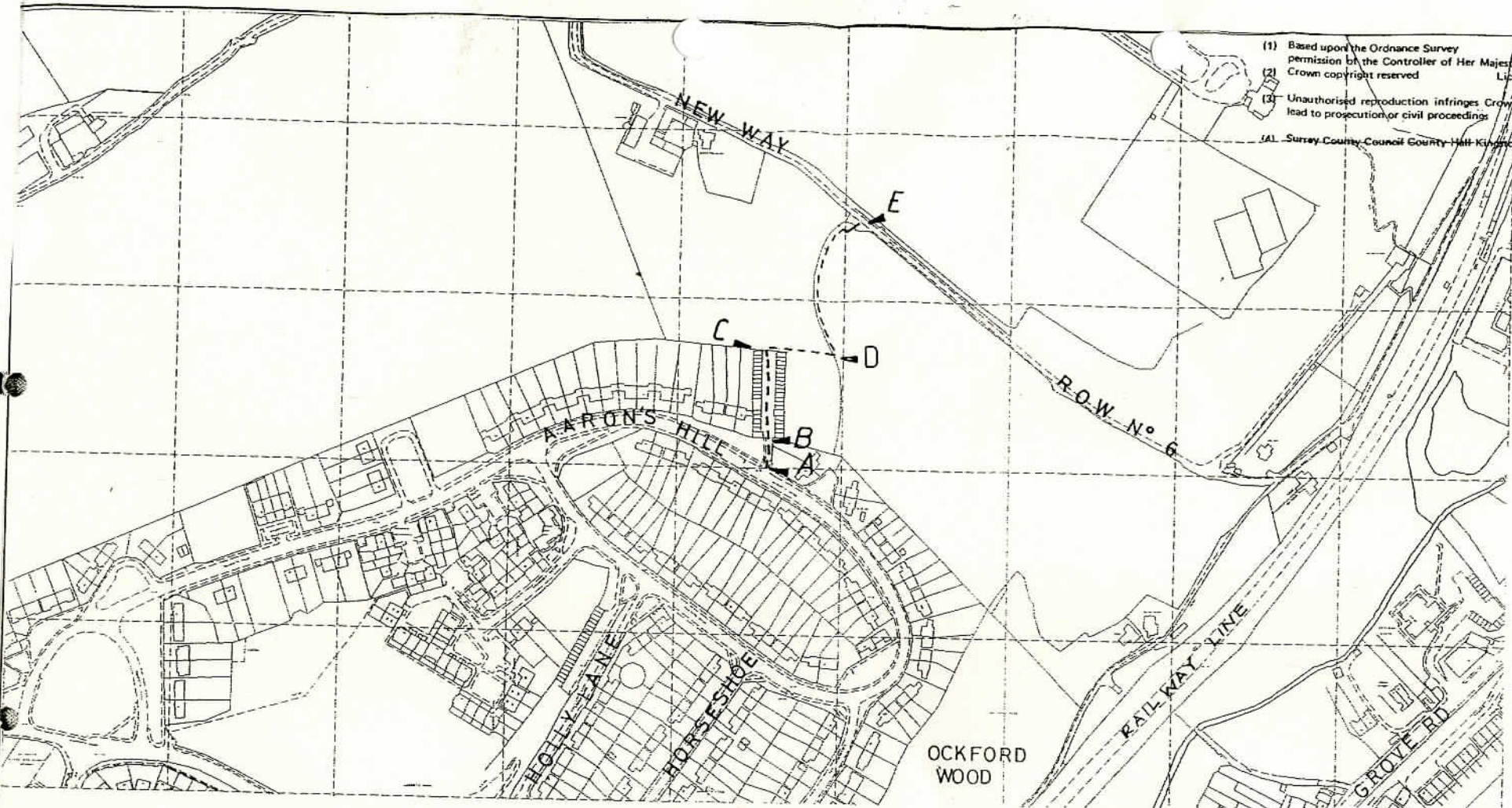

(1) Based upon the Ordnance Survey scale map with the permission of the Controller of Her Majesty's Stationery Office. Crown copyright reserved. Licence No. 0761872
 (2)
 (3) Unauthorised reproduction infringes Crown copyright and may lead to prosecution or civil proceedings.
 (A) Surrey County Council County Hall Kingston upon Thames Surrey

Dedication of a public footpath shown -----
 Distance A - B 20m B - C 55m C - D 42m D - E 94 m

OS Sheet no
 SU 9643
 Grid ref at point
 A SU 96154370
 SA Ref 118 C2

Scales	
1 : 2500	
↑	
Drawn	Date

BOROUGH OF WAVERLEY
 GODALMING

 **SURREY COUNTY COUNCIL**
 Highways and Transportation Department
 Rights of Way Group
 Director: G.M Lamb, M.Sc., C.Eng., F.I.C.E.

Drg. No. 3 / 1 / 19 / H 7A