

AGTS

14722(2)

WE THE HONOURABLE RALPH GEORGE ALGERNON PERCY WILLIAM FRANCIS PENNYMAN HUGONIN and THE HONOURABLE MATTHEW WHITE RIDLEY (as the Trustees of the trust for sale under the Will and Codicil of the Seventh Duke of Northumberland deceased and supplemental trust documents) whose address for all purposes relating to this Declaration is The Estate Office Albury Guildford Surrey GU5 9AF HEREBY SOLEMNLY AND SINCERELY DECLARE as follows:-

1. This Statutory Declaration constitutes a Statement for the purposes of Section 31(6)(b) of the Highways Act 1980.
2. We are (in our capacity as trustees as aforesaid) together the owner (within the meaning of Section 31 of the Highways Act 1980) of the land in the County of Surrey comprised in the estate vested in us and known as The Albury Estate shown edged red on the plan now produced to us marked "MCGB1".
3. The ways shown on the said attached plan as follows (namely):-
 - (i) The public bridle ways shown thereon in green
 - (ii) The public footpaths shown thereon in purple
 - (iii) The byways open to all traffic shown thereon in brown (each with the right of way numbers allocated to them by the Surrey County Council)are the ways (and the only ways) over that land which we

admit to have been dedicated as public highways.

- 4. No other ways over that land have to our knowledge been dedicated as public highways.

And we made this solemn declaration conscientiously believing the same to be true and by virtue of the Statutory Declarations Act 1835.

DECLARED AT *Cave Lodge*)
Albury)
General Tax Survey)
this *7th* day of *June* 1995)

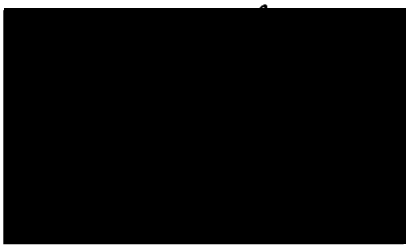

Before me 

LYNN CRITCHLEY
A Solicitor/Commissioner for Oaths

The Albury Estate

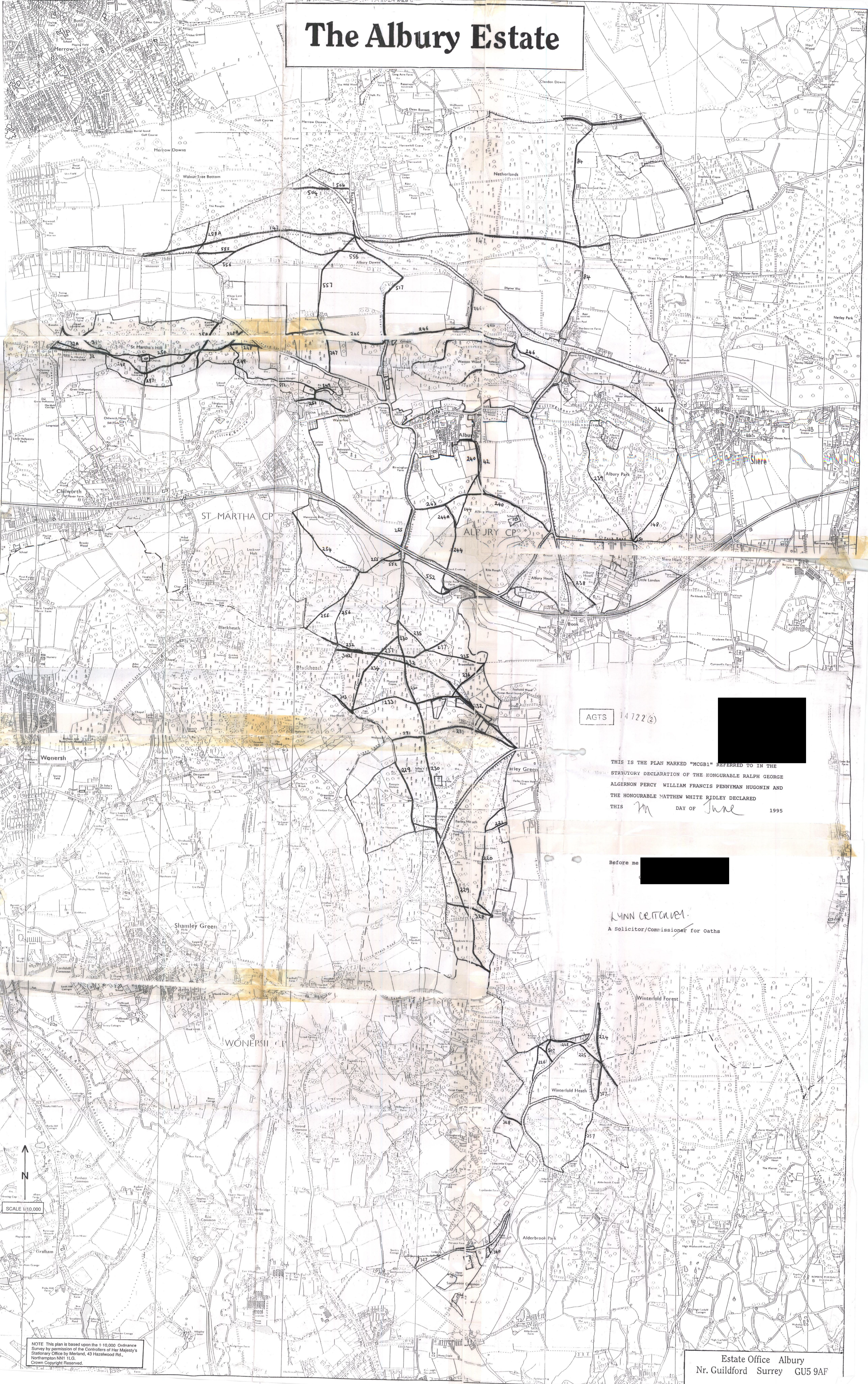

AGTS 14722(2)

THIS IS THE PLAN MARKED "MCGB1" REFERRED TO IN THE STATUTORY DECLARATION OF THE HONOURABLE RALPH GEORGE ALGERNON PERCY WILLIAM FRANCIS PENNYMAN HUGONIN AND THE HONOURABLE MATTHEW WHITE RIDLEY DECLARED THIS *m* DAY OF *June* 1995

Before me

LYNN CRITCHLEY
A Solicitor/Commissioner for Oaths

SCALE 1/10,000

NOTE This plan is based upon the 1:10,000 Ordnance Survey by permission of the Controller of Her Majesty's Stationery Office by Herford, 43 Hazelwood Rd, Northampton NN1 1LG. Crown Copyright Reserved.

Estate Office Albury
Nr. Guildford Surrey GU5 9AF