

10. 'Appropriate authority' means (a) in relation to a map or statement deposited or declaration lodged under section 31(6) of that Act, an appropriate council (as defined in section 31(7) of the Highways Act 1980); and (b) in relation to a statement and map deposited under section 15A(1) of the 2006 Act, a commons registration authority (defined in section 4 of the Commons Act 2006 and section 2 of the Commons Registration Act 1965). In practice, the appropriate council and commons registration authority will usually be the same body.

PART A: Information relating to the applicant and land to which the application relates
(all applicants must complete this Part)

1. Name of appropriate authority to which the application is addressed:

Surrey County Council

2. Name and full address (including postcode) of applicant:

Robert Haversham Godwin-Austen, Manor Farm House, East Shalford Lane, Guildford, Surrey GU4 8AR

3. Status of applicant (tick relevant box or boxes):

I am

(a) the owner of the land(s) described in paragraph 4.

(b) making this application and the statements/declarations it contains on behalf of [insert name of owner] who is the owner of the land(s) described in paragraph 4 and in my capacity as [insert details].

4. Insert description of the land(s) to which the application relates (including full address and postcode):

The Nore Section of the Godwin-Austen Estate, Central Postcode Tilsey Farm, Horsham Road, Bramley, Guildford, Surrey GU5 0LN

5. Ordnance Survey six-figure grid reference(s) of a point within the area of land(s) to which the application relates (if known):

TQ 024403

6. This deposit comprises the following statements: *Parts B and D.*

PART B: Statement under section 31(6) of the Highways Act 1980

I am the owner of the land described in paragraph 4 of Part A of this form and shown edged red on the map accompanying this statement.

Ways shown coloured brown on the accompanying map are byways open to all traffic.

Ways shown coloured green on the accompanying map are public bridleways.

Ways shown coloured purple on the accompanying map are public footpaths.

No other ways over the land shown edged red on the accompanying map have been dedicated as highways.

PART C: Declaration under section 31(6) of the Highways Act 1980

1. [I am/[insert name of owner] is] the owner of the land described in paragraph 4 of Part A of this form and shown [insert colouring] on the map [accompanying this declaration/lodged with [insert name] Council on [insert day, month, year]].

(delete wording in square brackets as appropriate and/or insert information as required)

2. On the [insert day] day of [insert month, year] [I/my/[insert name of owner's] predecessor in title [insert name]] deposited with [insert name] Council, being the appropriate council, a statement accompanied by a map showing [my/[insert name of owner's]] property [insert colouring] which stated that:

[the ways shown [insert colouring] on that map [and on the map accompanying this declaration] had been dedicated as byways open to all traffic]

[the ways shown [insert colouring] on that map [and on the map accompanying this declaration] had been dedicated as restricted byways]

[the ways shown [insert colouring] on that map [and on the map accompanying this declaration] had been dedicated as bridleways]

[the ways shown [insert colouring] on that map [and on the map accompanying this declaration] had been dedicated as footpaths]

[no [other] ways had been dedicated as highways over [my/[insert name of owner's]] property].

(delete wording in square brackets as appropriate and/or insert information as required)

[3. On the [insert day] day of [insert month, year] [I/my/[insert name of owner's] predecessor in title [insert name]] deposited with [insert name] Council, being the appropriate council, a declaration dated [insert day, month, year], stating that no additional ways [other than those marked in the appropriate colour on the map accompanying that declaration] had been dedicated as [byways open to all traffic] [restricted byways] [bridleways] [footpaths] since the deposit of the statement referred to in paragraph 2 above.]

(delete if not applicable and delete wording in square brackets as appropriate and/or insert information as required)

4. No additional ways have been dedicated over the land [insert colouring] on the map [accompanying this declaration/referenced in paragraph 1 above] since the statement dated [insert day, month, year] referred to in paragraph 2 above [since the date of the declaration referred to in paragraph 3 above] [other than those [byways open to all traffic] [restricted byways] [bridleways] [footpaths] marked in the appropriate colour on the map accompanying this declaration] and at the present time [I/[insert name of owner]] [have/has] no intention of dedicating any more public rights of way over [my/the] property.

(delete wording in square brackets as appropriate and/or insert information as required)

PART D: Statement under section 15A(1) of the Commons Act 2006

I am the owner of the land described in paragraph 4 of Part A of this form and shown edged red on the map accompanying this statement.

I wish to bring to an end any period during which persons may have indulged as of right in lawful sports and pastimes on the whole or any part of the land shown edged red on the accompanying map.

PART E: Additional information relevant to the application
(insert any additional information relevant to the application)

Please see 1/2500 scale map at Appendix A showing detail through Tilsey Farm buildings.

PART F: Statement of Truth
(all applicants must complete this Part)

WARNING: If you dishonestly enter information or make a statement that you know is, or might be, untrue or misleading, and intend by doing so to make a gain for yourself or another person, or to cause loss or the risk of loss to another person, you may commit the offence of fraud under section 1 of the Fraud Act 2006, the maximum penalty for which is 10 years' imprisonment or an unlimited fine, or both.

I BELIEVE THAT THE FACTS AND MATTERS CONTAINED

Signature (of the person making the statement of truth):

Print full name: ROBERT HAVERSHAM GODWIN-AUS

Date: 7th July 2014

You should keep a copy of the completed form

Data Protection Act 1998 - Fair Processing Notice

The purpose of this Fair Processing Notice is to inform you of the use that will be made of your personal data, as required by the Data Protection Act 1998.

The appropriate authority (see explanation of definition in above guidance notes) in England is the data controller in respect of any personal data that you provide when you complete this form.

The information that you provide will be used by the appropriate authority in its duties to process applications to deposit statements, maps and declarations under section 31(6) the Highways Act 1980 and statements under section 15A(1) of the Commons Act 2006. The information you provide will also be used by the appropriate authority in its duty to update the registers in which details of such deposits are recorded under the Dedicated Highways (Registers under Section 31A of the Highways Act 1980) (England) Regulations 2007 and the Commons (Registration of Town or Village Greens) and Dedicated Highways (Landowner Statements and Declarations) (England) Regulations 2013.

The appropriate authority is required by the legislation above to maintain a register which holds information provided in this form, which can be inspected online or in person by members of the public on request. It may also be required to release information, including personal data and commercial information, on request under the Environmental Information Regulations 2004 or the Freedom of Information Act 2000. However, the appropriate authority will not permit any unwarranted breach of confidentiality nor will they act in contravention of their obligations under the Data Protection Act 1998.

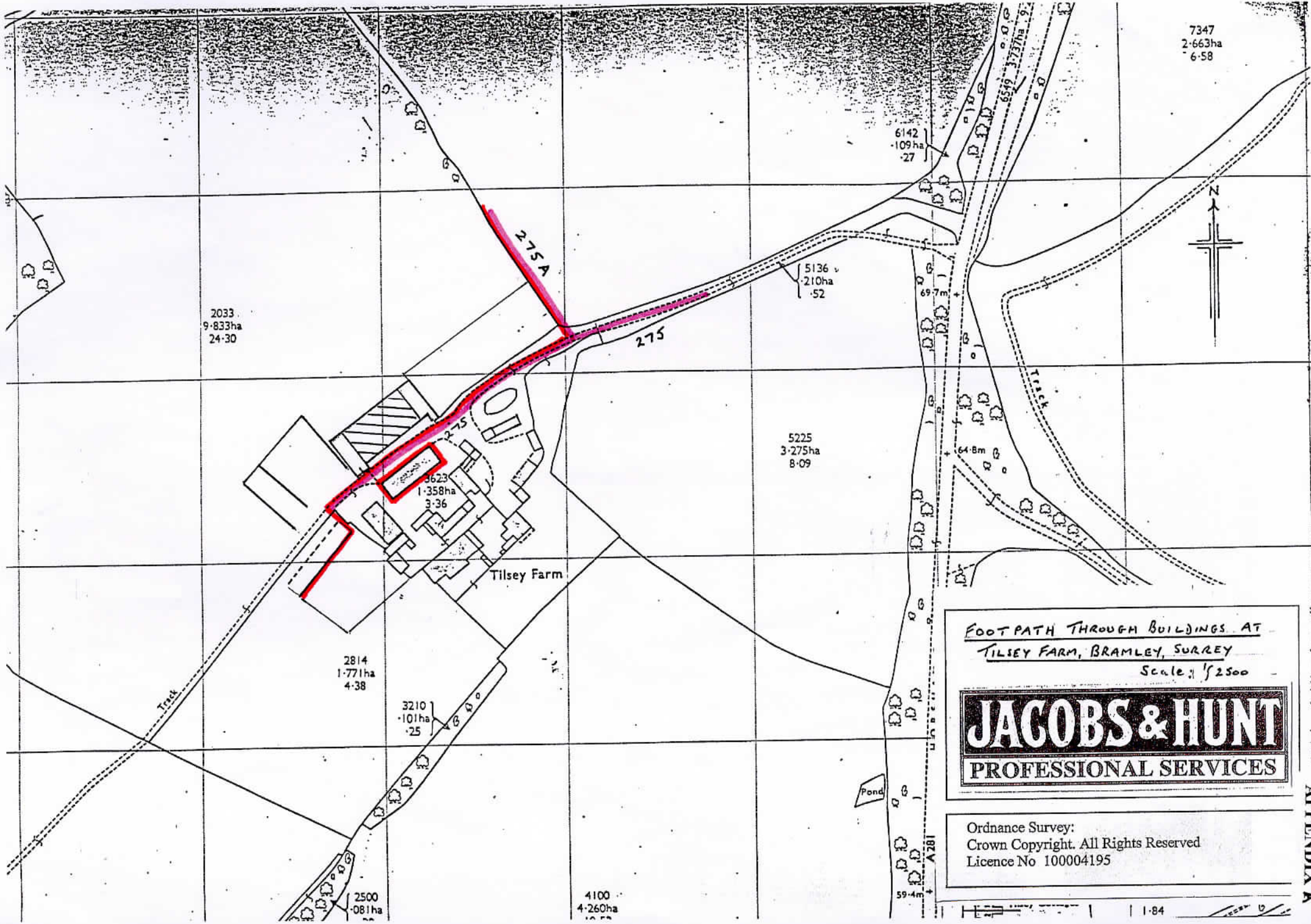

FOOT PATH THROUGH BUILDINGS AT
TILSEY FARM, BRAMLEY, SURREY
Scale: 1/2500

JACOBS & HUNT
PROFESSIONAL SERVICES

Ordnance Survey:
Crown Copyright. All Rights Reserved
Licence No 100004195

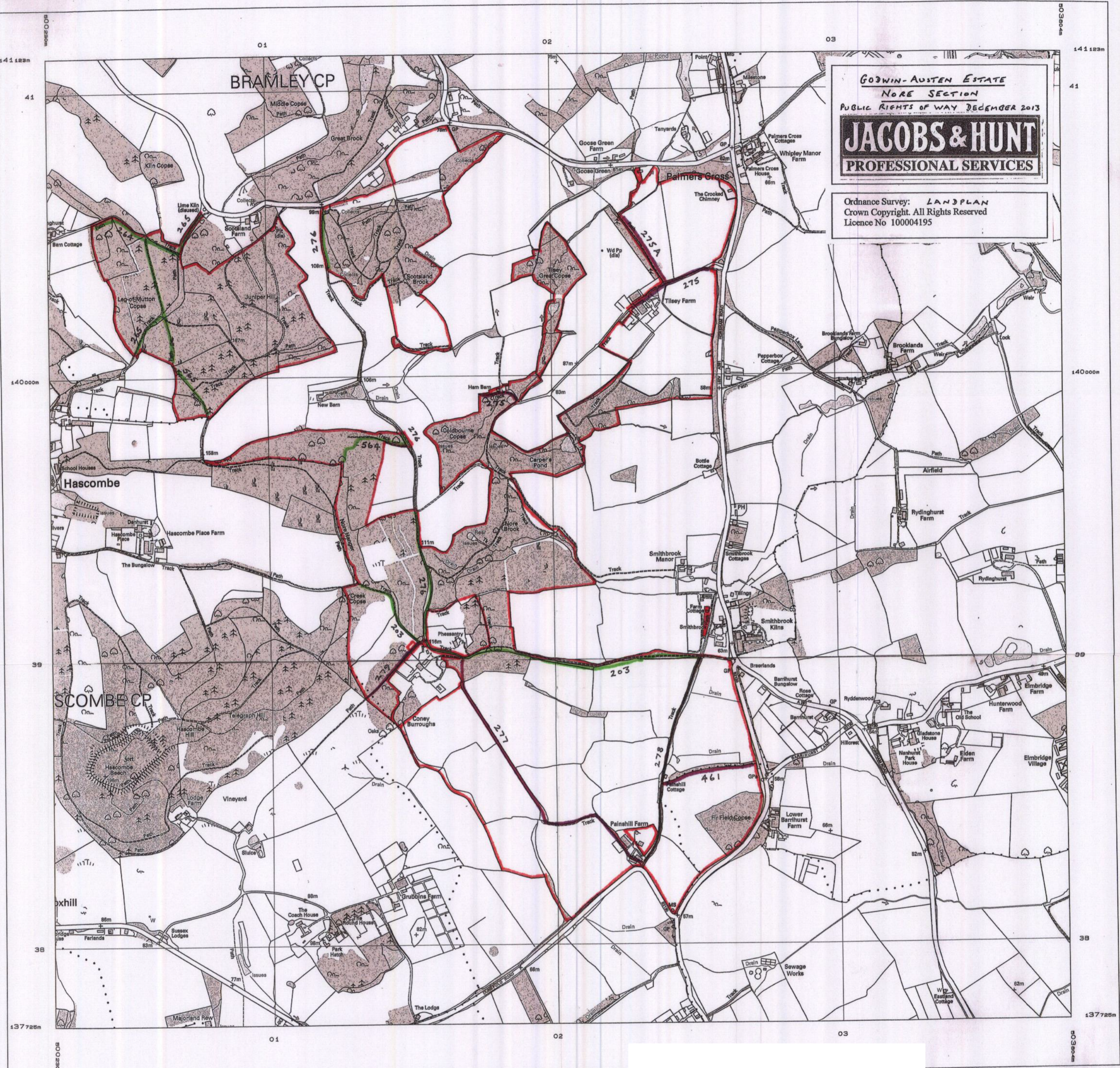

GODWIN-AUSTEN ESTATE
 NORE SECTION
 PUBLIC RIGHTS OF WAY DECEMBER 2013
JACOBS & HUNT
 PROFESSIONAL SERVICES
 Ordnance Survey: LANDPLAN
 Crown Copyright. All Rights Reserved
 Licence No 100004195

Plotted 19 Nov 2004 from Ordnance Survey digitally derived data.
 Produced using significant survey information from Ordnance Survey basic-scales digital data, and incorporated into Landplan Mar 2003.
 © Crown copyright 2004.
 Reproduction in whole or in part is prohibited without the prior written permission of Ordnance Survey.
 Administrative boundaries revised to Feb 2003.
 Additional boundaries information:

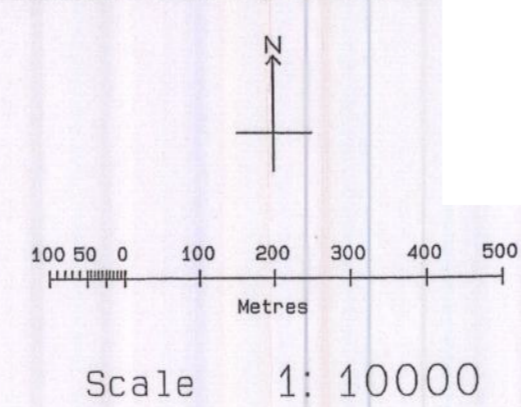

heights are given in metres above Newlyn Datum. The representation of a road, track or path is no evidence of a right of way.
 The alignment of tunnels is approximate.
 A Landplan symbols leaflet is available on request from Ordnance Survey Options outlets.
 Ordnance Survey, the OS Symbol, Landplan and Superplan are registered trade marks of Ordnance Survey, the national mapping agency of Great Britain.