

Statutory Declaration

Section 31(6) of the Highways Act 1980

We, **SIPKE VERHAGE** and **MARIA ELIZABETH VERHAGE** DO SOLEMNLY AND SINCERELY DECLARE as follows :-

1. We are and have been since 20th January 1997 the owners of the land known as Plot 1, Priorsfield Road, Godalming, Surrey more particularly delineated on the map accompanying this statement and thereon edged red [REDACTED]
2. On the 20th day of November 1997 I deposited with Surrey County Council, being the appropriate Council, a statement accompanied by a map delineating my property by red edging which stated that the way coloured green on the said map and on the map accompanying this declaration had been dedicated as a bridleway no other ways had been dedicated as highways over my property
3. No additional ways have been dedicated over the land edged red on the map accompanying this declaration since the statement dated 19th November ~~October~~ 1997 referred to in 2 above other than the bridleway marked in the appropriate colour on the map accompanying this declaration and at present time we have no intention of dedicating any more public rights of way over my property

AND WE MAKE this solemn declaration on the 24th day of November 1997 conscientiously believing the same to be true and by virtue of the Statutory Declaration Act 1835

Declared by the said **SIPKE VERHAGE** and **MARIA ELIZABETH VERHAGE** at

102 High Street Godalming
in the County of Surrey

Before me

B KILBURN
SOLICITOR

Commissioner for Oaths/Solicitor

96S4261

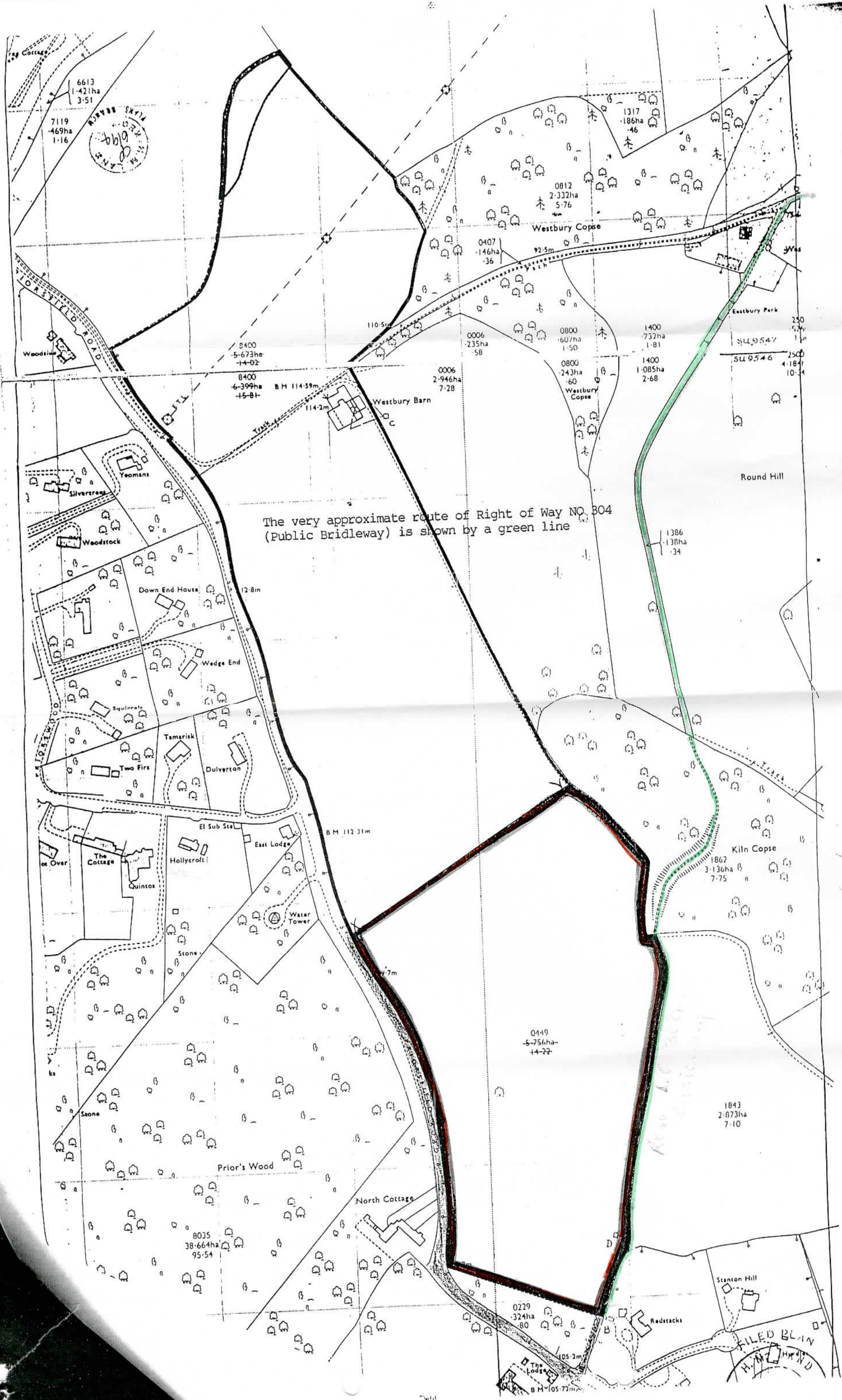

The very approximate route of Right of Way NO. 304 (Public Bridleway) is shown by a green line

This is the plan referred to in the declaration of Sirke Verhage and Dame Elizabeth Verhage dated before me this 2nd November 1991

FILED BLAN
H.M.C. H.M.C.