

Deposit of Statement and Map

Section 31(6) of the Highways Act 1980

To Surrey County Council Highways & Transportation Department

1. We are and have been since the 20th January 1997 the owners within the meaning of the above section of the land known as Plot 1, Priorsfield Road, Godalming, Surrey more particularly delineated on the map accompanying this statement and thereon edged red
2. The aforementioned land lies in the Parish of Compton in the Borough of Guildford
3. The way coloured green on the said map has been dedicated as a bridleway
4. No other ways over the land have been dedicated as Highways
5. The deposit shall comprise this statement and accompanying map

Signed

[Redacted Signature]

Sipke Verhage

AGTS
72200

W
I
T
N
E
S
S

Signature
Name
Address
Occupation

[Redacted Signature]
RAYMOND CORREARD
BROADWAY BRIDGEWAY. GODALMING.
DIRECTOR.

Signed

[Redacted Signature]

Maria Elizabeth Verhage

W
I
T
N
E
S
S

Signature
Name
Address
Occupation

[Redacted Signature]
RAYMOND CORREARD
BROADWAY BRIDGEWAY. GODALMING.
DIRECTOR.

96S4261

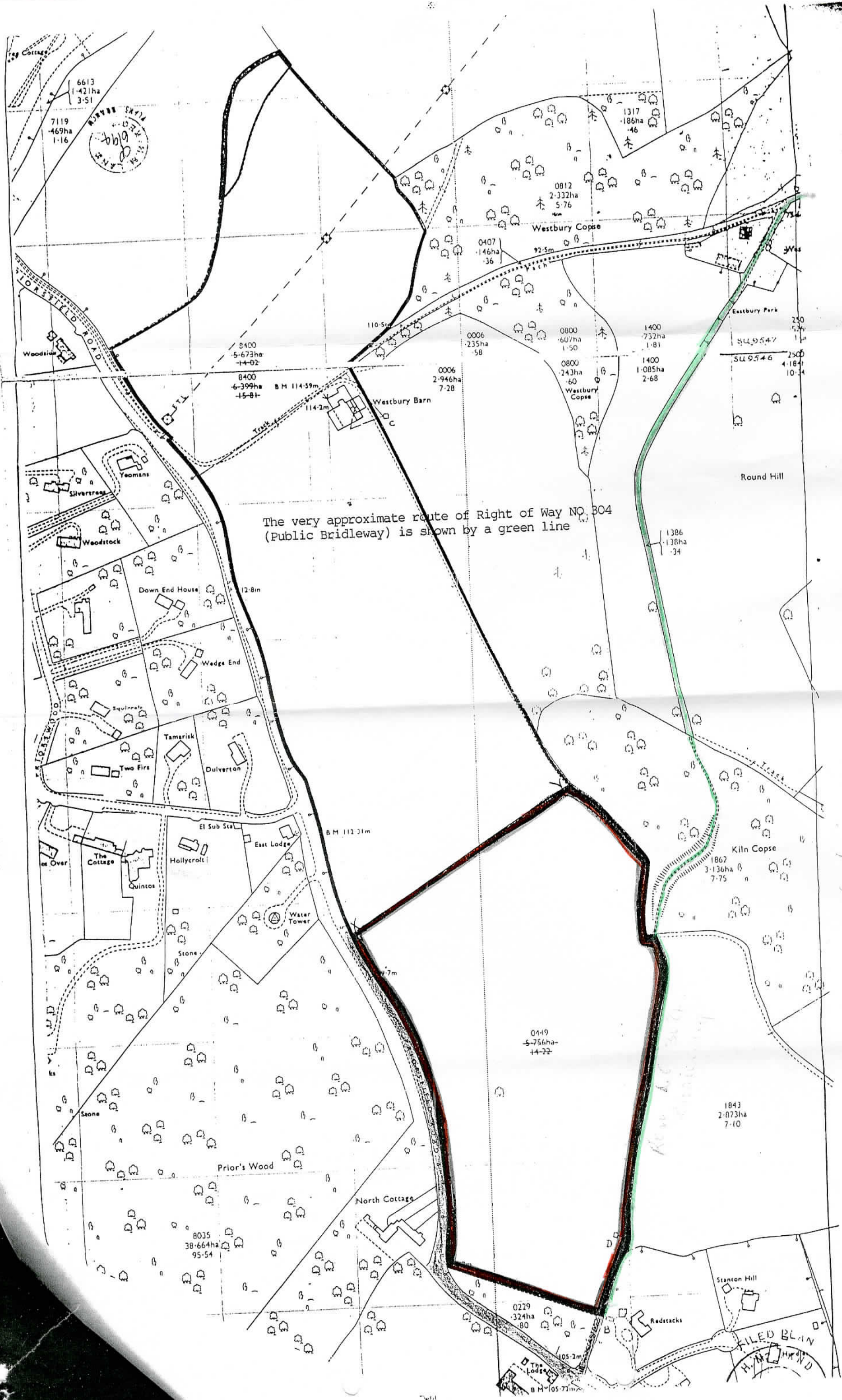

The very approximate route of Right of Way NO. 304
(Public Bridleway) is shown by a green line

*This is the plan referred to in
the declaration of Sirke Verhage and
Dame Elizabeth Jephson dated
before me April 2nd November 1991*