

73113
3074

STATEMENT UNDER SECTION 31(6) OF THE HIGHWAYS ACT 1980

To: The Clerk & Chief Executive
Surrey County Council
County Hall
KINGSTON UPON THAMES
Surrey

THE MEMBERS OF THE BHRA LTD

1. ^{or} am the owner^s of the land shown edged red on the attached map which is on a scale of not less than six inches to one mile.

THE MEMBERS OF THE BHRA LTD.

2. admit that the following ways shown coloured brown on the said map have been dedicated as highway:- *NO SUCH WAYS EXIST ON BHRA LTD LANDS. W*
(Give starting and finishing points of each way. If no ways have been dedicated please state this categorically.)

3. With the exception of those ways (if any) set out in Paragraph 2 above, THE MEMBERS OF THE BHRA LTD. deny that any other ways over the land shown edged red on the map have been dedicated as highways.

BHRA. LTD,

Signed: [Redacted]

Name:

*DR. W.F.J. KLEINSMIEDE **

Address:

*2 BROOME HALL
GOLD HARBOUR DOCKING
SURREY RH5 6HD*

Date:

20 DECEMBER 1987

** HON. SECR. BROOME HALL RESIDENTS ASSOCIATION LIMITED.
(BHRA. LTD.)*

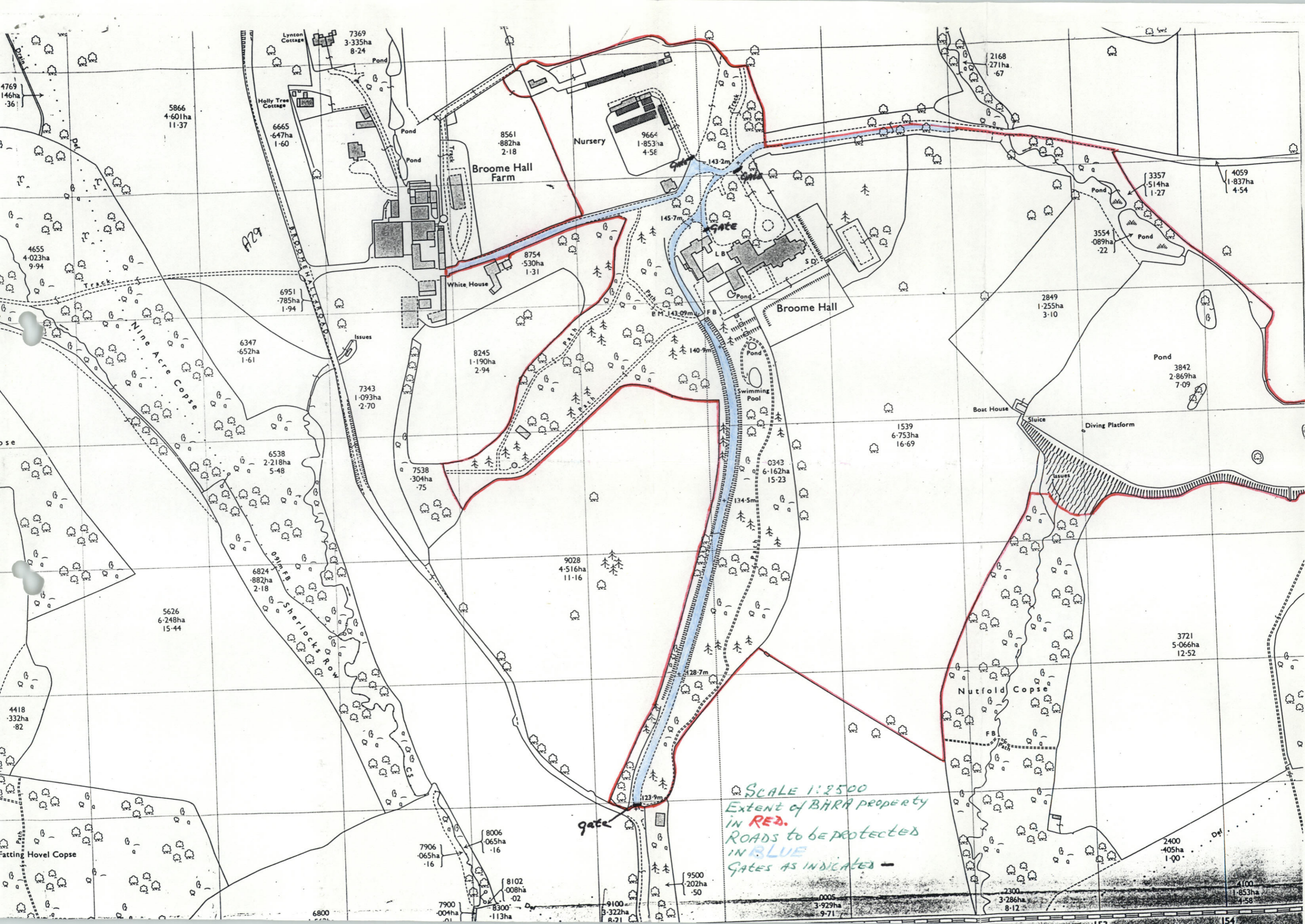

SCALE 1:2500
Extent of BIRA property
IN RED.
ROADS to be protected
IN BLUE
GATES AS INDICATED

5866
4-601ha
11-37

7369
3-335ha
8-24

6665
-647ha
1-60

8561
-882ha
2-18

9664
1-853ha
4-58

2168
-271ha
-67

3357
-514ha
1-27

4059
1-837ha
4-54

4655
4-023ha
9-94

6951
-785ha
1-94

8754
-530ha
1-31

Broome Hall

2849
1-255ha
3-10

6347
-652ha
1-61

8245
1-190ha
2-94

140-9m

3842
2-869ha
7-09

6538
2-218ha
5-48

7538
-304ha
-75

0343
6-162ha
15-23

1539
6-753ha
16-69

6824
-882ha
2-18

9028
4-516ha
11-16

5626
6-248ha
15-44

3721
5-066ha
12-52

4418
-332ha
-82

7906
-065ha
-16

8006
-065ha
-16

8102
-008ha
-02

9100
3-322ha
8-21

9500
-202ha
-50

0005
3-929ha
9-71

2300
3-286ha
8-12

4100
1-853ha
4-58

Patting Hovel Copse

Nutfold Copse

2400
-405ha
1-00

4100
1-853ha
4-58