

**DEPOSIT OF STATEMENT and PLAN**

**SECTION 31(6) OF THE HIGHWAYS ACT 1980**

To Surrey County Council

1. Croudace Homes Limited is and has been since 6 April 1988 the owner within the meaning of the above section of the land known as land on the south east side of Furze Lane, Godalming more particularly delineated on the plan accompanying this statement and thereon edged red
2. The aforementioned land lies in the Parish of Godalming
3. In accordance with the provisions of Section 31 of the Highways Act 1980, I declare that there are no public rights of way of any sort over the aforesaid land nor do I recognise any such public right of way whatsoever
4. The deposit shall comprise this statement and accompanying plan

**Signed by landowner**

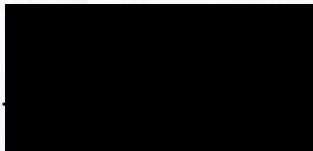
.....  .....

Director

**Name**

Croudace Homes Limited

**Address**

Croudace House

Caterham

Surrey CR3 6XQ

*Date*

19 December 2011

**in the presence of**

**Signed by witness**

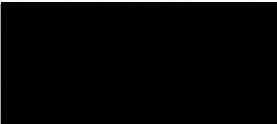
 .....

**Name**

Stewart Wigner

**Address**

Croudace House

Caterham

Surrey CR3 6XQ

**Occupation**

Solicitor

# OFFICE COPY

ISSUED BY THE TUNBRIDGE WELLS DISTRICT LAND REGISTRY ON 30TH JAN 1989

**KEY**  
THE REGISTERED LAND CONSISTING OF THE PART OR PARTS EDGED WITH A THICK LINE REPRESENTING THE RED EDGING ON THE FILED PLAN IS MORE PARTICULARLY DESCRIBED IN THE PROPERTY REGISTER. IF THE THICK LINE ENCLOSES ANY NUMBERED PARTS BEARING LETTERED PREFIXES, THEN THOSE PARTS HAVE BEEN REMOVED FROM THE TITLE.

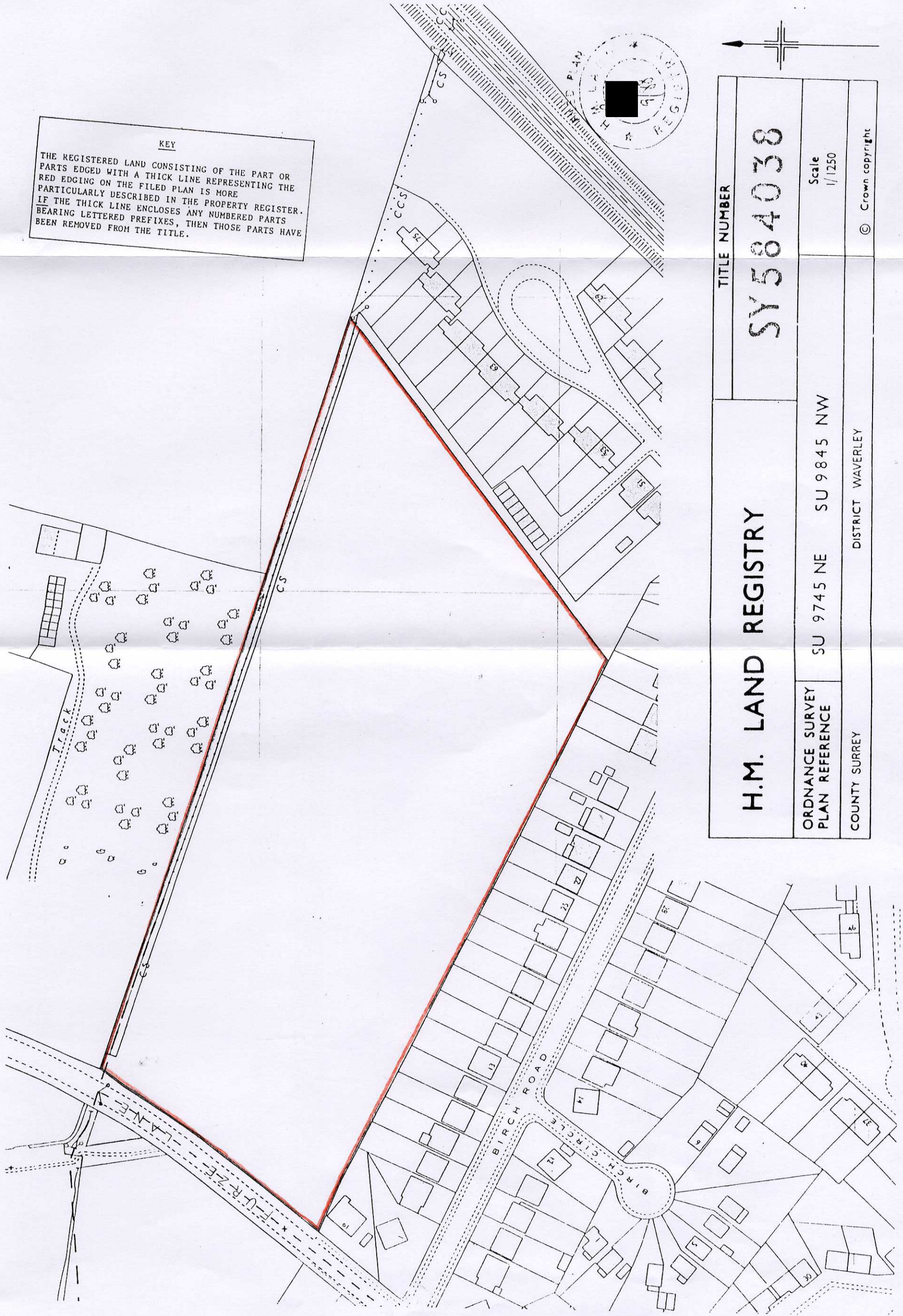

<b>H.M. LAND REGISTRY</b>		<b>TITLE NUMBER</b>	
		<b>SY 584038</b>	
<b>ORDNANCE SURVEY PLAN REFERENCE</b>	SU 9745 NE SU 9845 NW	<b>Scale</b>	1/1250
<b>COUNTY SURREY</b>	DISTRICT WAVERLEY	© Crown copyright	