

states
copy of
original

onal
le of
ined
the
ered
n of
the
e is
first
can

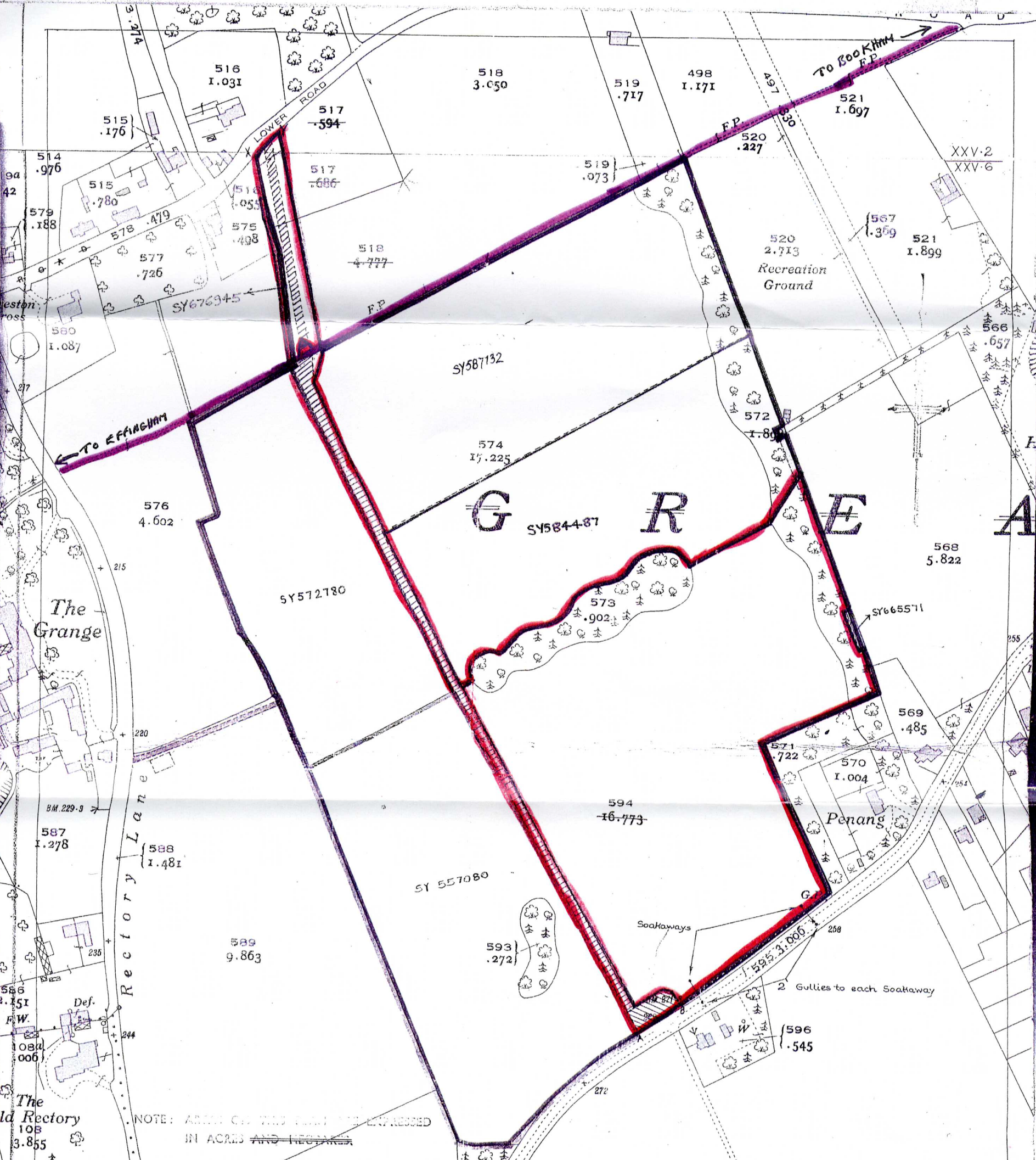

M.B. 25A

H.M. LAND REGISTRY

Title No. SY 379671

MOLE VALLEY DISTRICT

County— SURREY
O.S. Sheet XXV.2 § 6.
J.T. & S/S

Scale 1/2500

Crown Copyright Reserved

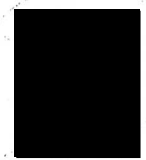

To: Surrey County Council, Highways Dept., Kingston-on-Thames, Surrey.

DEPOSIT OF STATEMENT AND **ONE MAP**, SECTION 31 (6) OF THE
HIGHWAYS ACT 1980.

1. WE, the undersigned, Mrs. Cynthia M. Flittner and Mrs. Edna F. Hodgkins have been the owners of the land edged red on the accompanying Land Registry plan since the death of our Mother, the late Mrs. R.A. Roberts, on the 5th May 1957.
2. The aforementioned land is situate in the parish/community of Great Bookham in the County of Surrey.
3. There is a public footpath coloured purple on the said plan which crosses our land on the northern boundary (at point A) which extends to Bookham and Effingham. It is dedicated as a public footpath.
4. No other ways over the land have been dedicated as a public right of way.
5. The Deposit shall comprise this Statement and copy plan from H.M. Land Registry, Title No. SY379671, scale 1/2500.

Signed:

Mrs. C.M. Flittner
Mill House Farm
Maresfield
Uckfield
E. Sussex.
TN22 2ED

Mrs. E.F. Hodgkins
117, Lower Village Road
Sunninghill
Nr. Ascot
Berks.
SL5 9BQ

Date:

23rd April 2003

Witnessed by

of

Occupation

P.K. LLOYD
Solicitor

Messrs. Fortescue, Graham & Lloyd
22a High Street, Great Bookham, Surrey KT23 4AG

P.K. LLOYD
Solicitor

Messrs. Fortescue, Graham & Lloyd
22a High Street, Great Bookham, Surrey KT23 4AG

23/4/03
