

HIGHWAYS ACT 1980 Section 31(6)

I, GEORGE SHEPHARD CORMACK, Defence Land Agent London, for and on behalf of the SECRETARY OF STATE FOR DEFENCE, and acting under the authority conferred upon me by the said Secretary of State DO SOLEMNLY AND SINCERELY DECLARE as follows:-

1. In accordance with Section 34(6) of the Highways Act 1959 the Secretary of State for Defence on the 27th day of March 1974 caused to be deposited with the Surrey County Council and the Caterham and Warlingham Urban District Council and the Sunbury on Thames Urban District Council and the London Borough of Croydon Council maps numbered 76/74 and 87/74 and 83/74 and the Secretary of State on the 20th day of February 1978 caused to be deposited with the Surrey County Council and the Tandridge District Council and the London Borough of Croydon Council maps numbered 87A/74 and 83A/74 of certain Establishments vested in the Secretary of State within the areas administered by such Councils together with statements indicating what ways over that land were admitted by the Secretary of State to have been dedicated as highways.

2. In accordance with Section 31(6) of the Highways Act 1980 no additional way over that part of the land delineated on the maps numbered 76/74 and 87A/74 and 83A/74 so deposited with the Surrey County Council which is still vested in the Secretary of State as shown by red edging on the attached maps numbered 76A/74 and 87B/74 and 83B/74 has been dedicated as a highway since 20th February 1978 being the date of a previous Declaration in accordance with the said section of the 1959 Act.

AND I MAKE this solemn declaration conscientiously believing the same to be true and by virtue of the Statutory Declarations Act 1835

DECLARED at
SHEPPERTON & CO.,
ST. MARGARETS HOUSE,
18/20 Southwark Street,
London Bridge, S.E. 1
this 23rd day of November 1990

.....
for and on behalf of
THE SECRETARY OF STATE FOR DEFENCE

Before me,
A-Commissi

.....
A SOLICITOR
EMPLOYED TO



SHEPPERTON MQ's
Scale 1/1250
O.S. Sheets TQ 0867 NE & SE
Plan No. 76/74

- LEGEND
- a. Ministry of Defence boundaries are shown by red edging.
 - b. Over each route shown by a continuous purple line, the Secretary of State recognizes a highway over which the public have a right of way on foot only.
 - c. Over each route shown by a continuous green line, the Secretary of State recognizes that the public have the following, but no other, rights of way, that is to say, a right of way on foot and a right of way on horseback or leading a horse, with
 - d. Over each route shown by a broken green line, the Secretary of State recognizes the way to be a highway other than a footpath or bridleway used by the public mainly for the purposes for which footpaths and bridleways are so used, or as a byway open to all traffic.
 - e. Over each route shown by a continuous brown tint the Secretary of State recognizes the route as a public road over which the public has the right to pass for all purposes with

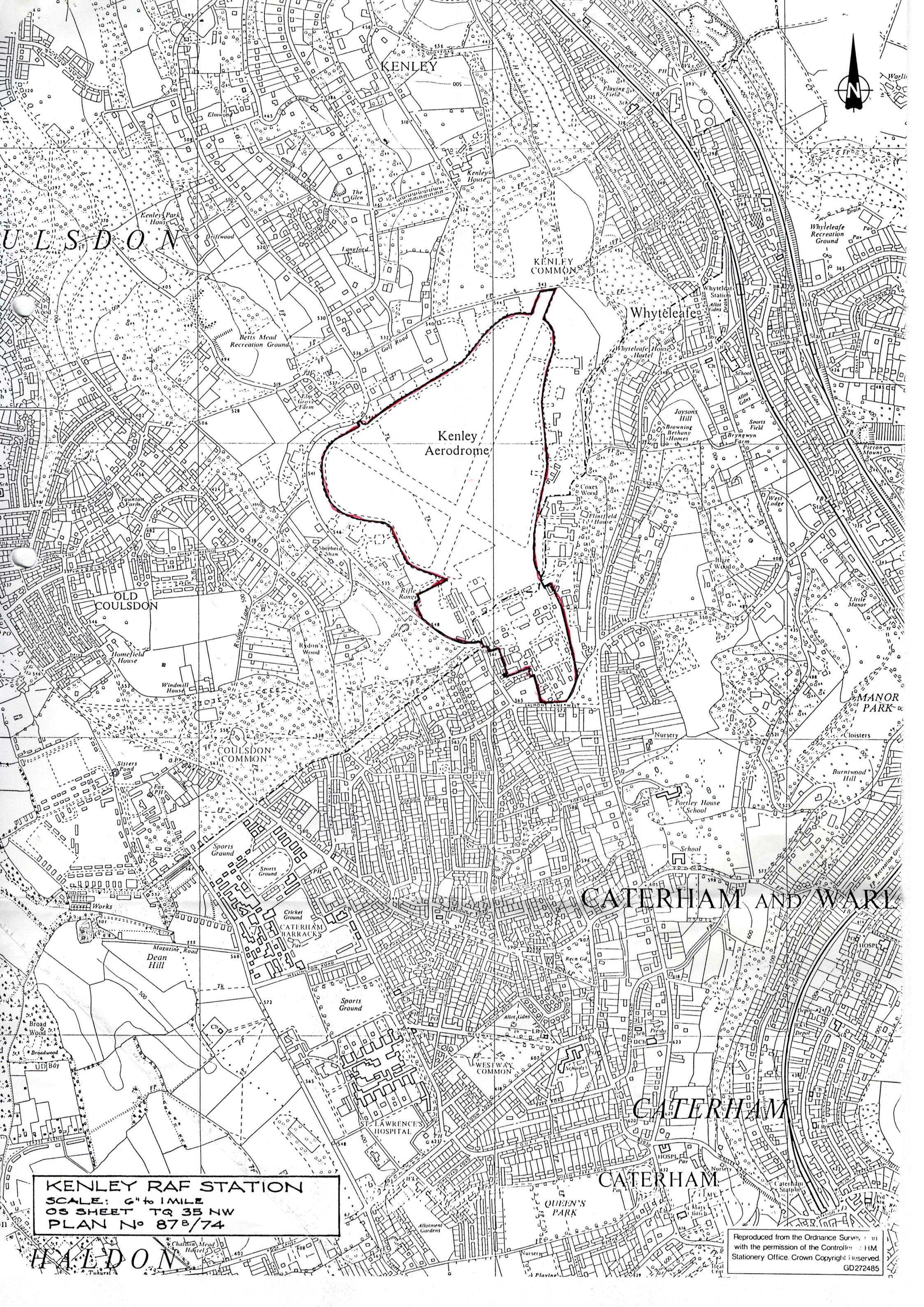

ULSDON

KENLEY

KENLEY COMMON

Whyteleafe

Kenley Aerodrome

OLD COULSDON

COULSDON COMMON

MANOR PARK

CATERHAM AND WARTINGHAM

CATERHAM

CATERHAM

KENLEY RAF STATION
SCALE: 6" to 1 MILE
OS SHEET TQ 35 NW
PLAN No 87B/74

ULSDON

Reproduced from the Ordnance Survey map with the permission of the Controller of Her Majesty's Stationery Office. Crown Copyright reserved. GD272485

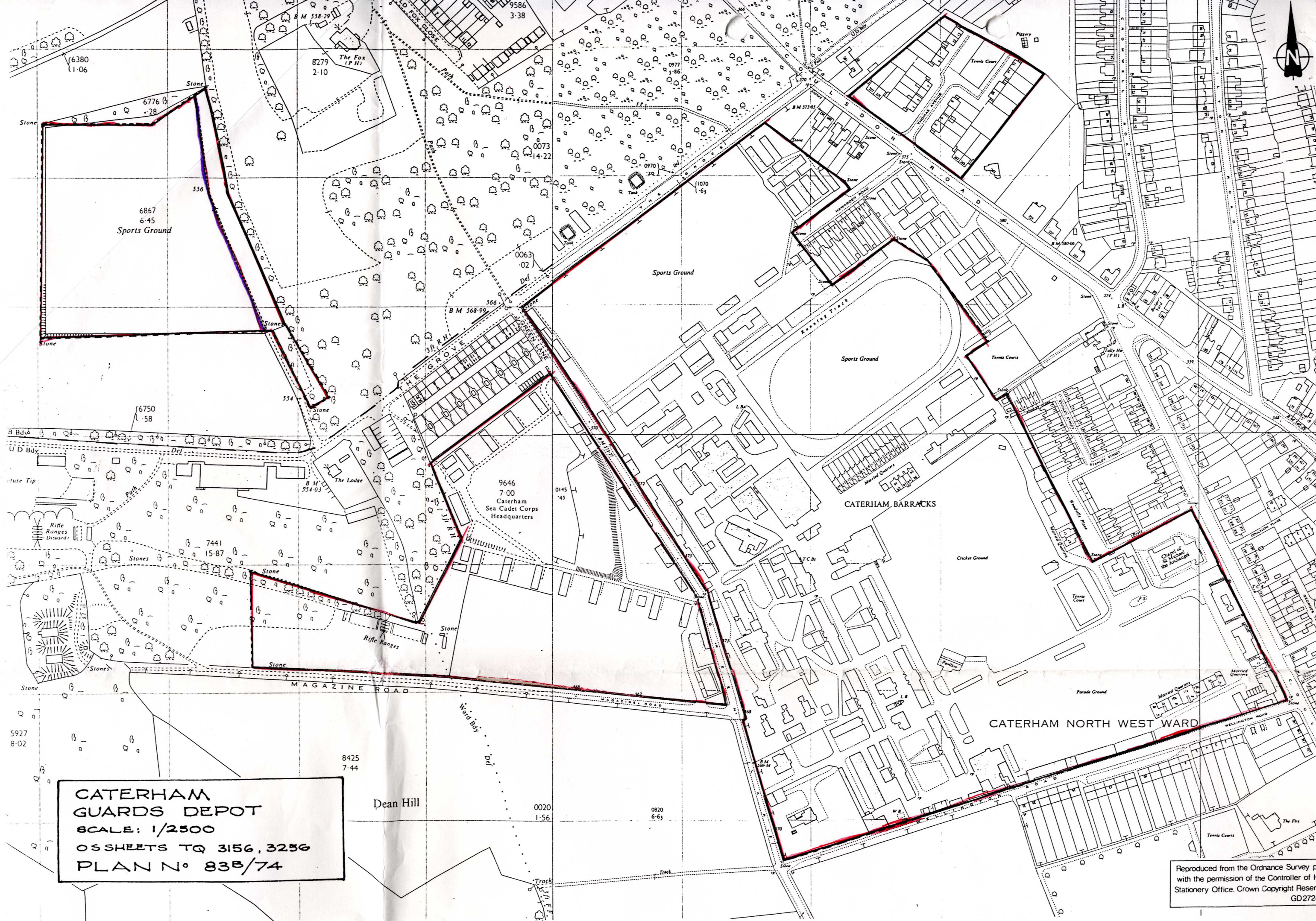

**CATERHAM
GUARDS DEPOT**
 SCALE: 1/2500
 OS SHEETS TQ 3156, 3256
 PLAN N° 83B/74

Reproduced from the Ordnance Survey map with the permission of the Controller of Her Majesty's Stationery Office. Crown Copyright Reserved. GD272

LEGEND

- a. Ministry of Defence boundaries are shown by red edging.
- b. Over each route shown by a continuous purple line, the Secretary of State recognizes a highway over which the public have a right of way on foot only.
- c. Over each route shown by a continuous green line, the Secretary of State recognizes that the public have the following, but no other, rights of way, that is to say, a right of way on foot and a right of way on horseback or leading a horse, with or without a right to drive animals of any description along the highway.
- d. Over each route shown by a broken green line, the Secretary of State recognizes the way to be a highway other than a footpath or bridleway used by the public mainly for the purposes for which footpaths and bridleways are so used, or as a byway open to all traffic.
- e. Over each route shown by a continuous brown tint the Secretary of State recognizes the route as a public road over which the public has the right to pass for all purposes with or without animals or vehicles.

HIGHWAYS ACT 1980 Section 31(6)

I, GEORGE SHEPHARD CORMACK, Defence Land Agent London, for and on behalf of the SECRETARY OF STATE FOR DEFENCE, and acting under the authority conferred upon me by the said Secretary of State DO SOLEMNLY AND SINCERELY DECLARE as follows:-

1. The Secretary of State for Defence on the 26th day of March 1974 and the 20th day of February 1978 in accordance with Section 34(6) of the Highways Act 1959 caused to be deposited with the Surrey County Council maps numbered 68/74 and 68A/74 of a certain Establishment vested in the Secretary of State within the area administered by such Council together with statements indicating that no ways over the land were admitted by the Secretary of State to have been dedicated as highways.
2. In accordance with Section 31(6) of the Highways Act 1980 no way over the land delineated on the maps so deposited with the Surrey County Council which is still vested in the Secretary of State as shown by red edging on the attached map numbered 68B/74 has been dedicated as a highway since 20th February 1978 being the date of a previous Declaration in accordance with the said section of the 1959 Act.

AND I MAKE this solemn declaration conscientiously believing the same to be true and by virtue of the Statutory Declarations Act 1835

DECLARED at
BRYAN O'CONNOR & CO.,
ST. MARGARETS HOUSE,
18/20 SOUTHWARK STREET,
LONDON BRIDGE, S.E.1.

.....
for and on behalf of
THE SECRETARY OF STATE FOR DEFENCE

this 23rd day of November 1990

Before me,

A-Commissi

F. J. F. O'MAHONY
A SOLICITOR
EMPOWERED TO
TAKE OATHS.



568

567

566

56500m

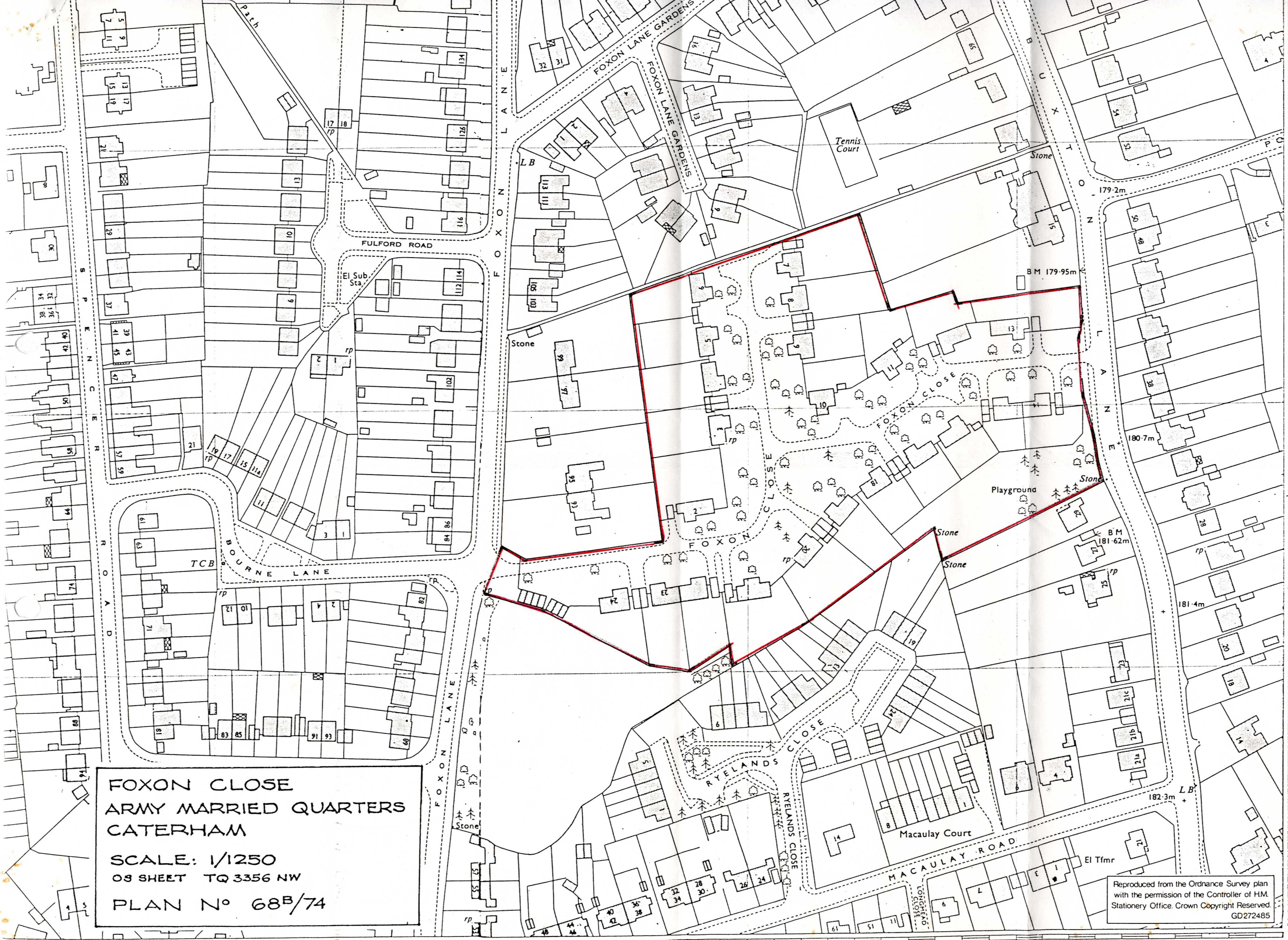

FOXON CLOSE
 ARMY MARRIED QUARTERS
 CATERHAM
 SCALE: 1/1250
 OS SHEET TQ 3356 NW
 PLAN N° 68B/74

Reproduced from the Ordnance Survey plan
 with the permission of the Controller of H.M.
 Stationery Office. Crown Copyright Reserved.
 GD272485

This is the map 688/74
referred to in the Interim
Statement of G.S. Council
near Lifford on the
23rd November 1990



F. J. F. O'MAHONY
A SOLICITOR
EMPOWERED TO
ADMINISTER OATHS.