

DEPOSIT OF STATEMENT and PLAN
SECTION 31 (6) OF THE HIGHWAYS ACT 1980

To: Surrey County Council

1. I am and have been since 7th September 1984 the owner jointly with others within the meaning of the above section of the land known as Penquite Farm, Wykehurst Lane, Ewhurst, Surrey more particularly delineated on the plan accompanying this statement and thereon edged red.
2. The aforementioned land lies in the Parish of Cranleigh.
3. The way coloured brown on the said plan has been dedicated as a footpath.
4. No other ways over the land have been dedicated as highways with vehicular status nor as bridleways nor as footpaths.
5. The deposit shall comprise this statement and accompanying plan.

Signed



Name Stanley Edwin Stonard

Address Penquite Farm, Wykehurst Lane, Ewhurst, Surrey GU6 7PF

Date 19th January 1998

Signed



Name

Address

Penquite Farm
Wykehurst Lane
Ewhurst
Surrey

Occupation

1 Q 0 7 4 0 - 0 8 4 0

Scale
1/2500

DISTRICT
WAVERLEY

© Crown copyright

NOTE: AREAS ON THIS PLAN ARE EXPRESSED
IN ACRES AND HECTARES.

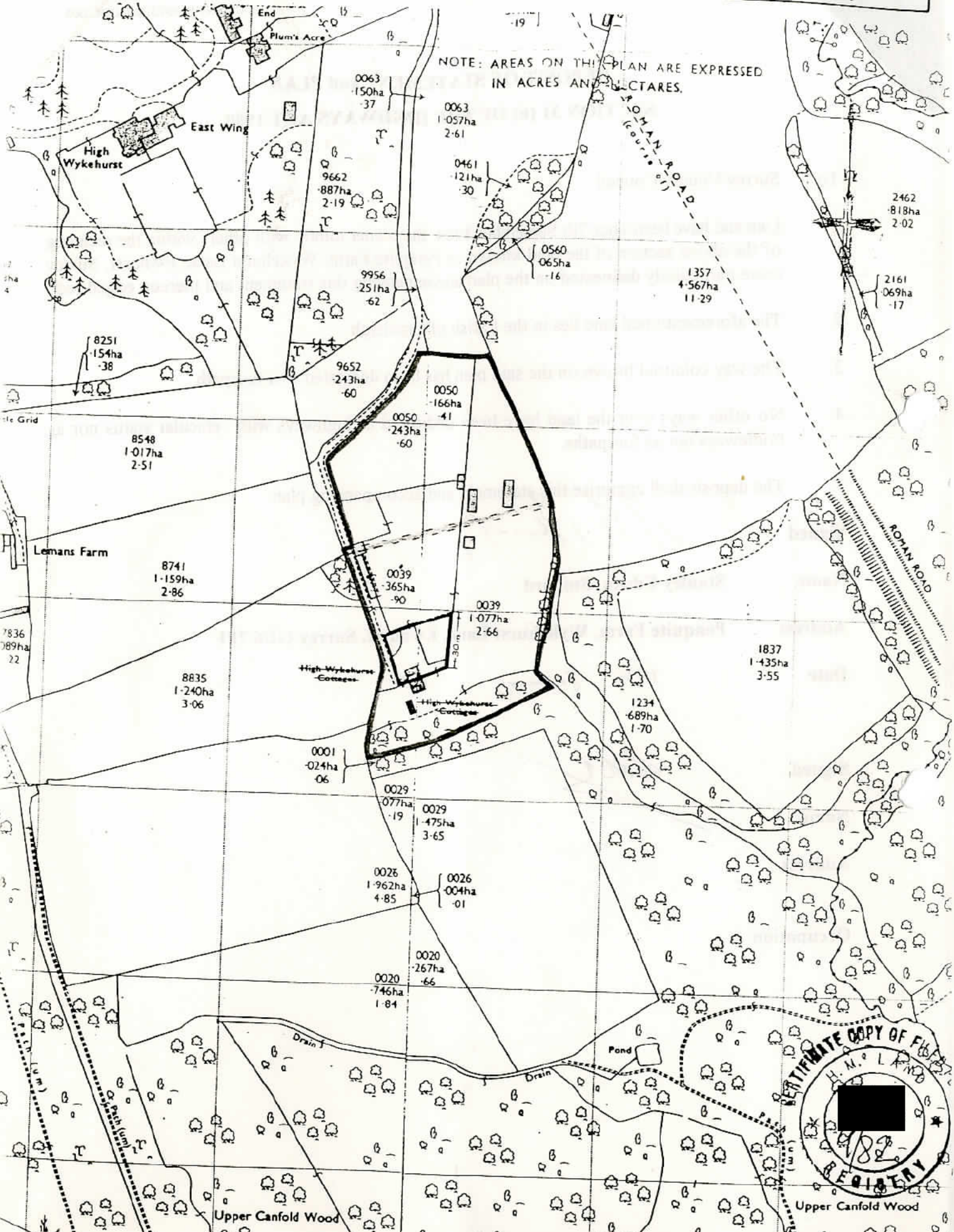

LEGITIMATE COPY OF FIELD
H. M. LAND
REGISTRY
1982

Upper Canfold Wood